

RETAIL FOR LEASE

THE POINT

300 North & 2000 West (NWC) | West Point, Utah 84015



300 NORTH 6,100 ADT

2000 WEST 25,000 ADT

Property Highlights

- 1,800 SF with Drive-Thru
- \$50 PSF / NNNs-\$6.50 PSF
- High Residential Growth
- \$135,004 Avg. Household Income in Trade Area
- Near Syracuse High School (1,900+ Students)



NEW MULTI-TENANT BUILDINGS
DELIVERY SPRING 2026

TANNER OLSON
801.930.6752

tolson@legendcommercial.com

JOE MILLS
801.930.6755

jmills@legendcommercial.com

801.930.6750
www.legendcommercial.com

2180 S 1300 E, Suite 240 | Salt Lake City, UT 84106

PARTNER **XTEAM**
RETAIL ADVISORS



THE POINT

300 North & 2000 West (NWC) | West Point, Utah 84015

DEMOGRAPHICS

	1 MILE	3 MILE	5 MILE
2025 POPULATION	10,018	95,797	185,528
2030 PROJECTED POPULATION	10,169	102,185	195,159
2025 HOUSEHOLDS	3,107	29,757	60,080
2025 AVG HH INCOME	\$126,236	\$135,004	\$124,726
2025 BUSINESSES	112	1,546	3,584
2025 DAYTIME POPULATION	623	16,292	35,740



TANNER OLSON

801.930.6752

tolson@legendcommercial.com

JOE MILLS

801.930.6755

jmills@legendcommercial.com

801.930.6750
www.legendcommercial.com
2180 S 1300 E, Suite 240 | Salt Lake City, UT 84106

PARTNER XTEAM
RETAIL ADVISORS



THE POINT

300 North & 2000 West (NWC) | West Point, Utah 84015

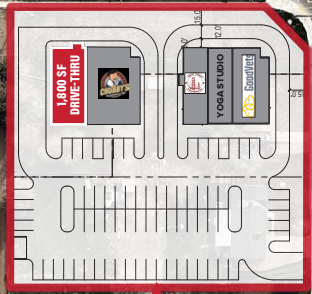

SITE

300 N 6,100 ADT

2000 W 25,000 ADT

2000 W



COMING SOON
DESERT FIRST
CREDIT UNION

Cafe Rio

REJUUV DAY SPA & BEAUTY HAVEN

TWISTED SUGAR

Great Clips

marco's

DEL TACO

HEALTHCARE

Smith's
FUEL STATION

Nail Salon

WELLS FARGO

Baya Bar

Smith's
FOOD & DRUG STORES

THE POINT
108 UNITS

N

TANNER OLSON

801.930.6752

tolson@legendcommercial.com

JOE MILLS

801.930.6755

jmills@legendcommercial.com

801.930.6750
www.legendcommercial.com

2180 S 1300 E, Suite 240 | Salt Lake City, UT 84106

PARTNER XTEAM
RETAIL ADVISORS



THE POINT

300 North & 2000 West (NWC) | West Point, Utah 84015

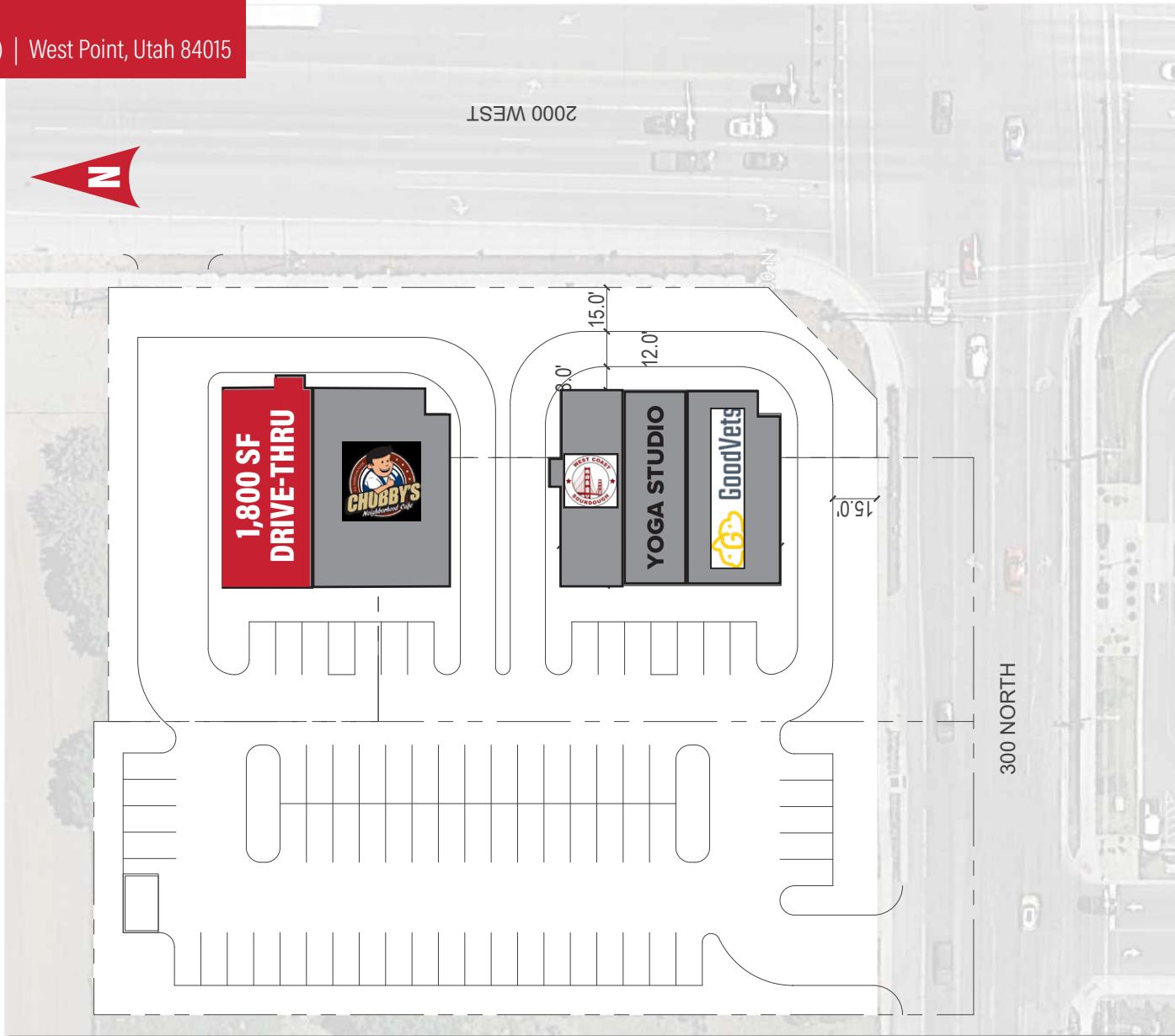

TANNER OLSON

801.930.6752

tolson@legendcommercial.com

JOE MILLS

801.930.6755

jmills@legendcommercial.com

801.930.6750
www.legendcommercial.com
2180 S 1300 E, Suite 240 | Salt Lake City, UT 84106

PARTNER **XTEAM**
RETAIL ADVISORS

