

LEASE

STARR'S MILL MEDICAL OFFICE

Wilshire Village Drive Peachtree City, GA 30269



PROPERTY DESCRIPTION

Proposed Construction - estimated availability Nov 2024
2 Suites available (approx 3k sf each)
Medical or dental focus

PROPERTY HIGHLIGHTS

- New construction - ECD late 2023 - early 2024
- Sought-after area with several new developments

OFFERING SUMMARY

Lease Rate:	\$24.00 SF/yr (NNN)
Number of Units:	3
Available SF:	3,000 - 6,000 SF
Lot Size:	1.95 Acres
Building Size:	14,724 SF
Zoning:	GC
APN:	0609 025

DEMOGRAPHICS	1 MILE	2 MILES	3 MILES
Total Households	834	3,697	7,254
Total Population	2,205	10,035	19,437
Average HH Income	\$133,527	\$134,054	\$130,870

Tom Fulton
770 632 1774



**COLDWELL BANKER
COMMERCIAL**
BULLARD

LEASE

STARR'S MILL MEDICAL OFFICE

Wilshire Village Drive Peachtree City, GA 30269

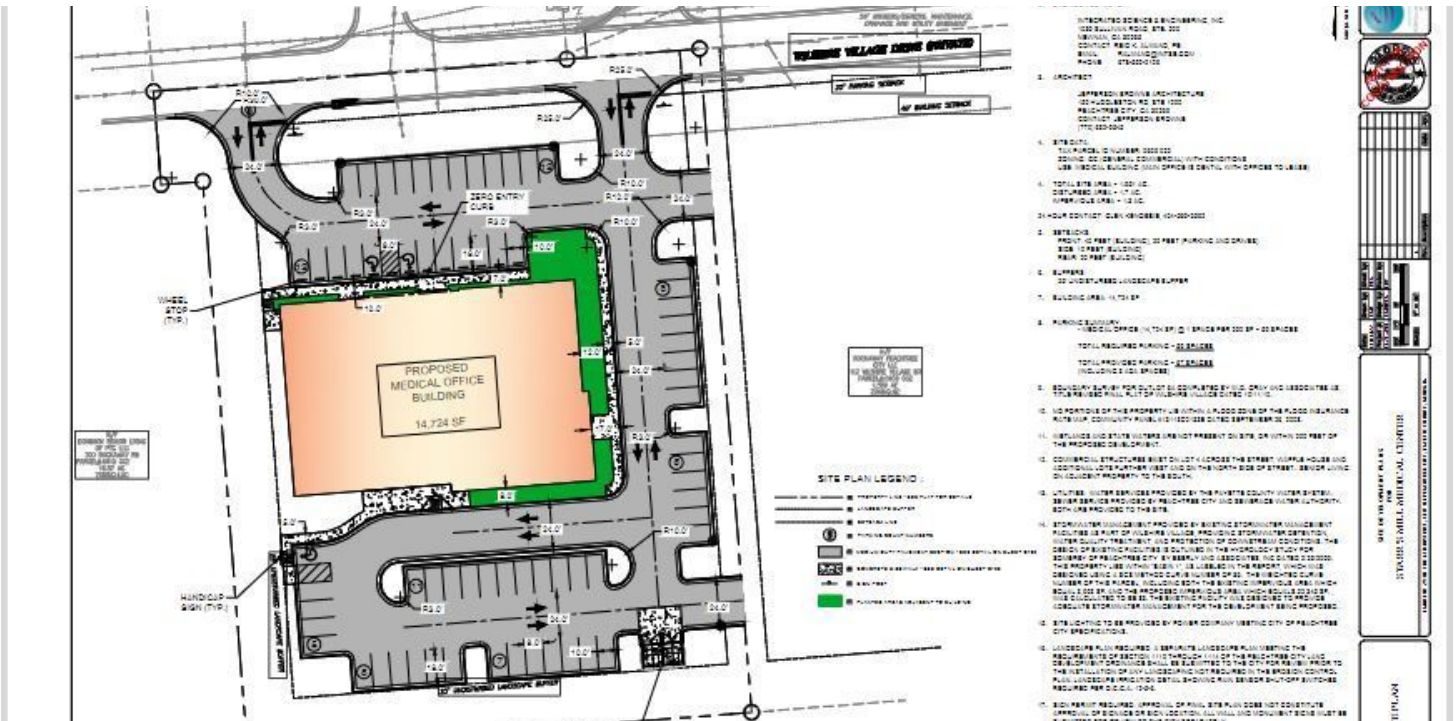

Tom Fulton
770 632 1774



**COLDWELL BANKER
COMMERCIAL**
BULLARD

LEASE

STARR'S MILL MEDICAL OFFICE

Wilshire Village Drive Peachtree City, GA 30269



Tom Fulton
770 632 1774



COLDWELL BANKER
COMMERCIAL
BULLARD

LEASE

STARR'S MILL MEDICAL OFFICE

Wilshire Village Drive Peachtree City, GA 30269

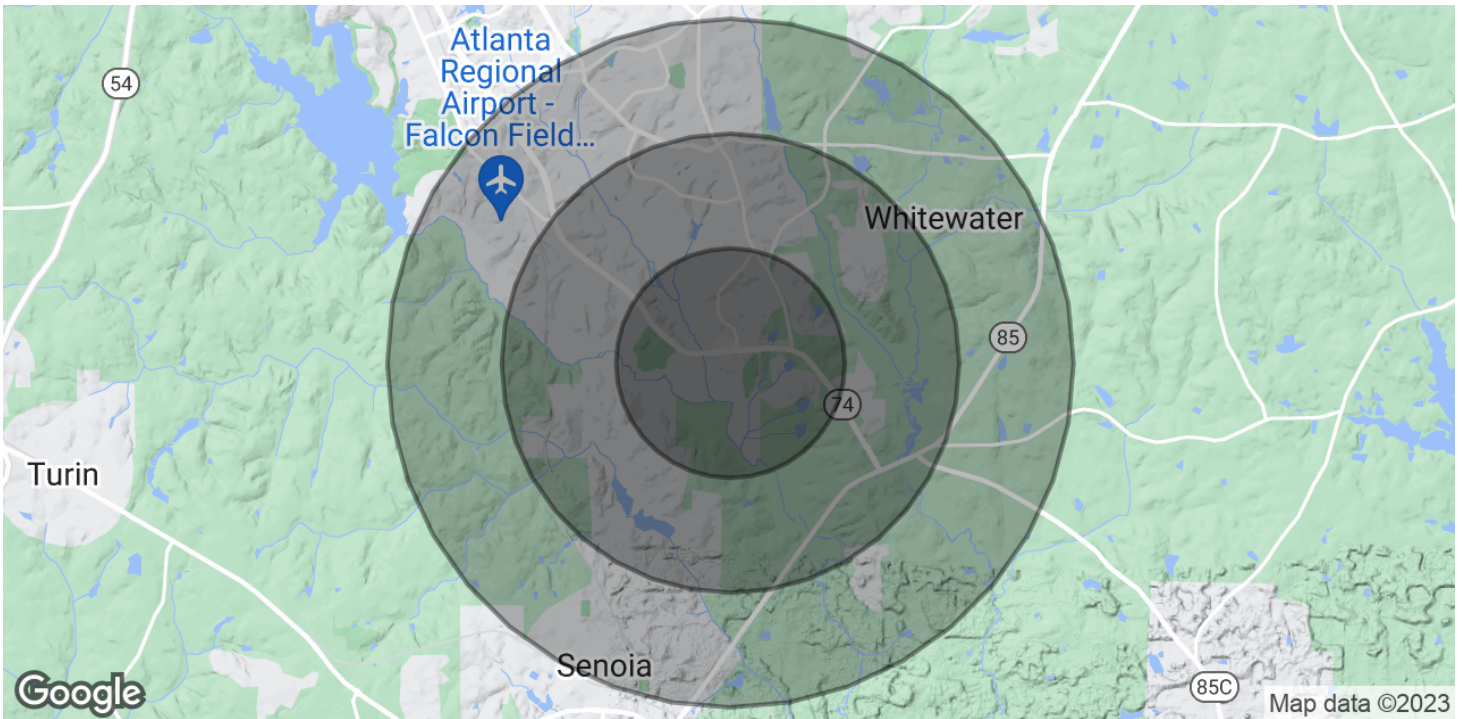

POPULATION	1 MILE	2 MILES	3 MILES
Total Population	2,205	10,035	19,437
Average Age	44.8	43.5	43.2
Average Age (Male)	43.4	42.4	41.6
Average Age (Female)	46.9	45.1	44.7

HOUSEHOLDS & INCOME	1 MILE	2 MILES	3 MILES
Total Households	834	3,697	7,254
# of Persons per HH	2.6	2.7	2.7
Average HH Income	\$133,527	\$134,054	\$130,870
Average House Value	\$387,987	\$356,302	\$346,252

* Demographic data derived from 2020 ACS - US Census

Tom Fulton
770 632 1774



COLDWELL BANKER
COMMERCIAL
BULLARD