

SALE

LAND



3000 N. GERMAN CHURCH RD.



3000 N. GERMAN CHURCH RD., INDIANAPOLIS, IN 46235

PROPERTY HIGHLIGHTS

- ± 9.8 acre development land zoned C-3
- Ideally suited for multi-family or senior care uses
- 54,152 households within 5 miles
- Near rapidly growing Mt. Comfort corridor
- Quick access to I-70 and I-465
- In a Qualified Census Tract

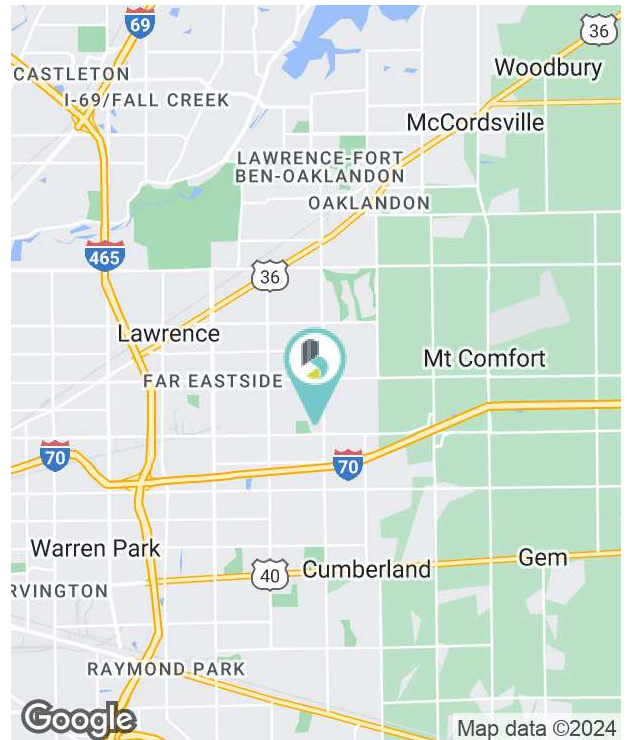

SALE PRICE **\$898,000**

Lot Size: ± 9.8 Acres



BRADLEY COMPANY
310 E. 96th St., Suite 100
Indianapolis, IN 46240
317.663.6000

MICHAEL HARRIGAN, SIOR
Senior Vice President | Director of Land Services
317.439.3452
mhorrigan@bradleyco.com

SAM KAROZOS
Vice President
317.371.0128
skarozos@bradleyco.com



BRADLEYCO.COM



PRELIMINARY LAYOUT EXHIBIT

3000 N. GERMAN CHURCH RD., INDIANAPOLIS, IN 46235

SALE

LAND

PRELIMINARY LAYOUT EXHIBIT '2'
30th STREET & GERMAN CHURCH ROAD

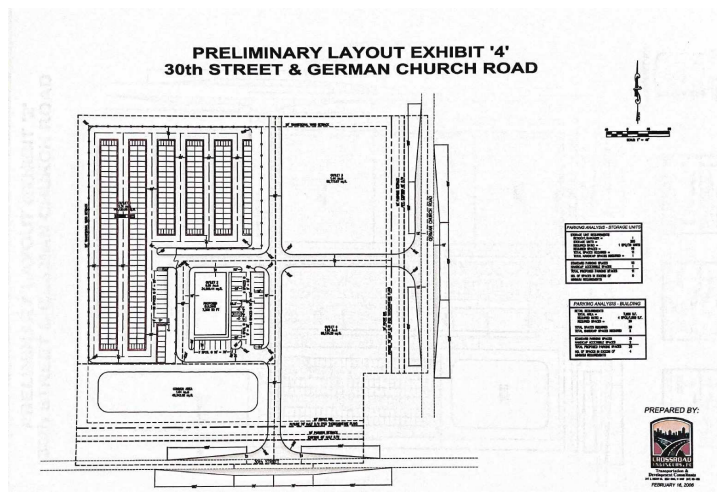
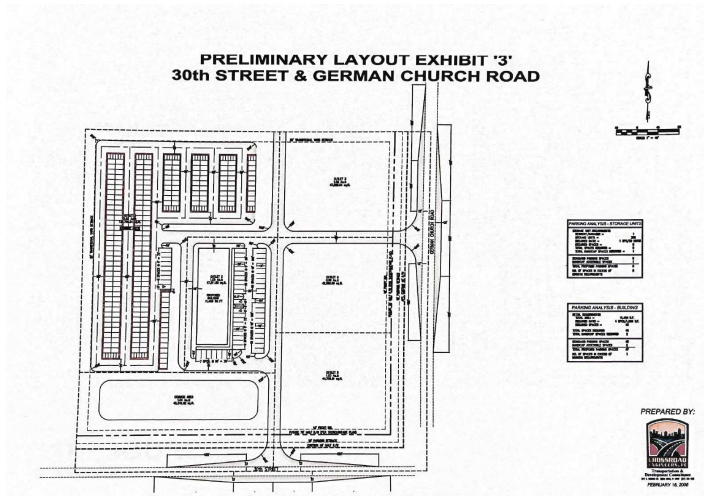
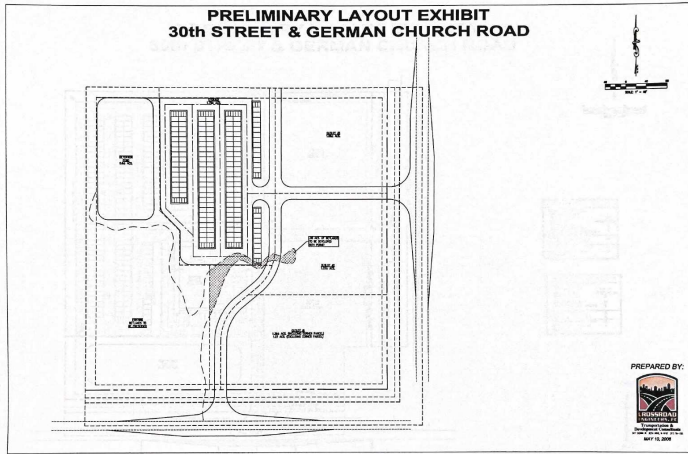
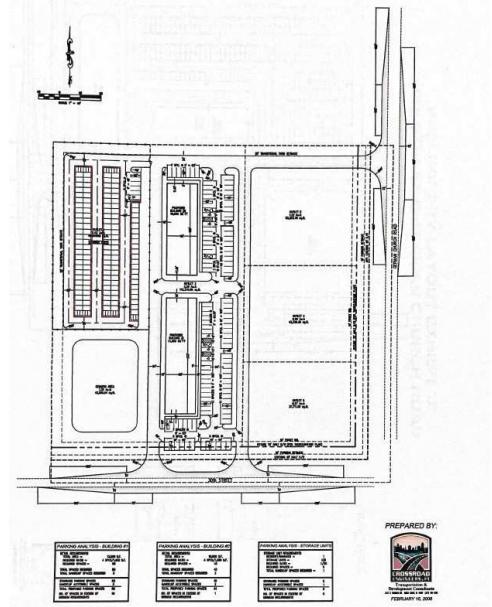

MICHAEL HORRIGAN, SIOR
Senior Vice President | Director of Land Services
317.439.3452
mhorrigan@bradleyco.com

SAM KAROZOS
Vice President
317.371.0128
skarozos@bradleyco.com