

Office ▪ Warehouse
▪ Paved Yard

FOR SALE



1000
E 21st Street
Bakersfield, CA

The information contained herein may have been obtained from sources other than ASU Commercial. We have not verified such information and make no guarantees, warranties or representations about such information. It is your responsibility to independently confirm its accuracy and completeness prior to purchasing/leasing the property.



Wesley M. McDonald ▪ Principal ▪ 661 885 6950 ▪ wesley.mcdonald@asuassociates.com ▪ CA RE #01511739
John A. Ritchie ▪ Senior Vice President ▪ 661 616 3583 direct ▪ jritchie@asuassociates.com ▪ CA RE #00900552
11601 Bolthouse Drive Suite 110 ▪ Bakersfield, CA 93311 ▪ 661 862 5454 main ▪ 661 862 5444 fax

Office ▪ Warehouse ▪ Paved Yard For Sale

Property Information

1000 E 21st Street - Bakersfield, CA

Property Detail

- **Total Available Space** 5,000 SF
- **Warehouse Space** 3,600 SF
- **Office Space** 1,400 SF
- **Yard Size** 0.34 Acres
- **Zoning** M-2, Medium Manufacturing
- **Clear Height** 14' - 16'
- **Ground Level Doors** Four (4) 12' x 12'
- **Construction Type** Prefabricated Metal

Property Highlights

- Easy Northbound and Southbound access to Freeway 99, Highway 58, and the Westside Parkway
- One (1) point of ingress/egress to asphalt paved yard wrought-iron rolling gate entrance into the yard
- CMU block wall surrounding the entire yard area
- Located in the vastly expanding and increasingly desirable "Downtown" submarket

Utilities



Sale Price

\$450,000.00



Office ■ Warehouse ■ Paved Yard For Sale

Floor Plan

1000 E 21st Street - Bakersfield, CA

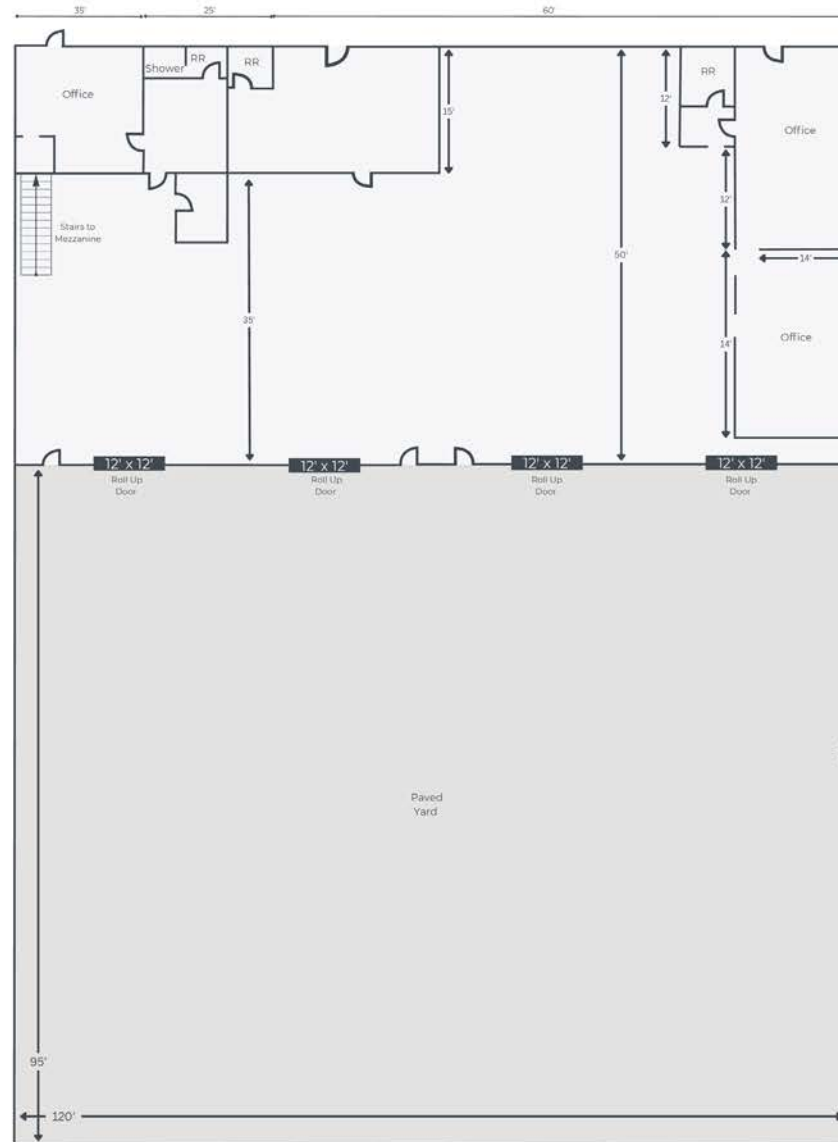

Office ■ Warehouse ■ Paved Yard For Sale

Aerial Location Map

1000 E 21st Street - Bakersfield, CA

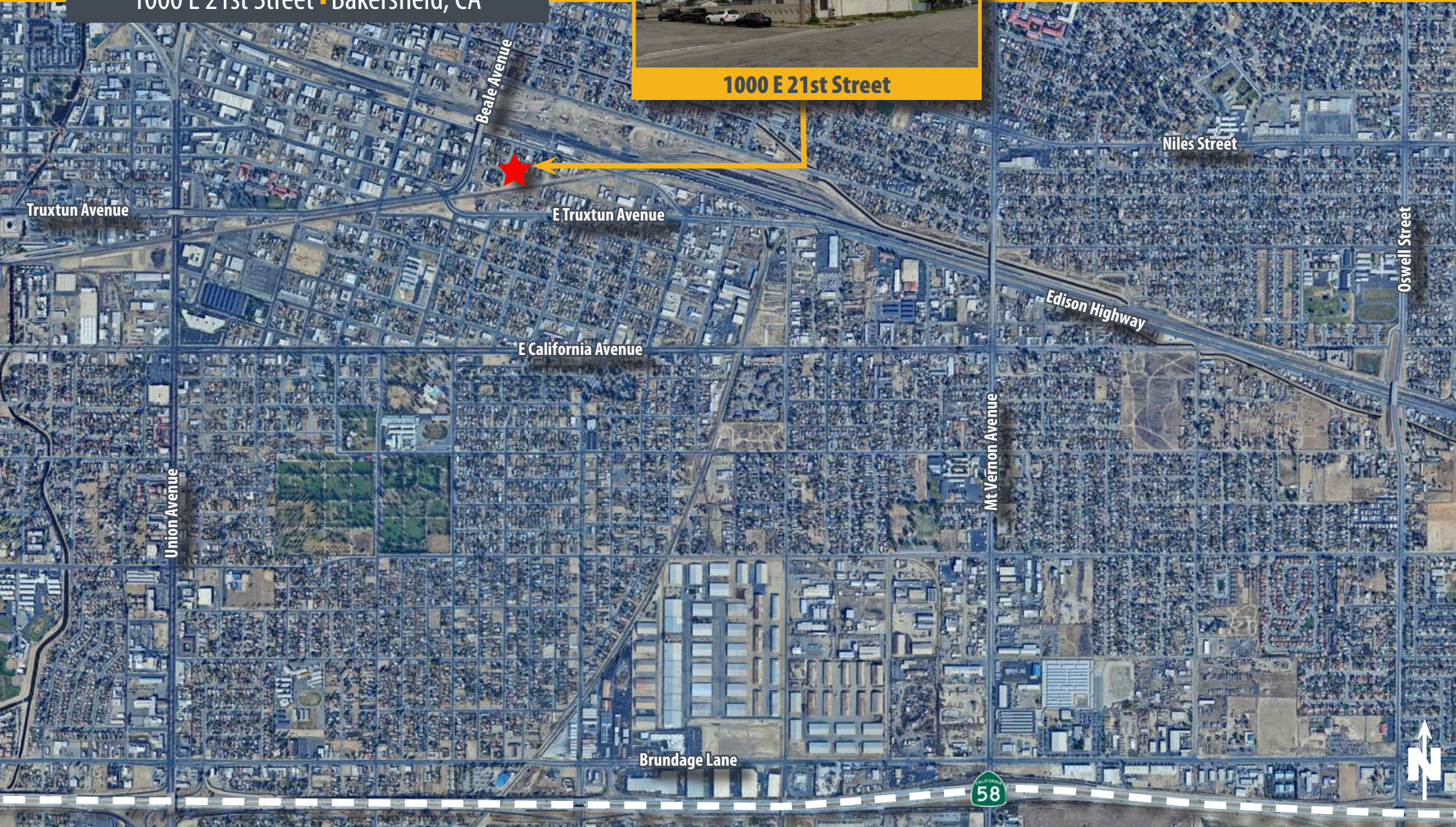

Wesley M. McDonald ■ Principal ■ 661 885 6950 ■ wesley.mcdonald@asuassociates.com ■ CA RE #01511739
John A. Ritchie ■ Senior Vice President ■ 661 616 3583 direct ■ jritchie@asuassociates.com ■ CA RE #00900552
11601 Bolthouse Drive Suite 110 ■ Bakersfield, CA 93311 ■ 661 862 5454 main ■ 661 862 5444 fax