

Carson Land Everett

2233 106th St. SW
Everett, WA 98204

Industrial Land



Property Overview

2.29 Acres of Industrial Land Suitable for Manufacturing, Machine Shop, Warehouse Distribution, Offices, Self Storage, Cabinet Shop, Medical Clinic or Lab. Plans for 27,625 sq.ft. Industrial Building available. Rental house on property. Very close to Boeing and Highway 5.

Property Details

1. 2.29 Acres Zoned Everett M-M
2. Wetlands study done.
3. Water, Sewer, Power in Street.
4. Available for \$975,000

Contact Information

Michael Fear
Coldwell Banker Bain Commercial
michaelfear@cbbain.com
206-755-8856

PROPOSED WAREHOUSE/INDUSTRIAL BUILDING

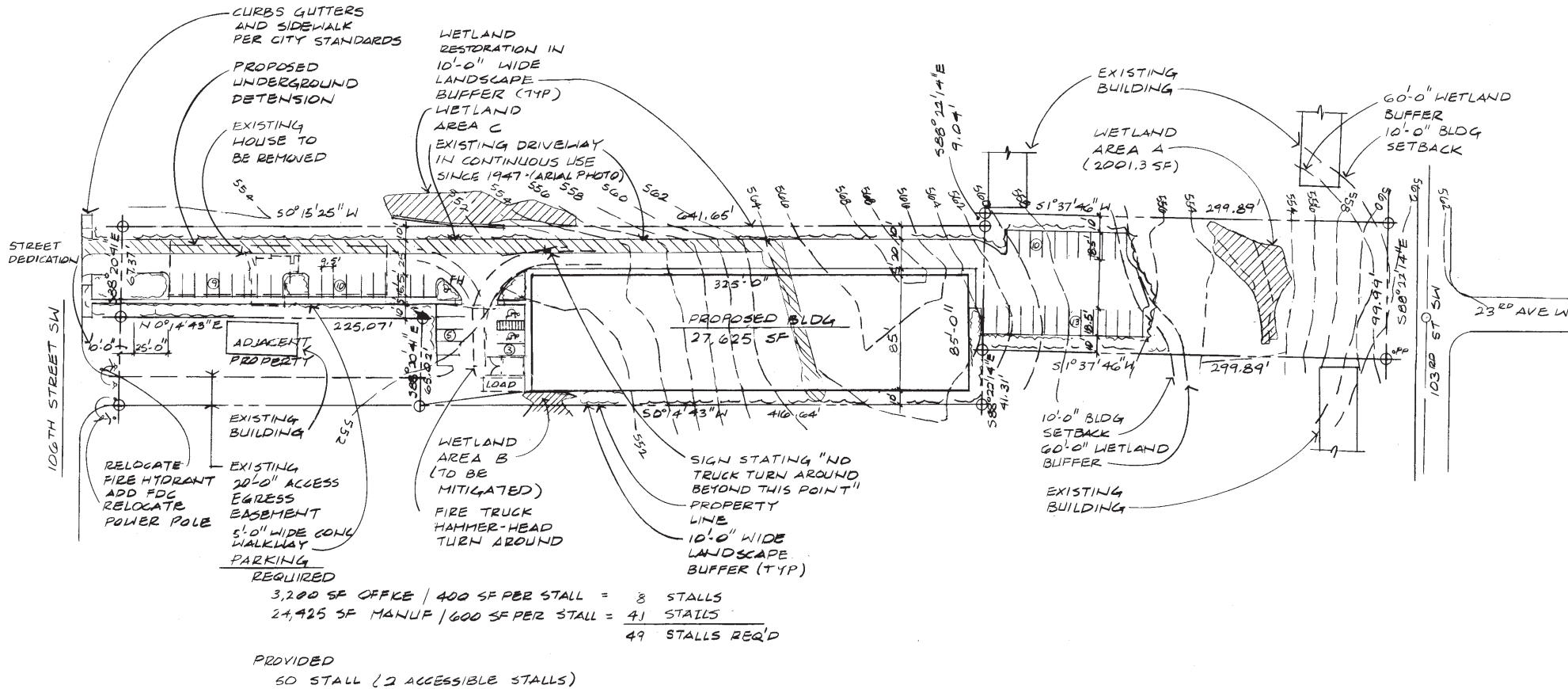

REQUIRED
 3,200 SF OFFICE / 400 SF PER STALL = 8 STALLS
 24,425 SF MANUF / 600 SF PER STALL = 41 STALLS
49 STALLS REQ'D

PROVIDED
 50 STALL (2 ACCESSIBLE STALLS)

ZONING: MM
PROPOSED USE: LEASABLE LIGHT INDUSTRIAL
PROPOSED CONSTRUCTION TYPE: III-B

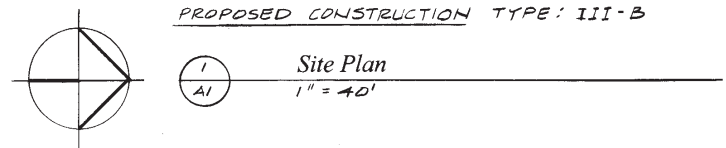

Robert Opheim, Architect
 666 Gladstone Drive
 Camano Island, Washington 98282
 (360) 572-4905

Issued:
 Revised:

Site Plan

Tax Parcel Numbers:

Vacant Lot 19: 00538200001300
 Lot 13 (2233 106th St SW): 00535400001900

Legal Descriptions:

Parcel Number 00538200001900:
 TRACT 19, PLAT OF PAINE FIELD NO. 5, AS PER PLAT RECORDED IN VOLUME 14 OF PLATS, PAGE 85, RECORDS OF SNOHOMISH COUNTY, WASHINGTON.

Parcel Number 00535400001300:
 Parcel A:
 LOT 13, PLAT OF OLIVIA PARK, DIVISION NO. 3, AS PER PLAT RECORDED IN VOLUME 11 OF PLATS, PAGE 17, RECORDS OF SNOHOMISH COUNTY, EXCEPT THAT EAST 65 FEET OF THE SOUTH 225 FEET THEREOF.

Parcel B:
 A NON-EXCLUSIVE EASEMENT FOR INGRESS AND EGRESS OVER, UNDER, THROUGH AND ACROSS THE EAST 20 FEET OF THE EAST 65 FEET OF THE SOUTH 225 FEET OF SAID LOT 13, SITUATE IN THE CITY OF EVERETT, COUNTY OF SNOHOMISH, STATE OF WASHINGTON

Property Owner:

Mr. Mike Carson
 13806 Highway 99
 Lynnwood, WA 98087
 (425) 697-6969
 Cell (206) 697-3848

Site Address:

2233 106th Street SW, Everett, Washington 98204

A Proposed Industrial Building for:
Mr. Mike Carson
 2233 106th Street SW
 Everett, Washington

A1

Information herein is from sources deemed reliable, but is provided without representation, warranty or guarantee, expressed or implied. Prospective Buyers or Tenants should conduct an independent investigation and verify all matters concerning any information herein, attached to or associated with this document. You are strongly advised to consult your attorney, accountant, or other professional advisor.



Information herein is from sources deemed reliable, but is provided without representation, warranty or guarantee, expressed or implied. Prospective Buyers or Tenants should conduct an independent investigation and verify all matters concerning any information herein, attached to or associated with this document. You are strongly advised to consult your attorney, accountant, or other professional advisor.