

19 GARFIELD PLACE

CENTRAL
BUSINESS DISTRICT

OFFICE SPACE
AVAILABLE
FOR LEASE



Pending for illustration purposes

CHRIS PFEIFFER
REALTOR® | ARCHITECT
(513) 374-6494
cpfeiffer@comey.com

the
PFEIFFER
group
selling by design

**Comey &
Shepherd**
REALTORS®



THE HISTORIC DOCTOR'S BUILDING at 19 Garfield Place is situated on Piatt Park and is one of Cincinnati's best examples of late Gothic Revival architecture for a commercial building in the Central Business District. The Doctor's Building is listed on the National Register of Historic Places and was designed by Tietig and Lee and originally constructed in 1923 as commercial office space for local physicians. Recently, the building served as the global, regional and local headquarters for multiple companies, including brand strategy consultants LPK.



OFFICE

3 SPACES AVAILABLE

950 SQ FT - 4,615 SQ FT

\$18/SQ FT/YEAR

\$1.50/SQFT/MONTH

- \$18.00/SF modified gross
- Tenant responsible for cleaning, interior maintenance, pro-rata share of electric
- 3-yr min. lease term
- T/I possible, but not included in base rent
- Controlled entry lobby
- Freight elevator
- Interior directory/signage
- Piatt Park setting
- Historic architecture & prominent location
- Two blocks from Cincinnati Streetcar Connector
- Abundant parking available nearby

LEASING TERMS





Available
For Lease

Common
Space

Leased
Space

Suite 15
3,925 SQ FT
(Floor 1)
Immediate Occupancy

Suite 9
3,000 FT
(Floor 1 & Basement)
Immediate Occupancy

FIRST FLOOR PLAN

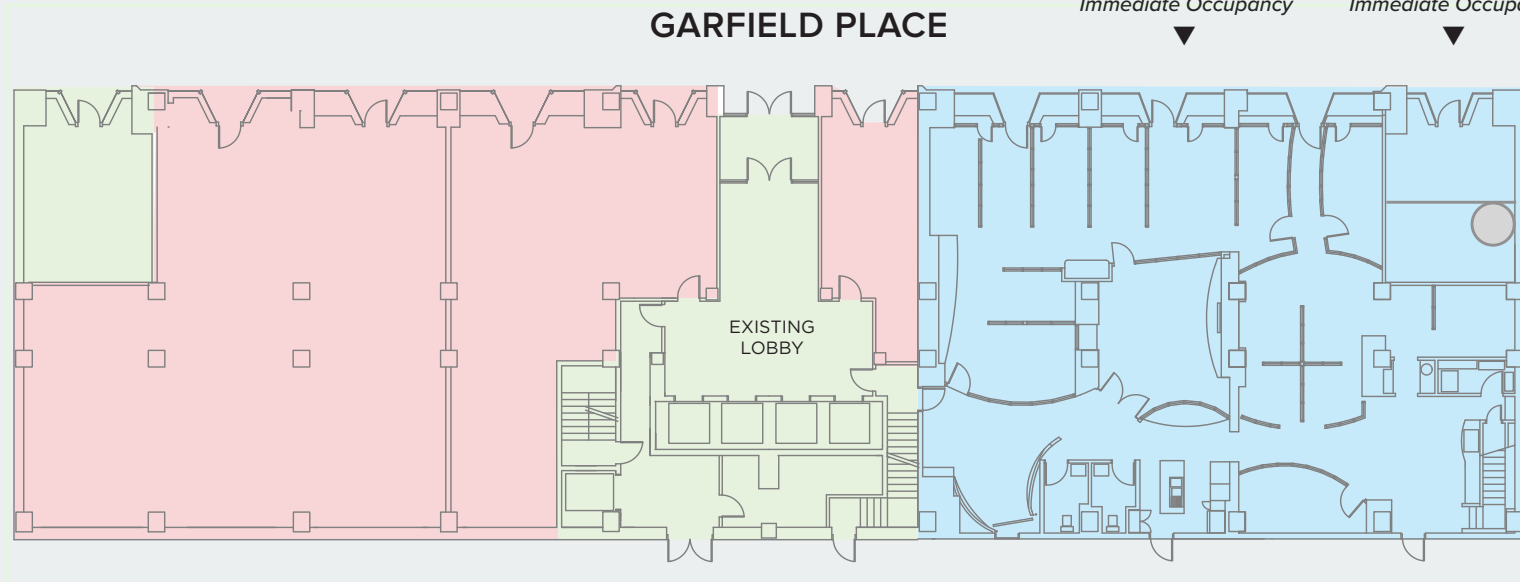

Suite 2 West
4,615 SQ FT
Immediate Occupancy
(Construction coordination required)

Suite 215
1,758 SQ FT
Jan 2026 Occupancy

Suite 211
950 SQ FT
Immediate Occupancy

SECOND FLOOR PLAN

