

**4511 HOPSON ROAD,
MORRISVILLE NC 27560**

TRIANGLE 
COMMERCIAL REAL ESTATE



4511 Hopson Road is positioned on a heavy-traffic stretch of Hopson Road with strong frontage and accessibility—well-suited for a small office conversion, boutique service/retail concept, or investment hold.

The adjacent parcel at 4503 Hopson Road is also for sale and can be acquired as a companion purchase for buyers looking to expand the footprint or control the full assemblage.

List price:: \$575,000

For More Information Contact:
Luke Beaver
919-724-6423
luke@TriangleCRE.com

[VIEW LISTING](#)

TriangleCRE.com

PROPERTY HIGHLIGHTS

4511 Hopson Road,
Morrisville NC 27560



- **Each parcel approx. 0.67 acres (about 1.4 acres total if assembled with the adjacent lot).**
- **Zoned CSD-S1 (Compact Suburban Design-Support 1 supports a range of mixed-use/commercial redevelopment concepts (buyer to verify permitted uses/approvals)).**
- **High-visibility Hopson Rd frontage with strong commuter/local traffic – ideal for conversion-style concepts that benefit from exposure.**
- **Minutes to major Triangle employment nodes and regional corridors.**

Buyer options (verify with UDO/planning):

- **Office / professional conversion (single-parcel play)**
- **Optional assemblage (adjacent parcel also for sale) for a larger footprint**
- **Land-banking with interim cash-flow approach**

4511 Hopson Road,
Morrisville NC 27560

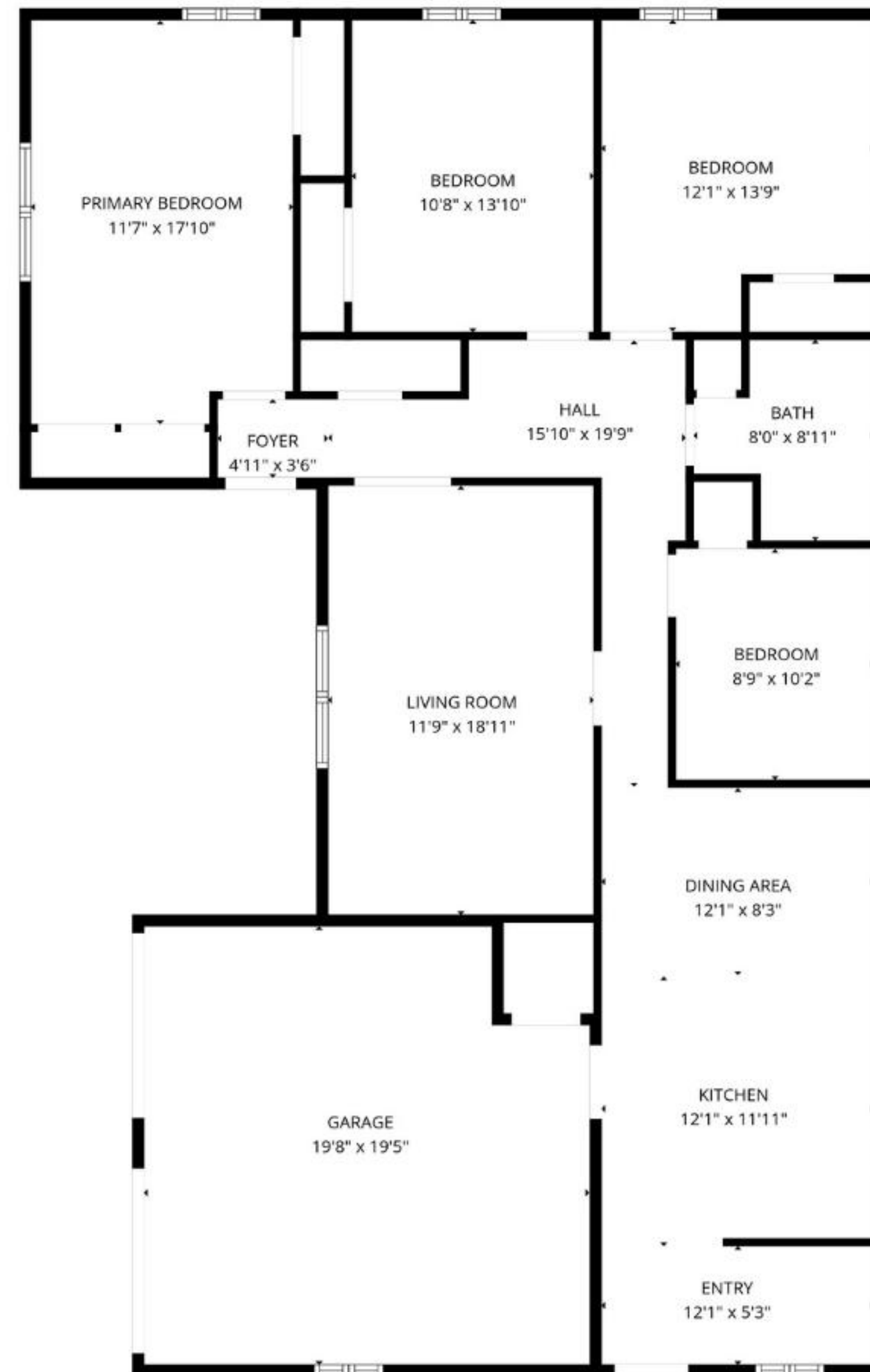

FLOOR PLAN CREATED BY CUBICASA APP. MEASUREMENTS DEEMED HIGHLY RELIABLE BUT NOT GUARANTEED.

All measurements must be verified by buyer

LOCATION

4511 Hopson Road, Morrisville
NC 27560

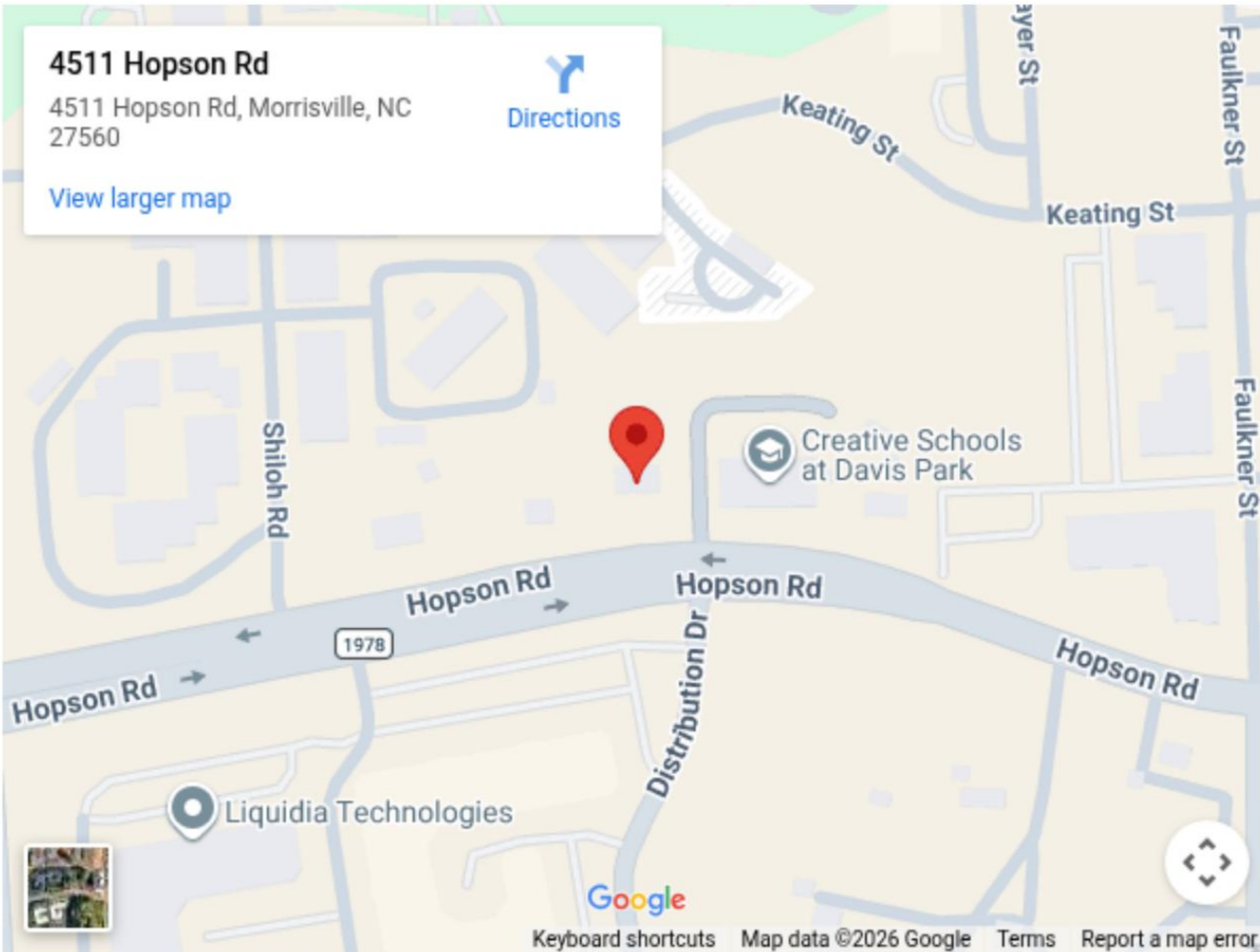

NEARBY:

- **IBM**
- **Cisco**
- **Lenovo**
- **Apple's future campus**
- **RDU**
- **UNC Chapel Hill**
- **Duke University**
- **Wolfspeed**
- **Frontier**

In the center of RTP!



TriangleCRE.com

**4511 HOPSON ROAD,
MORRISVILLE NC 27560**

TRIANGLE
COMMERCIAL REAL ESTATE

For More Information Contact:

Luke Beaver

919-724-6423

Luke@trianglecre.com

APPROVED USES:

- Medical office / clinic / outpatient health services – Church / place of worship**
- Retail sales & service (general) – Schools / education–related uses**
- Professional offices**
- Restaurants / food service**
- Community / civic uses**
- Personal services**
- Parks / open space related civic uses**
- Financial services**
- Nonprofit / social–service type uses**
- Small commercial service uses consistent with the Use Table**
- Other institutional uses specifically listed as allowed in the Use Table**

Disclaimer:

Buyer is responsible to verify with the cities UDO