

# GORDMANS BUILDING

5100 14<sup>TH</sup> AVE S, FARGO, ND

  
**GOLDMARK**<sup>™</sup>  
COMMERCIAL REAL ESTATE INC

**FOR LEASE**



**CONVENIENT LOCATION FOR RETAIL OR OTHER USE**

Space Available: 35,237 SF

Rent: \$12.00 PSF

CAM: \$3.50 PSF

Tenant Expenses: Heat, Electricity, Water/Sewer/Garbage

**Patrick Vesey** | 701.239.5840

[patrick.vesey@goldmark.com](mailto:patrick.vesey@goldmark.com)

**Goldmark Commercial Real Estate**

[www.goldmarkcommercial.com](http://www.goldmarkcommercial.com)

# GORDMANS BUILDING

5100 14<sup>TH</sup> AVE S, FARGO, ND



## SPACE AVAILABLE

35,237 SF

## RENT

\$12.00 PSF

## CAM

\$3.50 PSF

## TENANT EXPENSES

Heat  
Electricity  
Water/Sewer/Garbage

## NEIGHBORS

Walmart  
Sams Club  
Scheels  
Marshalls/Home Goods  
Menards

## PROPERTY DESCRIPTION:

Retail, office or warehouse space in a great location just off 13th Ave. S, Fargo. Loading dock and plenty of parking.

This information has been secured from sources we believe to be reliable, but we make no representation or warranties, expressed or implied, as to the accuracy of the information. Interested parties should conduct their own independent investigations and rely only on those results.

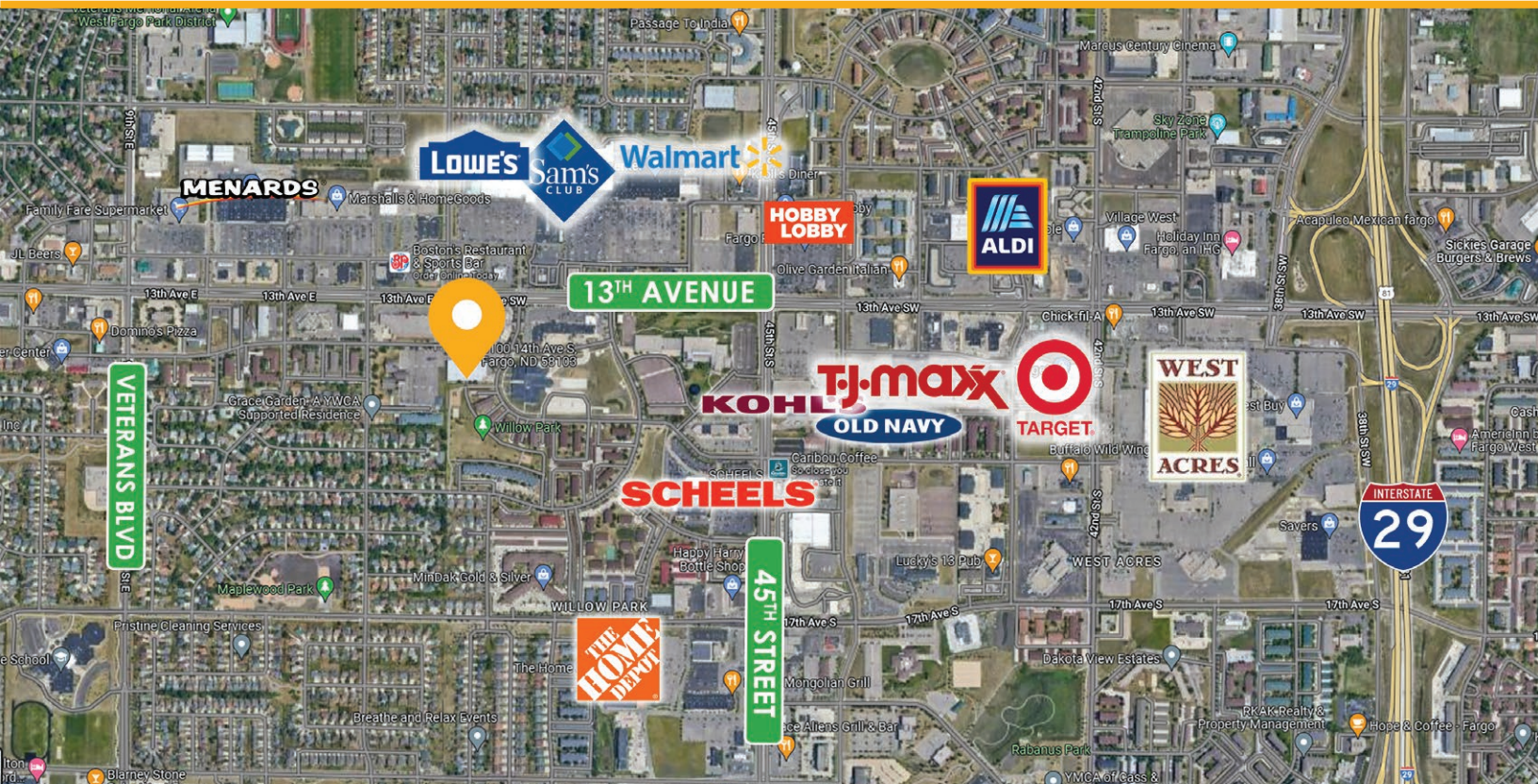

# GORDMANS BUILDING

5100 14<sup>TH</sup> AVE S, FARGO, ND

**GOLDMARK**<sup>™</sup>  
COMMERCIAL REAL ESTATE INC

FLOORPLAN

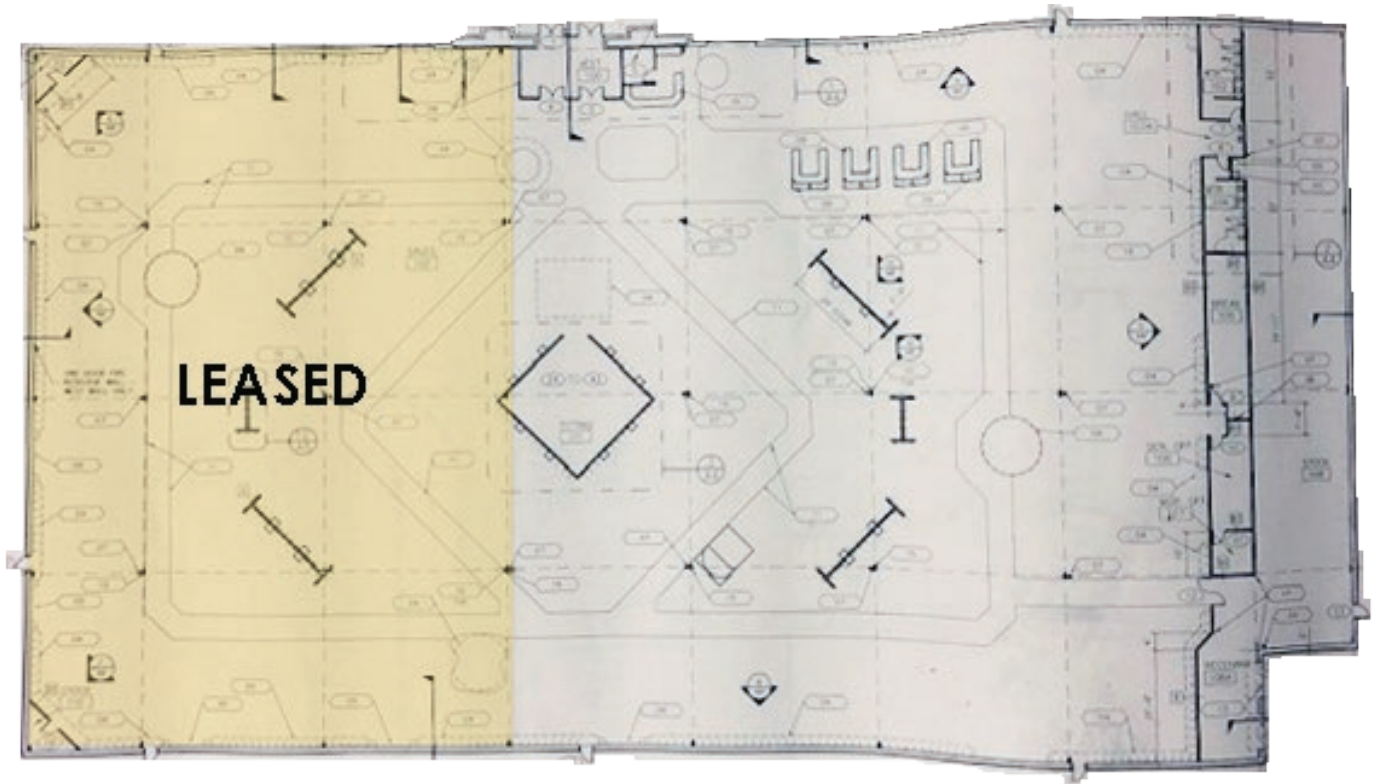

# GORDMANS BUILDING

5100 14<sup>TH</sup> AVE S, FARGO, ND

**GOLDMARK**<sup>™</sup>  
COMMERCIAL REAL ESTATE INC

INTERIOR PHOTOS

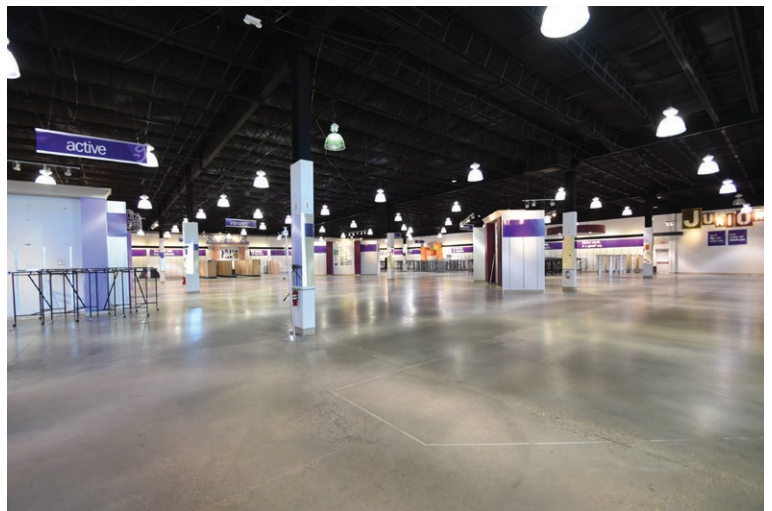

# GORDMANS BUILDING

5100 14<sup>TH</sup> AVE S, FARGO, ND

SITE PLAN

