

For Sale



OFFICE/MANUFACTURING/TECH

Freestanding Building For Sale in Santa Clara, Fully Sprinklered with Heavy Power

550 NUTTMAN STREET, SANTA CLARA, CA

±8,000 SF
BLDG. SIZE

20/80
OFFICE/MFG. RATIO

±27,750 SF
LOT SIZE

3/1,000
PARKING RATIO, WITH FENCED YARD



Property Attributes

20% HVAC office, 80% manufacturing/warehouse

Significantly seismically upgraded

1 oversized grade level door (14'w x 12'h)

3/1,000 parking ratio, with fenced yard

600 amps at 480 volts, 3 Phase panel
(tenant to confirm)

15' clear height

New roof (2022; with optional transferable
20-year warranty)

Fully insulated with white cap sheet

Zoned LI - Light Industrial; APN 097-11-164

Nice glass line

In-place back-up generator

Corner location (with street parking allowed)

Call to tour

±8,000 SF

BUILDING SIZE

0.64 AC

LOT SIZE



FLOOR PLAN

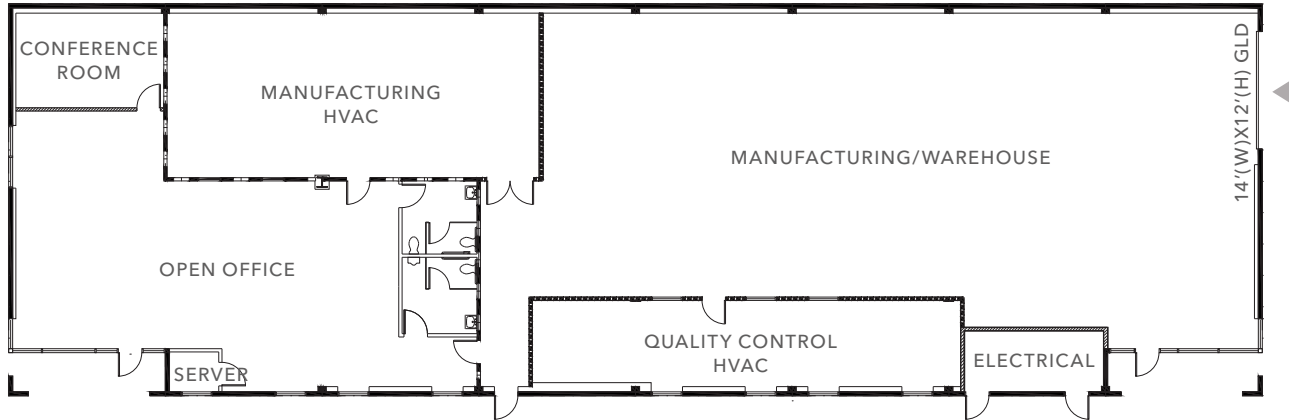

±8,000 SF

BUILDING SIZE

±27,750 SF

LOT SIZE

NOW

AVAILABLE

SITE PLAN

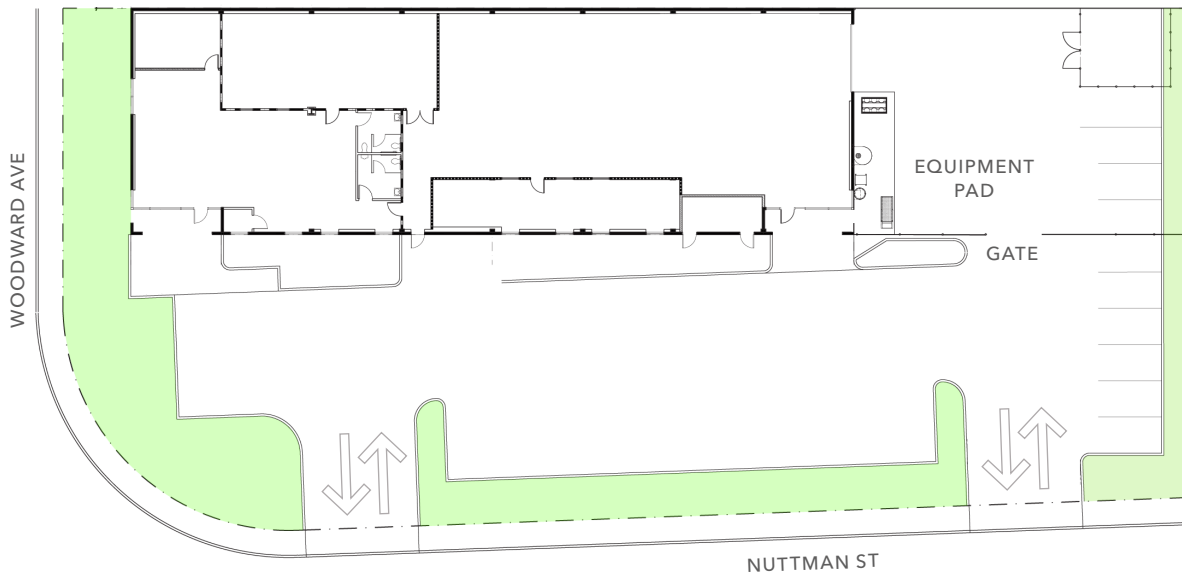

▲ Grade level loading



MERCADO SHOPPING CENTER



550 NUTTMAN ST

SANTA CLARA



THE MARKET PLACE MALL



SANTA CLARA SQUARE MARKETPLACE

SAN JOSE INTERNATIONAL AIRPORT (SJC)

Exclusively listed by

STEVE ZAMUDIO, CCIM
 Executive Vice President
 408.888.7529
 steve.zamudio@kidder.com
 LIC N° 00905956

KIDDER.COM