

**AVAILABLE**

**±13,731 SF**



**6540 PEACHTREE INDUSTRIAL BLVD | PEACHTREE CORNERS, GA 30071**

## PROPERTY OVERVIEW

- Suite B
- ±13,371 SF Total
- ±1,525 SF of Office
- 4 (9'x10') Dock High Doors
- 1 (12' x 14') Drive In Door
- 22'6" Clear Height
- 50' x 40' Column Spacing
- ±0.25 AC of Fenced/Paved Outside Storage
- Ample Power
- Fully-Sprinklered
- Existing Term Through July 31, 2026
- Immediate access to Peachtree Industrial Blvd
- ±3 miles to I-285

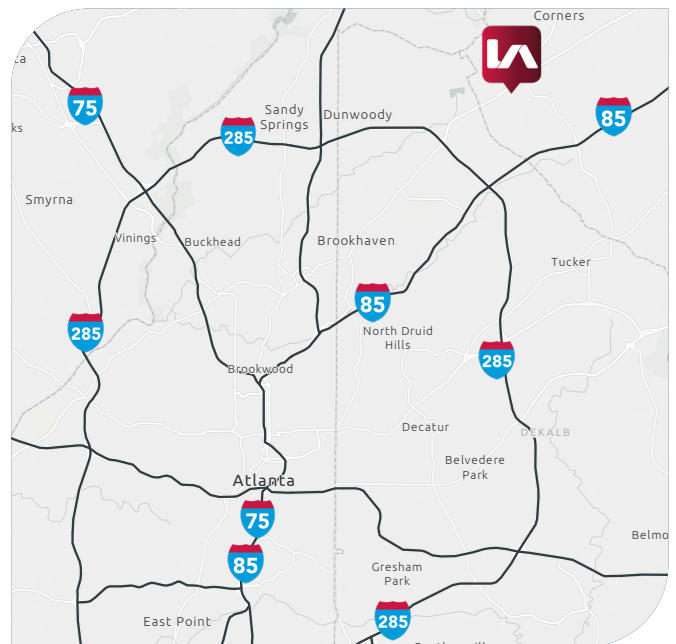

All information furnished regarding property for sale, rental, or financing is from sources deemed reliable, but not warranty or representation is made to the accuracy thereof and same is submitted to errors, omissions, change of price, rental or other conditions prior to sale, lease, or financing or withdrawal without notice. No liability of any kind is to be imposed on the broker herein.



### TRIP ACKERMAN, SIOR

Executive VP / Principal  
tackerman@lee-associates.com  
O: 404.442.2430

### MATTHEW REYNOLDS

Principal | Member Associate, SIOR  
mbreynolds@lee-associates.com  
O: 404.442.2835

### ALEXANDER DENNIS

Associate  
adennis@lee-associates.com  
O: 404.442.2826

**AVAILABLE**

**±13,371 SF | 6540 PEACHTREE INDUSTRIAL BLVD**

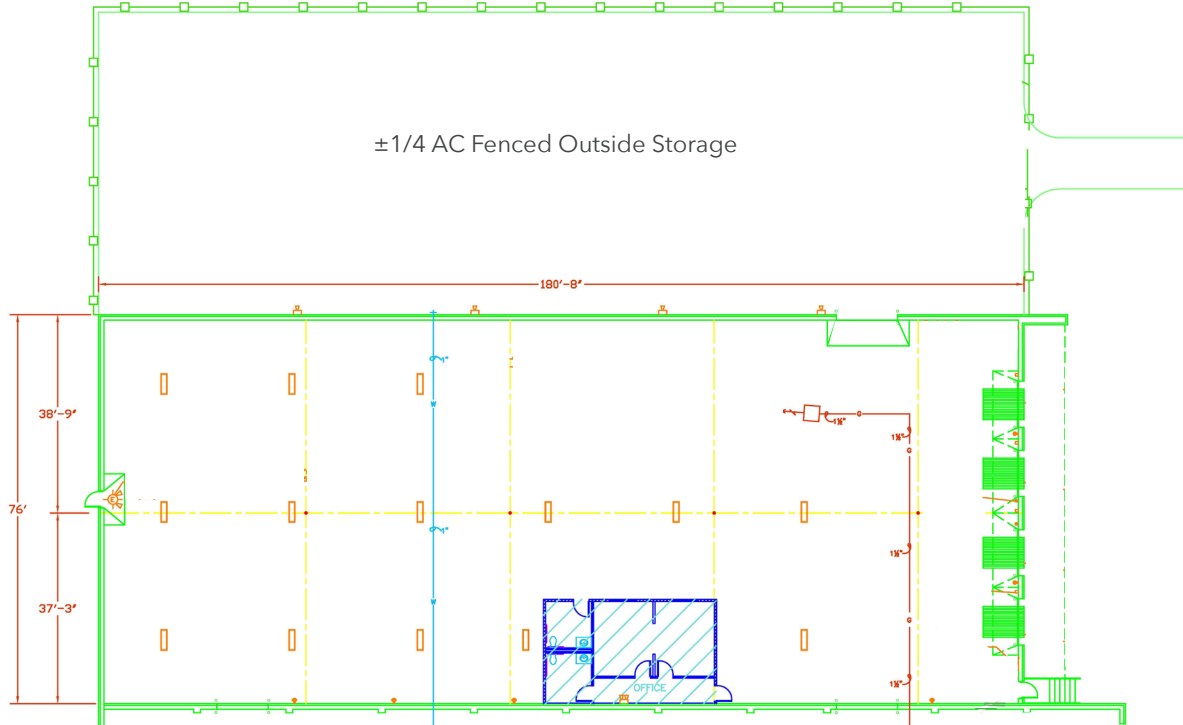

\*Not an accurate representation of existing office



All information furnished regarding property for sale, rental, or financing is from sources deemed reliable, but no warranty or representation is made to the accuracy thereof and same is submitted to errors, omissions, change of price, rental or other conditions prior to sale, lease, or financing or withdrawal without notice. No liability of any kind is to be imposed on the broker herein.

**TRIP ACKERMAN, SIOR**  
Executive VP / Principal  
tackerman@lee-associates.com  
O: 404.442.2430

**MATTHEW REYNOLDS**  
Principal | Member Associate, SIOR  
mbreynolds@lee-associates.com  
O: 404.442.2835

**ALEXANDER DENNIS**  
Associate  
adennis@lee-associates.com  
O: 404.442.2826

