



Auto/Industrial Space for Lease

**10TH AVENUE & S CLAREMONT STREET
SAN MATEO, CA**

Availability

±1,850 to ±5,000 sf spaces available

Rental Rate

\$2.25/sf NNN

Property Highlights

Heavy industrial/auto space available

On-site parking

Corner location in high traffic area adjacent to
Downtown San Mateo

Grade level and drive thru access

Current use and configuration perfectly set up for
auto users

For information, please contact:

Dan Matteucci

Executive Managing Director

t 650-358-5276

dan.matteucci@nrmk.com

CA RE License #01848064

nrmk.com

NEWMARK

The distributor of this communication is performing acts for which a real estate license is required. The information contained herein has been obtained from sources deemed reliable but has not been verified and no guarantee, warranty or representation, either express or implied, is made with respect to such information. Terms of sale or lease and availability are subject to change or withdrawal without notice. 19-0379 • 01/21

10TH AVENUE & S CLAREMONT STREET, SAN MATEO, CA

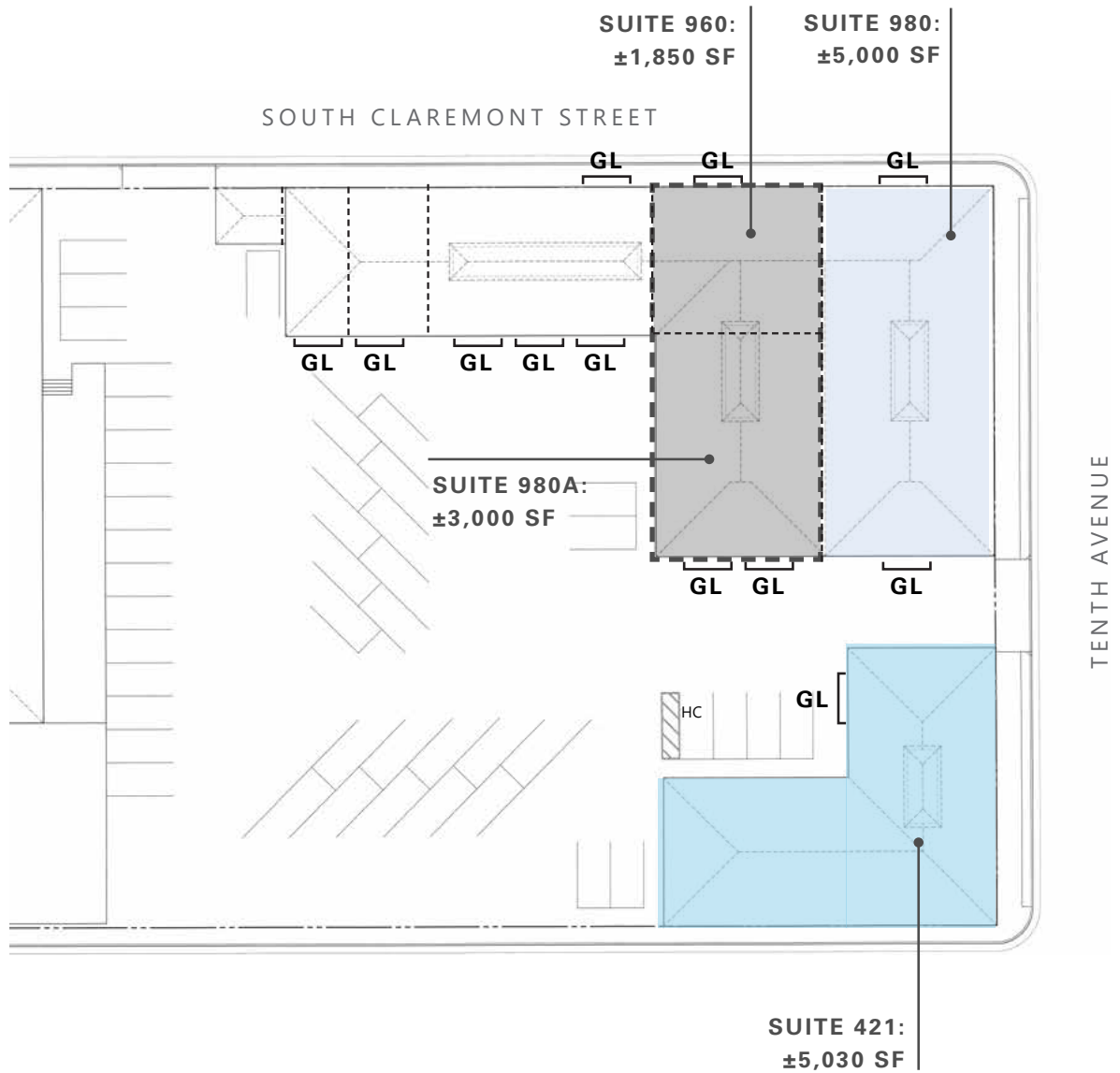

For information, please contact:

Dan Matteucci
Executive Managing Director
t 650-358-5276
dan.matteucci@nrmk.com
CA RE License #01848064

nrmk.com

NEWMARK

The distributor of this communication is performing acts for which a real estate license is required. The information contained herein has been obtained from sources deemed reliable but has not been verified and no guarantee, warranty or representation, either express or implied, is made with respect to such information. Terms of sale or lease and availability are subject to change or withdrawal without notice. 21-0026 • 08/22

10TH AVENUE & S CLAREMONT STREET, SAN MATEO, CA



For information, please contact:

Dan Matteucci
 Executive Managing Director
 t 650-358-5276
 dan.matteucci@nrmk.com
 CA RE License #01848064

nrmk.com



The distributor of this communication is performing acts for which a real estate license is required. The information contained herein has been obtained from sources deemed reliable but has not been verified and no guarantee, warranty or representation, either express or implied, is made with respect to such information. Terms of sale or lease and availability are subject to change or withdrawal without notice. 19-0379 • 01/21

10TH AVENUE & S CLAREMONT STREET SAN MATEO, CA



For information, please contact:

Dan Matteucci

Executive Managing Director

t 650-358-5276

dan.matteucci@nmrk.com

CA RE License #01848064

nmrk.com

NEWMARK

The distributor of this communication is performing acts for which a real estate license is required. The information contained herein has been obtained from sources deemed reliable but has not been verified and no guarantee, warranty or representation, either express or implied, is made with respect to such information. Terms of sale or lease and availability are subject to change or withdrawal without notice. 19-0379 • 01/21