

# COLOCATION DATA CENTER FOR SUB-LEASE

PREMIER WEST TORONTO LOCATION

83,000 SF Building with 1.9 MW

45% of the Power is leased

9,000 SF / 1 MW Vacant

Purpose Built, 2 Story Data Center

FOR MORE INFORMATION, PLEASE CONTACT:

**RANDOLPH BORRON\***

Vice Chairman

+1 416 908 2474

[randy.borron@cushwake.com](mailto:randy.borron@cushwake.com)

**SEAN BRADY\***

Managing Director

+1 201 460 3342

[sean.brady@cushwake.com](mailto:sean.brady@cushwake.com)

**MICHAEL BORRON\*\***

Broker - Associate Vice President

+1 416 571 2474

[michael.borron@cushwake.com](mailto:michael.borron@cushwake.com)

\*Sales Representative, \*\* Broker





## Data Center Highlights

- Purpose built, 2 story data center
- Premier West Toronto location-1800 Argentia Road in Mississauga
- Fiber providers include: Beanfield, Zayo, Bell Canada, Hydro one, Allstream and Rogers
- 83,000 square feet
- 23,000 square feet raised floor, 24 inches
- 28,000 square feet raised floor, 16 inches
- Drop T-bar ceiling, appr. 9 feet
- Dual feed power (Parallel Loop)
- 2 large Meet-Me-Rooms

## Leasing Details

- Lease Term: Expires Sept 19, 2035
- Possession: 30 days
- Available Power: 1.027 Megawatts
- Available White Floor: 9,000 SF
- Leased Power: 0.876 Megawatts



## Building

- 1 elevator (renovated in 2008)
- 1 shipping \ receiving door at dock level on 1<sup>st</sup> floor
- 4 Conference & meeting rooms
- Six data halls across 2 floors
- Parking: 96 surface level spaces
- Ceiling Height: Front half of building is 142 inches from top of raised floor to the upper deck (raised floor is 1.5 Feet height underneath). Back half of building is 12.33 Feet from top of raised floor to the upper deck, (raised floor is 24 inches in underneath)
- 1 cafeteria on each floor
- Floor loading: 300lbs PSF
- Concurrently maintainable i.e. aligned to Uptime Tier 3
- VESDA with dry pipe pre-action sprinklers
- HSSD smoke detection and suppression system
- Integrated Building Monitoring System

## Cooling

- DX Cooling system and leak detection deployed
- PUE for the building is - 2.37
- AC8 Integrated BMS system. The BMS system monitors and controls the HVAC for both the comfort cooling and the Data Center space.

## Power

- A/B transformers in 2N configuration (replaced in 2016) - Back Half
- A Transformer - Front Half
- Generator fuel supply supports 24 hours at full load
- 36 - 40 hours fuel generation time on-site
- Front half - N+1 UPS Two (2) x 675 KVA Eaton, 1 x 300 KVA Vertiv UPS, (1) x 2000 KVA Diesel Generator with 23k liter fuel tank
- Back half - 2N UPS Eight (8) x 500 kVA UPS modules; UPS batter autonomy supports a minimum of 15 minutes at full load N+1, Three (3) 2200 kVA Diesel generators , Generator fuel supply supports 24 hours at full load 50K liter fuel tank
- N+1, Forty-Three (43) Liebert computer room air conditioning units; multiple CRAC units with ICOM controls configured as (N + 20%); return plenum (Back half) HVAC solution for more efficient heat removal in the MS area; DX cooling system



## Security Features

- 24X7 on-site security services; via security and DCO personnel
- Proximity card-access with single and dual factor authentication
- Video recording throughout the facility
- 90 days of video retention

## Connectivity

- Carrier neutral facility with diverse entry points to the site
- Connected to the cloud with highly available internet access
- Fully redundant, meshed network. Remain resilient and recover across global network

## Certification

- ISO 27001 (Information Security Management)
- ISO 20000 (Service Management)
- SSAE18/ISAE 3402 Report
- PCI-DSS Compliance (physical environment)

## Travel Information

- Road: less than 1 mile from major highway
- Easily accessible by public transport
- 12 Miles from Toronto Pearson International Airport

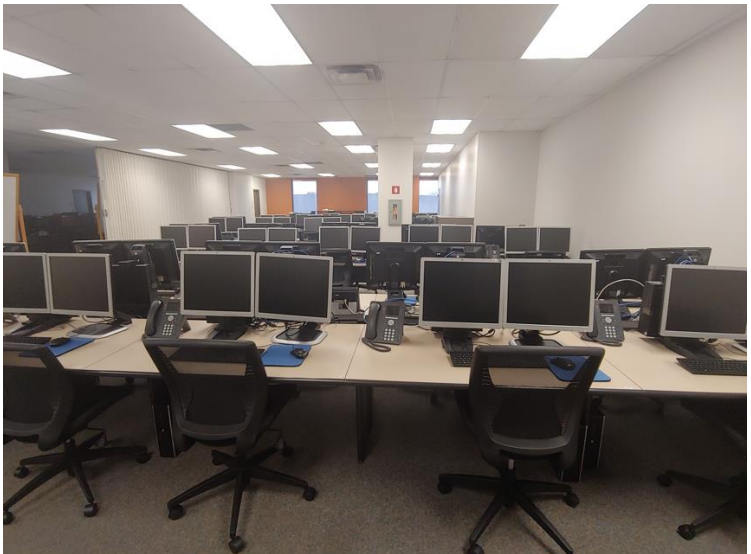

# Ground Floor

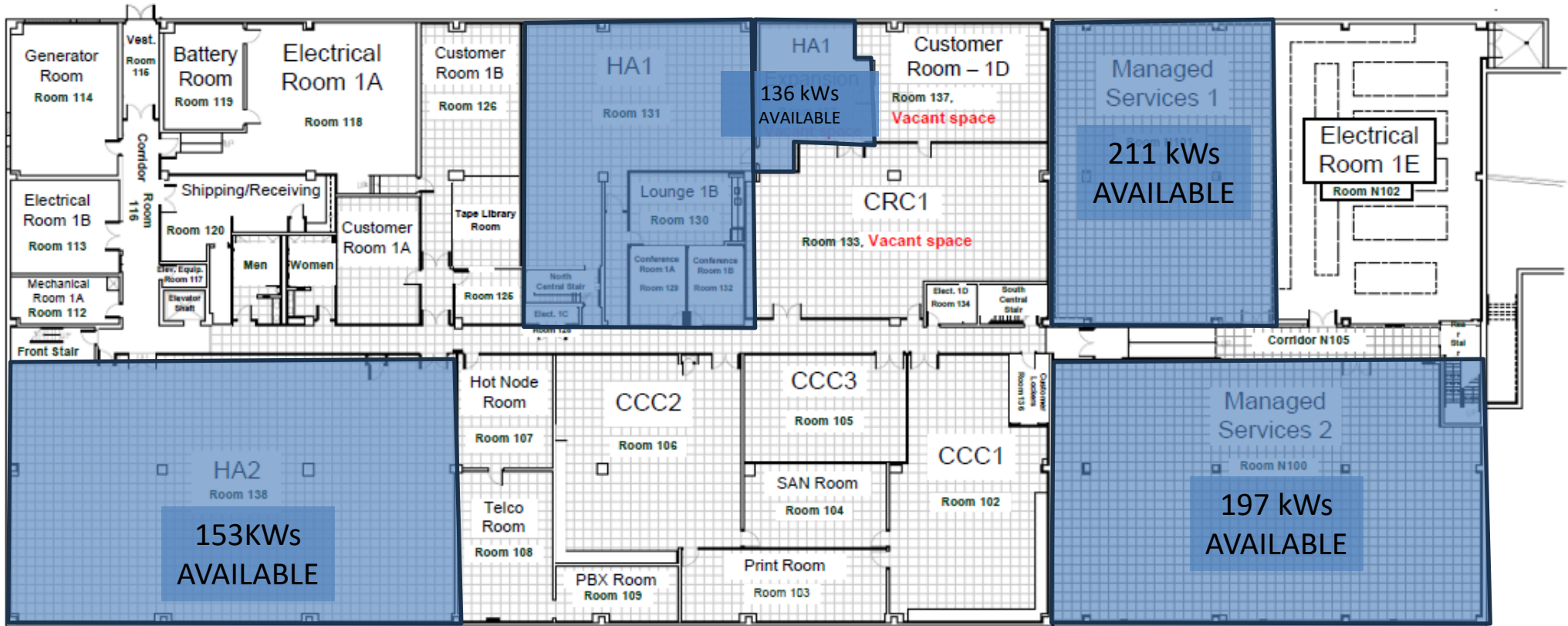

# Second Floor

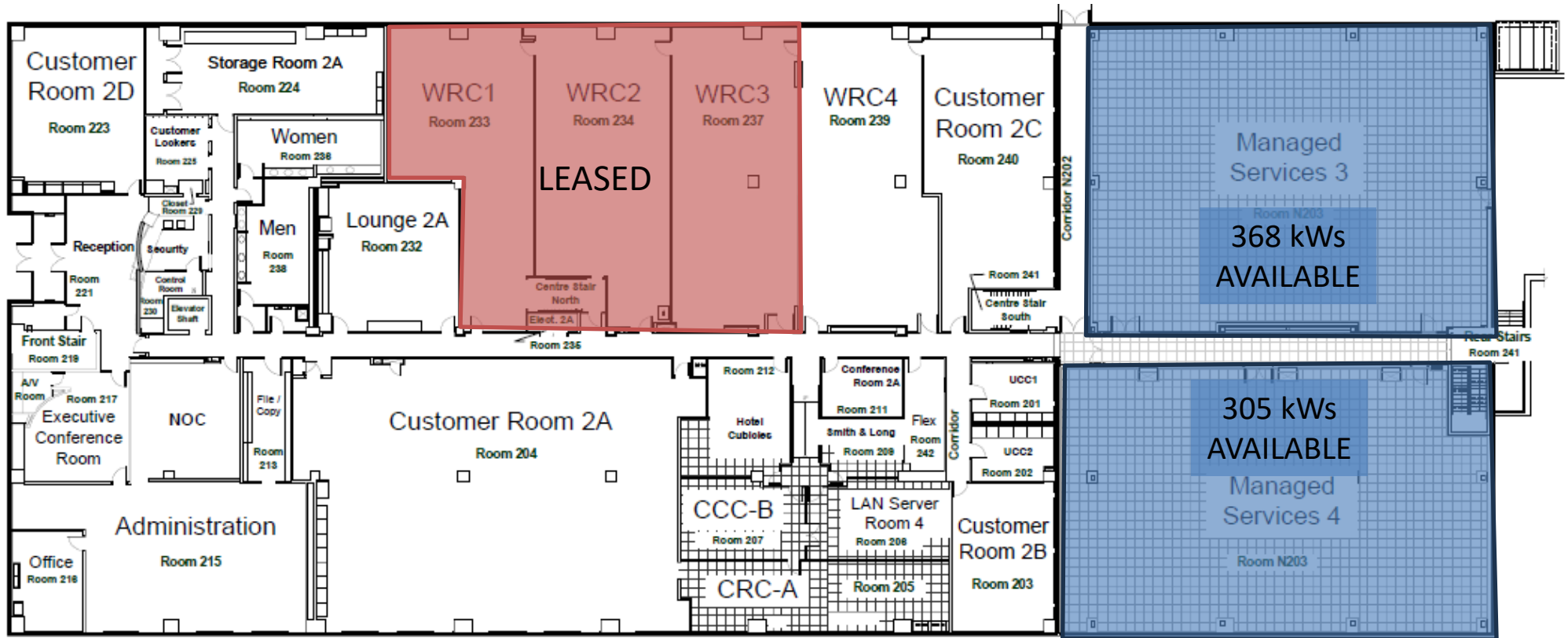

# COLOCATION DATA CENTER FOR LEASE – PREMIER WEST TORONTO LOCATION

FOR MORE INFORMATION, PLEASE CONTACT:

**RANDOLPH BORRON\***

Vice Chairman

+1 416 908 2474

[randy.borron@cushwake.com](mailto:randy.borron@cushwake.com)

**SEAN BRADY\***

Managing Director

+1 201 460 3342

[sean.brady@cushwake.com](mailto:sean.brady@cushwake.com)

**MICHAEL BORRON\*\***

Broker – Associate Vice President

+1 416 571 2474

[michael.borron@cushwake.com](mailto:michael.borron@cushwake.com)

\*Sales Representative, \*\* Broker