

FOR LEASE

PRIME RETAIL

Ocean City Square | Ocean City, MD



Lease Price: \$21.95 PSF NNN

SF Available: 600, 750 & 1,650 SF

Units Available: 120-I & 11805 Q & O

PROPERTY OVERVIEW:

Ocean City Square is one of the busiest uptown retail locations in Ocean City. Anchored by Food Lion and Whiskers Pub with outparcel tenants including Dunkin' Donuts, Sunsations, Sherwin-Williams and 7-11. Two signalized accesses make this a great retail center. This center has a great mix of businesses which generate a tremendous amount of daily foot traffic.



RINNIER
DEVELOPMENT COMPANY

218 East Main Street
Salisbury, MD 21801
www.rinnier.com

Blair Rinnier, CCIM, CPM
410.742.8151 x 103
brinnier@rinnier.com

FOR LEASE

PRIME RETAIL

Ocean City Square | Ocean City, MD

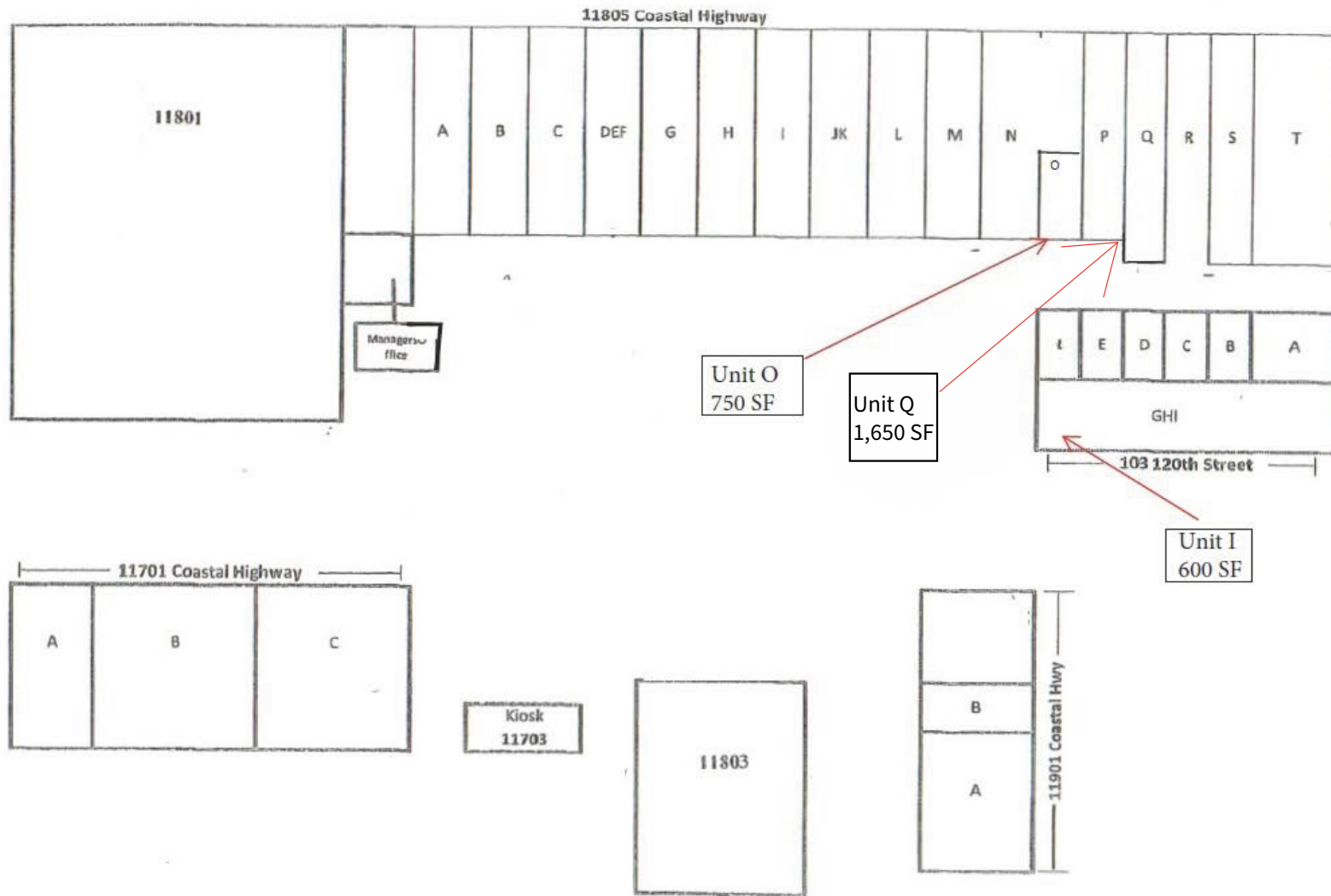

\$21.95 PSF NNN; CAM fees estimated @ \$6.25 PSF



RINNIER
DEVELOPMENT COMPANY

218 East Main Street
Salisbury, MD 21801
www.rinnier.com

Blair Rinnier, CCIM,
CPM 410.742.8151 x 103
brinnier@rinnier.com

Aerial

PRIME RETAIL

Ocean City Square | Ocean City, MD



RINNIER
DEVELOPMENT COMPANY

218 East Main Street
Salisbury, MD 21801
www.rinnier.com

Blair Rinnier, CCIM, CPM
410.742.8151 x 103
brinnier@rinnier.com

PHOTOS

PRIME RETAIL

Ocean City Square | Ocean City, MD



RINNIER
DEVELOPMENT COMPANY

218 East Main Street
Salisbury, MD 21801
www.rinnier.com

Blair Rinnier, CCIM, CPM
410.742.8151 x 103
brinnier@rinnier.com