

GLEMKA BUSINESS PARK - MURRIETA

38436 INNOVATION COURT, SUITE 102, MURRIETA, CALIFORNIA 92563

±3,300 SF
INDUSTRIAL SPACE
FOR LEASE



FOR MORE INFORMATION, PLEASE CONTACT:

CAREY PASTOR | Senior Vice President

(951) 297-7434 | cpastor@cbcsocalgroup.com

CalDRE License # 01403298



**COLDWELL
BANKER
COMMERCIAL
SC**

Corp. Cal DRE License # 02089395

GLEMKA BUSINESS PARK - MURRIETA

38436 INNOVATION COURT, SUITE 102, MURRIETA, CALIFORNIA 92563

±3,300 SF
INDUSTRIAL SPACE
FOR LEASE

PROPERTY HIGHLIGHTS

- ±3,300 SF industrial space for lease
- Office improvements consist of a reception area, 1 private office and 1 restroom
- 200 Amp, 120/208 volt 3 phase power supply
- 10' x 12' roll up door
- Industrial Park (IP) Zoning – County of Riverside Unincorporated
- Professionally managed business park



GLEMKA BUSINESS PARK - MURRIETA

38436 INNOVATION COURT, SUITE 102, MURRIETA, CALIFORNIA 92563

±3,300 SF
INDUSTRIAL SPACE
FOR LEASE

AVAILABILITY

UNIT	UNIT SIZE	BASE RENTAL RATE	DESCRIPTION
102	±3,300 SF	\$4,257.00 Base Rent + CAO E*	Reception area, 1 private office, 1 restroom, warehouse with roll up door.

*Monthly Common Area Operating Expenses (CAOE) estimated at \$627.00 per month for YE 2025 and are subject to annual reconciliation and increase

SITE PLAN



TYPICAL FLOOR PLAN

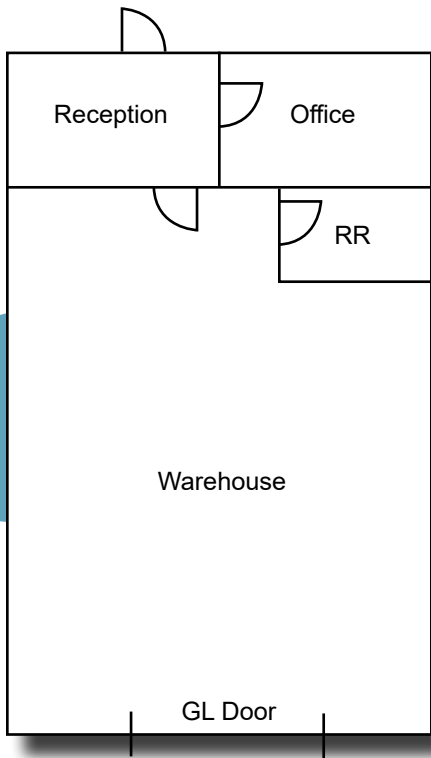

* Not to scale

GLEMKA BUSINESS PARK - MURRIETA

38436 INNOVATION COURT, SUITE 102, MURRIETA, CALIFORNIA 92563

±3,300 SF
INDUSTRIAL SPACE
FOR LEASE



Coldwell Banker Commercial and the Coldwell Banker Commercial Logo are registered service marks licensed to Coldwell Banker Commercial Affiliates. Each Office is Independently Owned and Operated. All information contained herein has been obtained from sources deemed reliable. However, no warranty or guarantee is made as to the accuracy of the information.

CalDRE License # 02089395

GLEMKA BUSINESS PARK - MURRIETA

38436 INNOVATION COURT, SUITE 102, MURRIETA, CALIFORNIA 92563

±3,300 SF
INDUSTRIAL SPACE
FOR LEASE

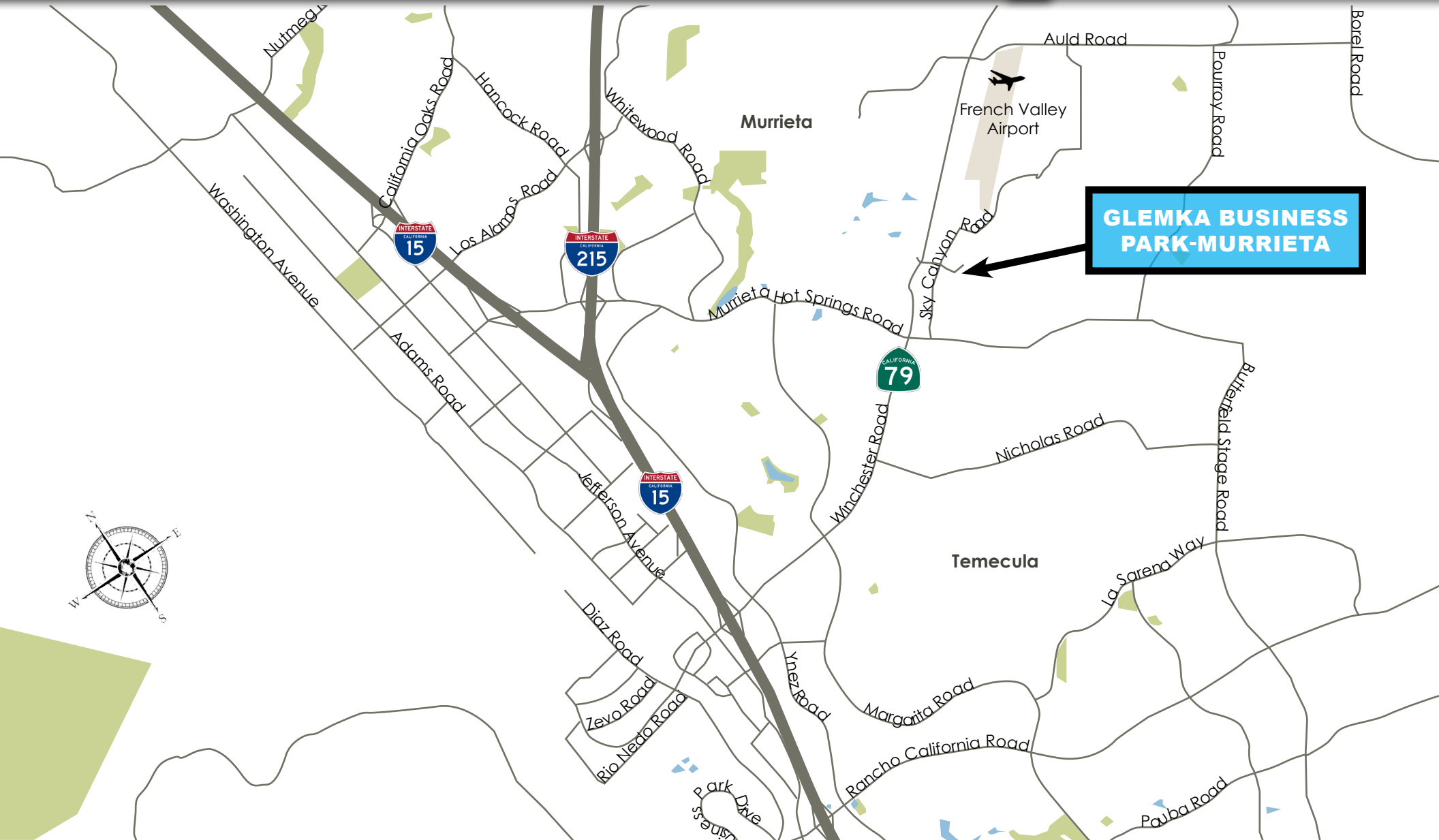

**GLEMKA BUSINESS
PARK-MURRIETA**

GLEMKA BUSINESS PARK - MURRIETA

38436 INNOVATION COURT, SUITE 102, MURRIETA, CALIFORNIA 92563

±3,300 SF
INDUSTRIAL SPACE
FOR LEASE



FOR MORE INFORMATION, PLEASE CONTACT:

CAREY PASTOR

Senior Vice President

951.297.7434

cpastor@cbcsocalgroup.com

CalDRE # 01403298

27368 Via Industria | Suite 102
Temecula | California | 92590
t 951.200.7683 | f 951.239.3147
cbcsocalgroup.com



**COLDWELL
BANKER
COMMERCIAL
SC**