



FULLY AIR-CONDITIONED WAREHOUSE

AVAILABILITY DETAILS

SPECIFICATIONS	Unit 2
Total Unit Size SF	±18,336
Warehouse SF	±11,336
Office SF	±7,000
Ceiling Height ±	22'
Loading Docks	2
Drive-in Doors	1
Power	Heavy, 3Phase 480V
Term Through	6/30/2028



AVAILABILITY SUMMARY

Industrial unit for sublease located in desirable West Caldwell industrial park. The available space totals ±18,336 SF which includes both fully air-conditioned warehouse and well-appointed office space.

The building features 22' foot clear ceilings, 2 loading docks, 1 drive-in door, and large truck court that can easily accommodate 53' tractor trailers. Heavy 3 Phase power also services the building and was recently upgraded by Tenant.

This convenient location is in close proximity to Routes 46, 80, 23, 280, 287 and 3.

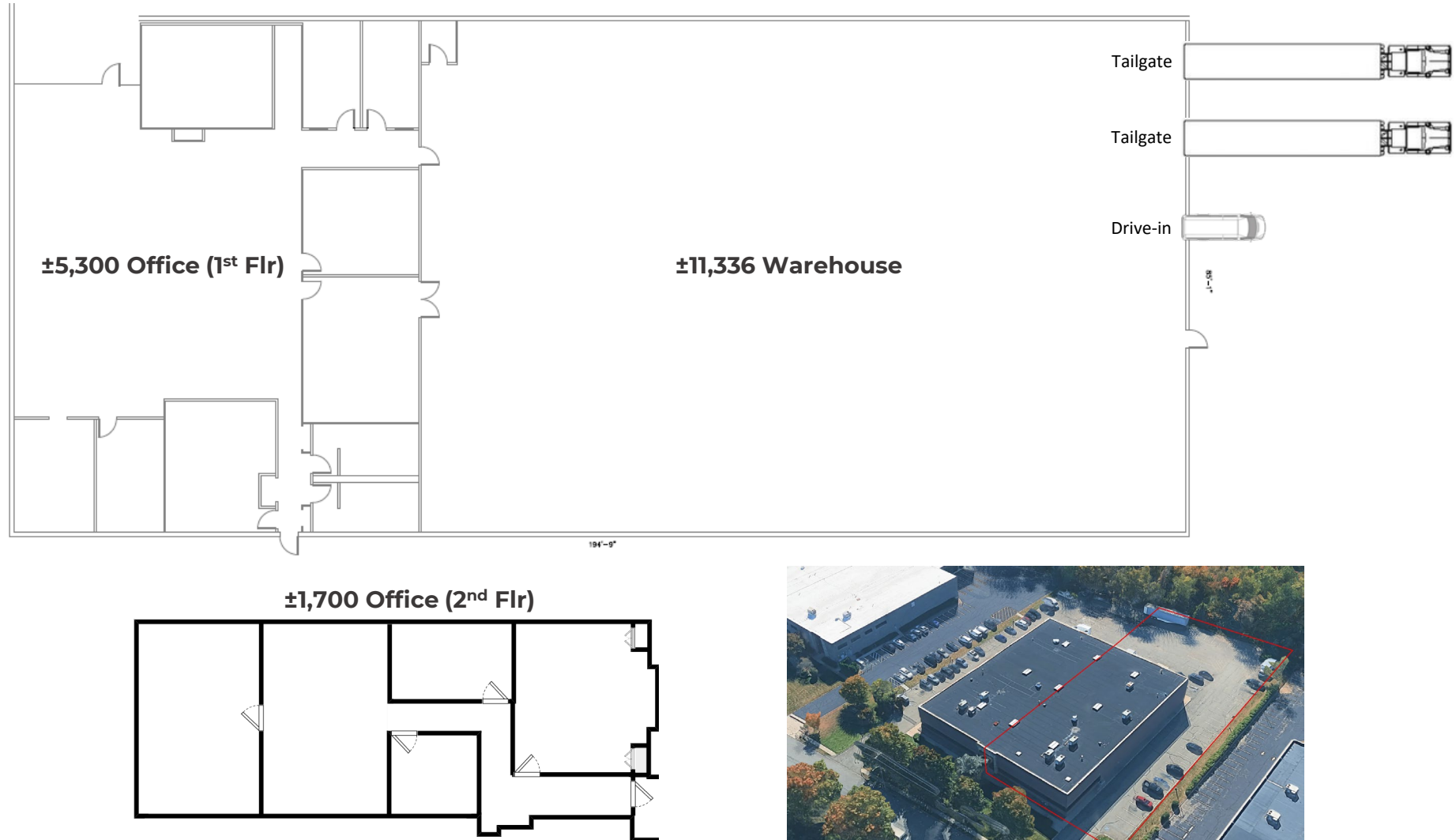



FOR SUBLEASE
INDUSTRIAL | FLEX

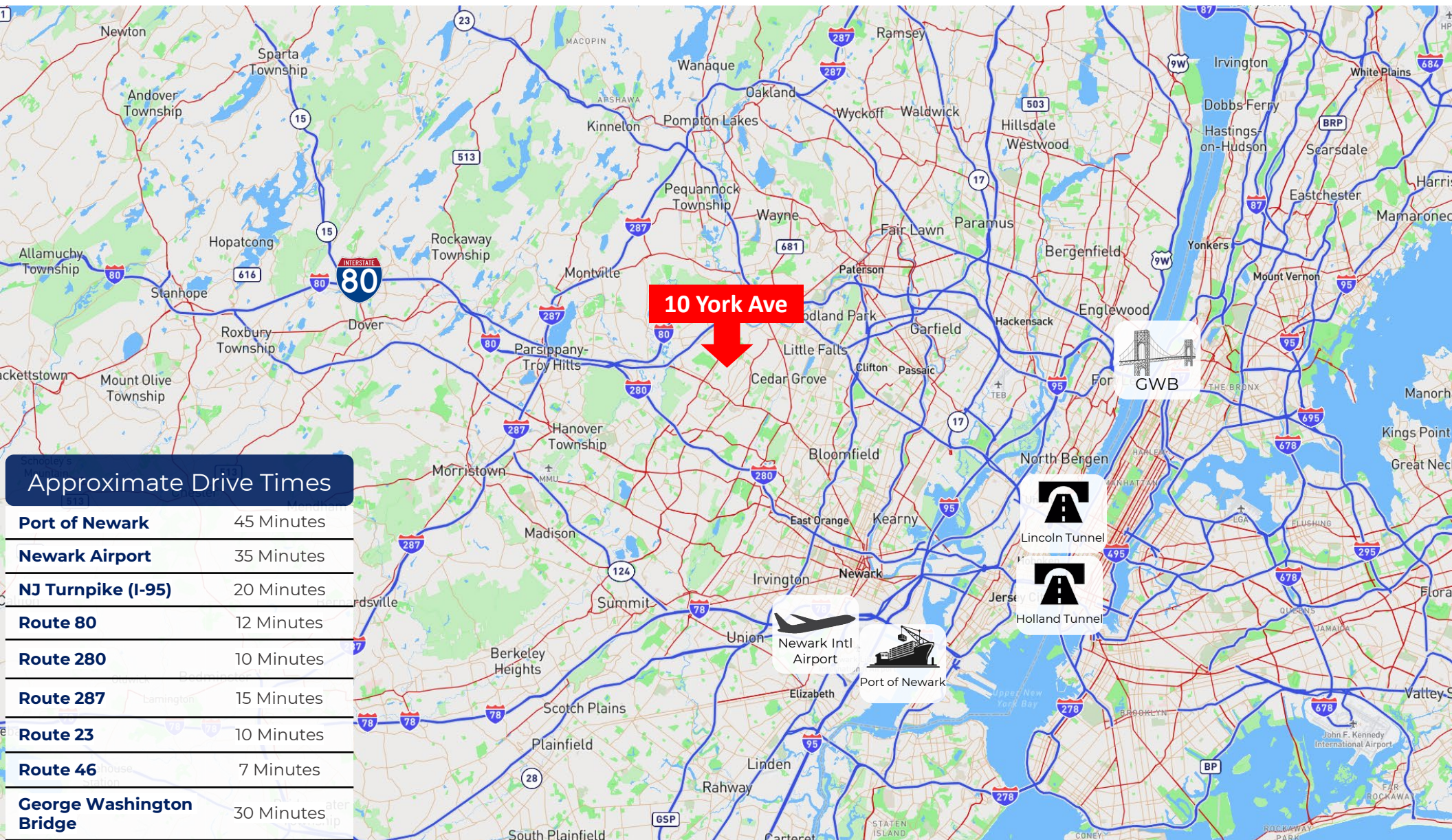

DEREK GEE
Sales Associates
973.771.9548
dgee@gardenstaterealty.net

GARDEN STATE REALTY
204 Passaic Ave, Suite 1
Fairfield, NJ 07004
gardenstaterealty.net

The depiction in the included photograph of any person, entity (in, logo or property, other than Garden State Realty's (GSR) client and the property offered by GSR, is incidental only, and is not intended to connote any affiliation, connection, association, sponsorship or approval by or between that person, entity, logo or property and GSR or its client. This listing shall not be deemed an offer to lease, sublease or sell such property; and, in the event of any transaction for such property, no commission shall be earned by or payable to any cooperating broker except with respect to otherwise provided pursuant to the express terms, rates and conditions of GSR's agreement with its principal, if, as and when such commission (if any) is actually received from such principal. (A copy of the rates and conditions referred to above with respect to this property is available upon request.)