

302 EAST ATLANTIC

D E L R A Y B E A C H

Gorgeous move-in ready
office space

3,888 SF

Located at the epicenter of Atlantic Avenue,
Delray's most exclusive office address.



CLICK TO VIEW VIRTUAL TOUR!

CBRE

302 EAST ATLANTIC

DELRAY BEACH

Address	302 East Atlantic Avenue, Delray Beach, FL 33483
Availability	±3,888 SF
Rental Rate	\$65.00 NNN
Security	24/7
Stories	2
Parking	On-site Parking



BEST OFFICE SPACE IN DOWNTOWN DELRAY

BUILDING AMENITIES



Gorgeous window line with abundance of natural light.



24/7 security on-site.



The building is situated near the best of Downtown Delray on Atlantic Ave. Nearby businesses include Starbucks, Capital One Cafe, Cut 432, Urban Outfitters, Bounce, Taverna Opa, Vic & Angelo's, and so much more.



Steps from the Beach.

AVAILABLE SPACE

Ability to combine with adjacent space to reach 7,052 SF

Suite 02B
3,888 SF

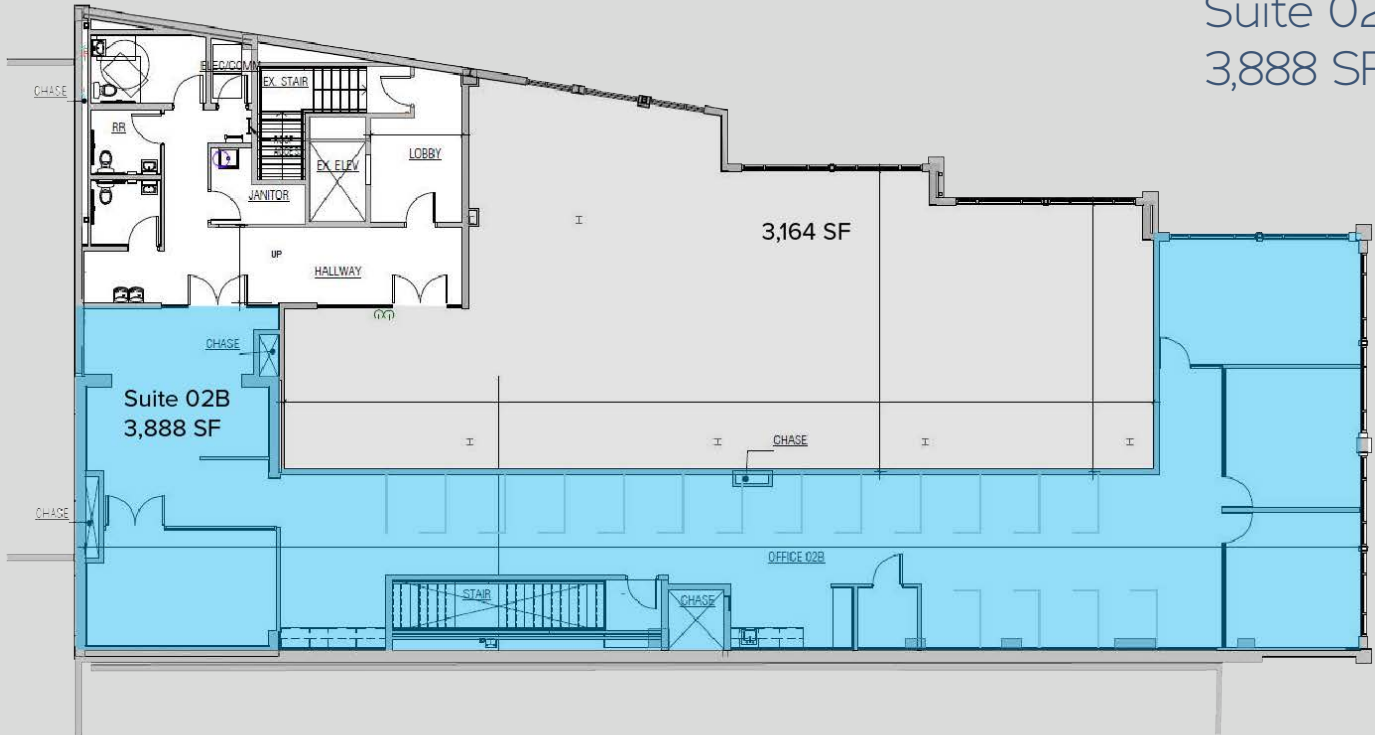



302 EAST ATLANTIC

D E L R A Y B E A C H

FOR MORE INFORMATION

Please Contact

Max Pawk
Vice President
M +1 561 393 1670
max.pawk@cbre.com

CBRE