

# D&D INDUSTRIAL

18501 COLLIER AVENUE, LAKE ELSINORE, CA 92530

## FOR LEASE

±2,894 SF INDUSTRIAL SPACE



**FOR MORE INFORMATION, PLEASE CONTACT:**

**CAREY PASTOR** | Senior Vice President

(951) 297-7434 | [cpastor@cbcsocalgroup.com](mailto:cpastor@cbcsocalgroup.com)

CalDRE License # 01403298



**COLDWELL BANKER  
COMMERCIAL**  
SC



# D&D INDUSTRIAL

18501 COLLIER AVENUE, LAKE ELSINORE, CA 92530

**FOR LEASE**

**±2,894 SF INDUSTRIAL SPACE**

## PROPERTY HIGHLIGHTS

- ±2,894 SF Industrial space available
- 1-12'w x 14'h roll-up door per unit
- 17' clear height
- 200 amp, 3 phase power supply per unit
- Central business location within I-15 corridor
- Retail and restaurant amenities nearby including:  
Lowe's The Home Depot, Costco, Target, Chili's,  
Starbucks



# D&D INDUSTRIAL

18501 COLLIER AVENUE, LAKE ELSINORE, CA 92530

## FOR LEASE

±2,894 SF INDUSTRIAL SPACE

## AVAILABILITY

UNIT	UNIT SIZE	MONTHLY LEASE RATE	DESCRIPTION
A-100	±2,894 SF	\$4,196.00 Per month	Reception area, open office, 1 restroom and warehouse with 1 roll up door

## SITE PLAN

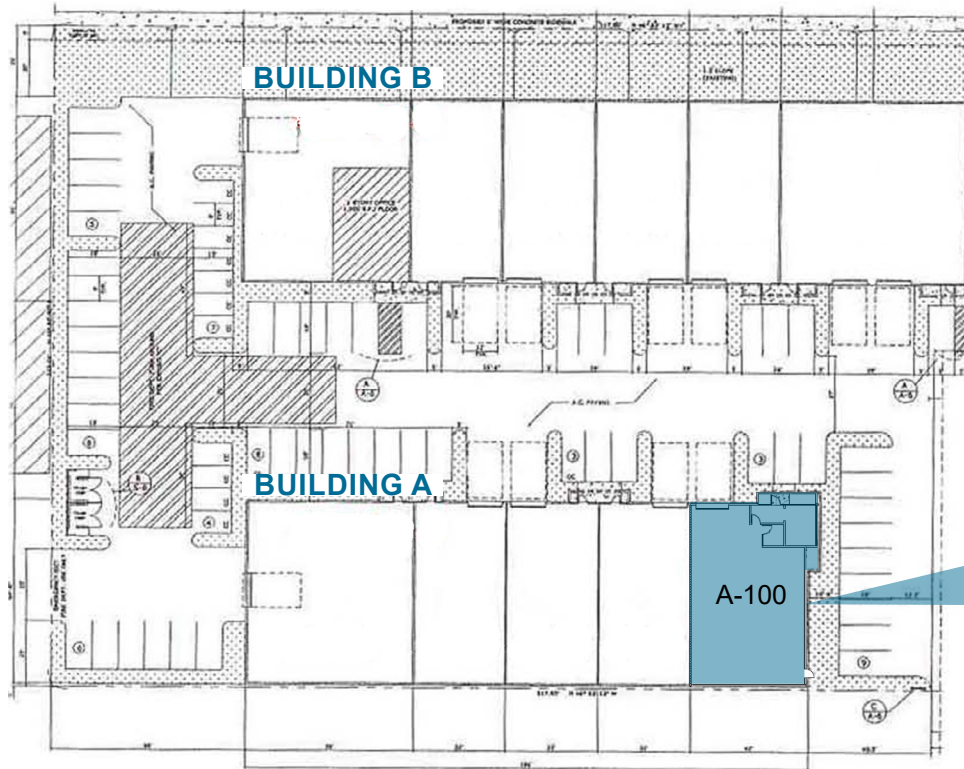

## FLOOR PLAN A-100

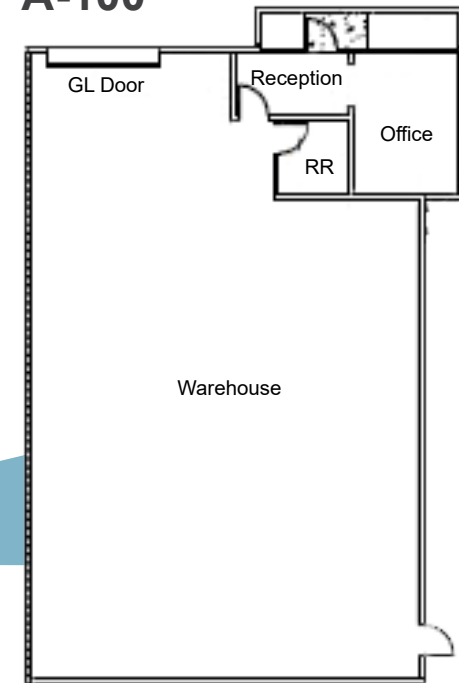

\* Not to scale



# D&D INDUSTRIAL

18501 COLLIER AVENUE, LAKE ELSINORE, CA 92530

## FOR LEASE

±2,894 SF INDUSTRIAL SPACE





# D&D INDUSTRIAL

18501 COLLIER AVENUE, LAKE ELSINORE, CA 92530

## FOR LEASE

±2,894 SF INDUSTRIAL SPACE



Coldwell Banker Commercial and the Coldwell Banker Commercial Logo are registered service marks licensed to Coldwell Banker Commercial Affiliates. Each Office is Independently Owned and Operated. All information contained herein has been obtained from sources deemed reliable. However, no warranty or guarantee is made as to the accuracy of the information.

CalDRE License # 02089395



# D&D INDUSTRIAL

18501 COLLIER AVENUE, LAKE ELSINORE, CA 92530

FOR LEASE

±2,894 SF INDUSTRIAL SPACE



FOR MORE INFORMATION, PLEASE CONTACT:

**CAREY PASTOR**

Senior Vice President

951.297.7434

[cpastor@cbcsocalgroup.com](mailto:cpastor@cbcsocalgroup.com)

CalDRE # 01403298

27368 Via Industria | Suite 102  
Temecula | California | 92590  
t 951.200.7683 | f 951.239.3147  
[cbcsocalgroup.com](http://cbcsocalgroup.com)



**COLDWELL BANKER  
COMMERCIAL**  
SC