

PARK PLACE SHOPPING CENTER  
LONGVIEW, TEXAS



Offered Exclusively by:  
Beer Wells Real Estate Services – East Texas, Inc.  
PO Box 3449  
Longview TX 75606  
[www.beerwellseasttexas.com](http://www.beerwellseasttexas.com)

For more information, contact:

Walter R. Northcutt  
903-753-2191 Office  
903-253-7398 Cell  
[wnorthcutt@beerwellseasttexas.com](mailto:wnorthcutt@beerwellseasttexas.com)



---

## PROPERTY INFORMATION

<b>Location:</b>	1905 NW Loop 281 Suites 72 & 73
<b>General Access:</b>	Loop 281 North West of Gilmer Road
<b>Gross Leasable Area:</b>	Approximately 5,000 SF
<b>Amenities:</b>	High Visibility, Easy Access, Excellent signage, Ample Parking
<b>Zoning:</b>	Commercial



## SITE PLAN

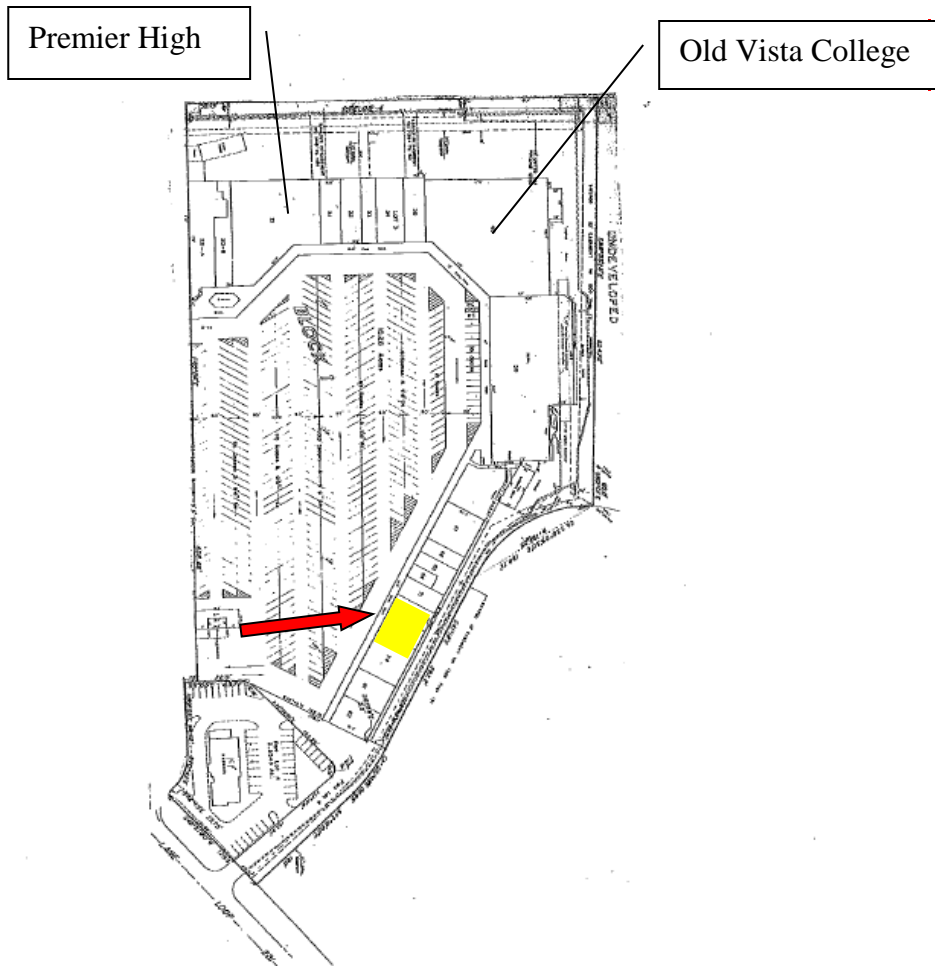

PARK PLACE SHOPPING CENTER  
LONGVIEW, TEXAS



## AERIAL



This information has been secured from sources we believe to be reliable, but we make no representations or warranties, expressed or implied, as to the accuracy of the information. References to square footage or age are approximate.



PARK PLACE SHOPPING CENTER  
LONGVIEW, TEXAS



## MAP

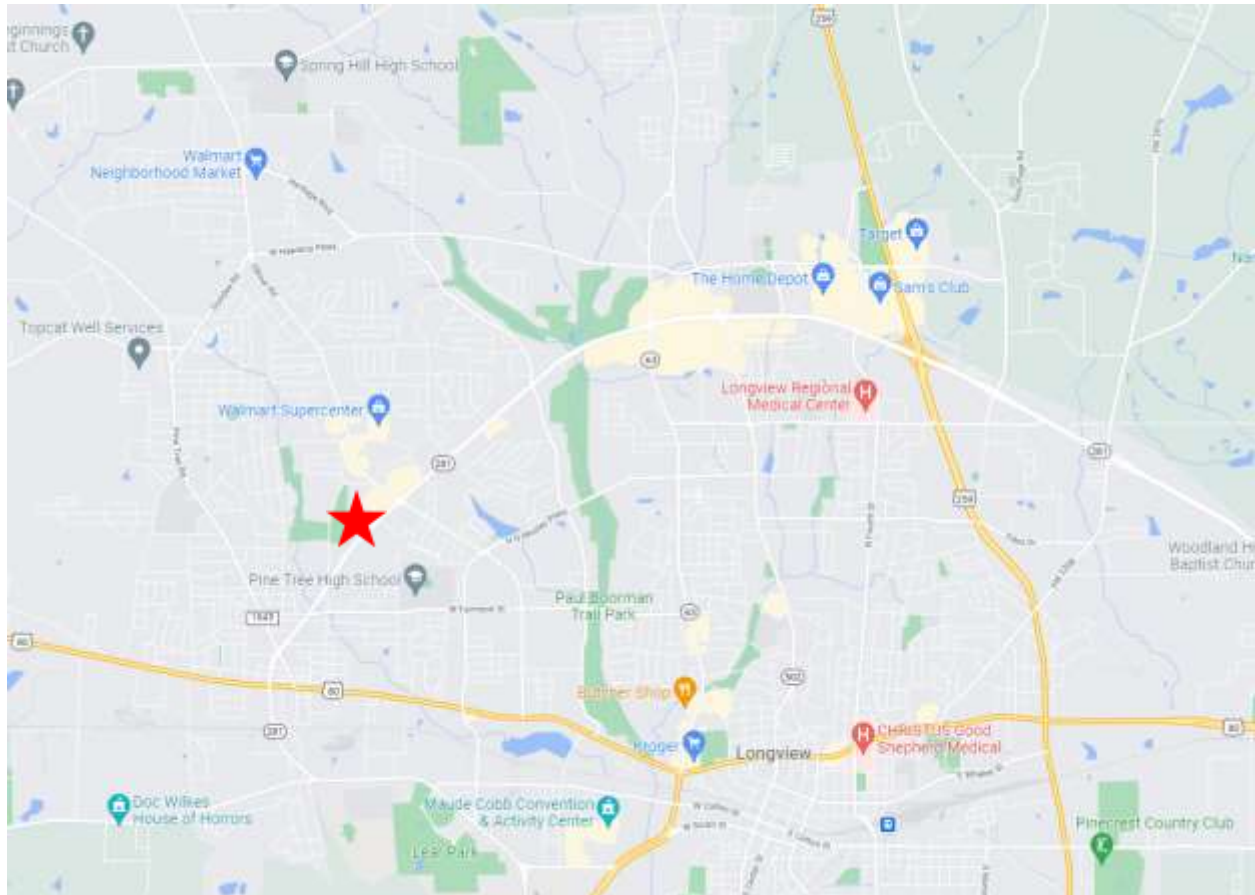

This information has been secured from sources we believe to be reliable, but we make no representations or warranties, expressed or implied, as to the accuracy of the information. References to square footage or age are approximate.

## TRAFFIC COUNTS

