

# BRIO

*Commercial Space for Lease in  
Modern Mixed-Use Building in  
the Heart of Bellevue*

1021 112TH AVE NE  
BELLEVUE, WA 98004

EXCLUSIVELY LISTED BY

MONICA WALLACE  
425.753.4121  
monica.wallace@kidder.com

KIDDER.COM



# *AN ELEVATED* OFFICE & RETAIL EXPERIENCE



## PRIME LOCATION

Ideally situated in the heart of Downtown Bellevue



## MODERN MIXED-USE BUILDING

Features a sleek design with ample natural light from extensive windows



## NEARBY AMENITIES

Close to Farine Bakery, Sola Salons, bStrong Fitness, and a variety of restaurants within one block



## GREAT CONNECTIVITY

Easy access to freeways and light rail for convenient commuting; free visitor parking on-site



SALON  
44

AVAILABLE FOR LEASE



KIDDER MATHEWS

# SUITE 206

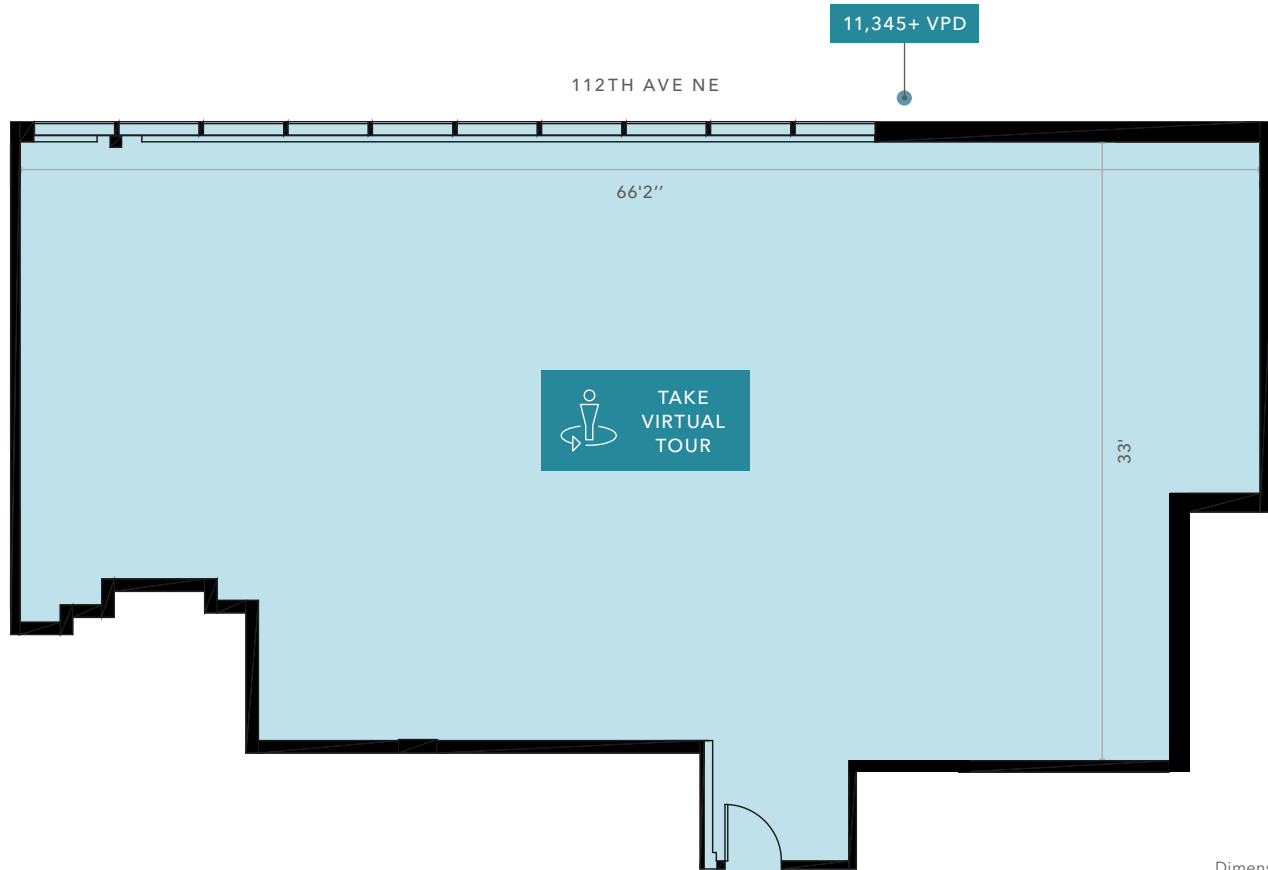

Dimensions are subject to Tenant's field verification

*2,416 SF*

AVAILABLE

*\$40.00*

LEASE RATE/SF, NNN

*\$15.78*

2024 EST. NNN RATE

*NOW*

AVAILABLE



**LEVEL ONE TENANTS**

Suite #	Tenant	Total SF
101	Facing East	1,297
102	Farine Bakery & Cafe	5,919

**EXCLUSIVELY LISTED BY**

**MONICA WALLACE**  
 425.753.4121  
 monica.wallace@kidder.com

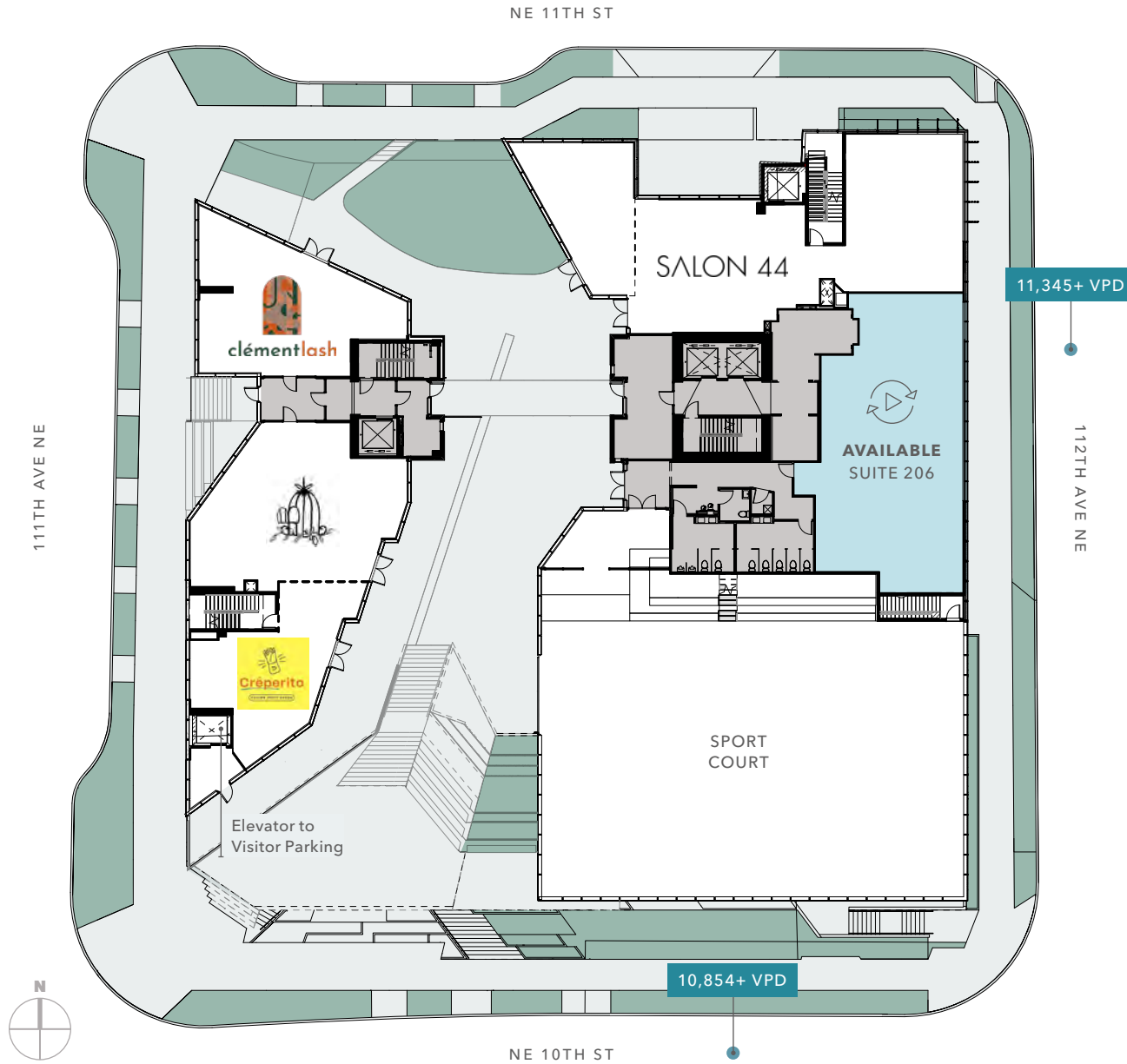

**LEVEL TWO TENANTS**

Suite #	Tenant	Total SF
201	Creperito	971
202	Secret Garden	1,569
203	Clément Lash	1,300
204	Salon 44	735
205	Salon 44	2,443
206	Available	2,416

**EXCLUSIVELY LISTED BY**

**MONICA WALLACE**  
 425.753.4121  
 monica.wallace@kidder.com



# DEMOGRAPHICS

## POPULATION

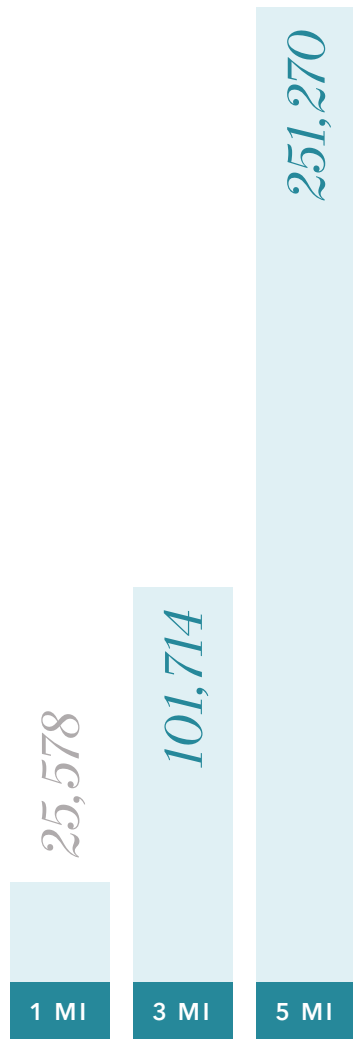

## AVERAGE HOUSEHOLD INCOME

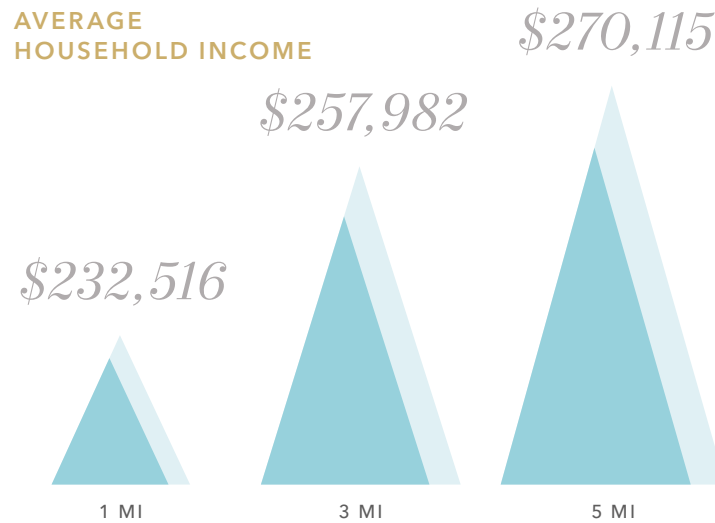

## MEDIAN AGE

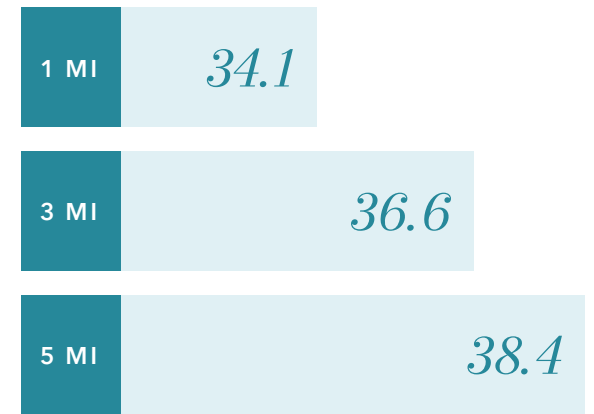

## ESTIMATED HOUSEHOLDS

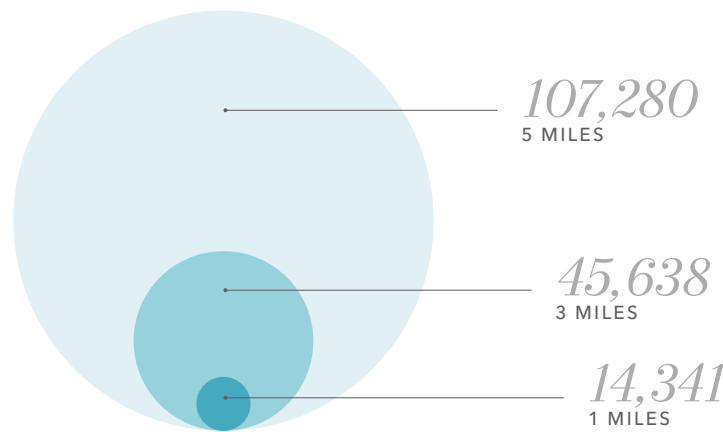

## ESTIMATED EMPLOYEES

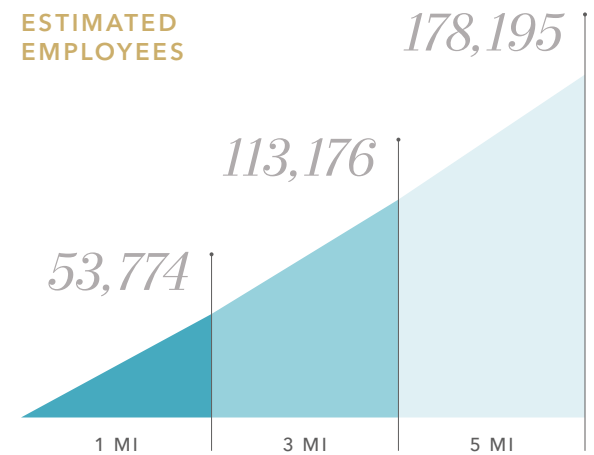

Data Source: ©2024, Sites USA



BRIO

## BRIO COMMERCIAL

*For more information on  
this property, please contact*

MONICA WALLACE

425.753.4121

[monica.wallace@kidderm.com](mailto:monica.wallace@kidderm.com)

[KIDDER.COM](http://KIDDER.COM)

This information supplied herein is from sources we deem reliable. It is provided without any representation, warranty, or guarantee, expressed or implied as to its accuracy. Prospective Buyer or Tenant should conduct an independent investigation and verification of all matters deemed to be material, including, but not limited to, statements of income and expenses. Consult your attorney, accountant, or other professional advisor. All Kidder Mathews designs are the sole property of Kidder Mathews. Branded materials and layouts are not authorized for use by any other firm or person.

