

**16850 WEST
119TH STREET
OLATHE, KS**

**119TH STREET TECH PARK
BUILDING 4**



FEATURES

- Flexible for many uses:
 - office
 - flex
 - lab
 - medical
 - manufacturing
 - call center
- Fully sprinklered building
- Dock-high loading
- 6-8 per 1,000 parking ratio
- Ample power
- UPS system
- Whole building generator
- Divisible
- Excellent access off of I-35 and 119th Street
- Available immediately
- \$12.95/SF NNN



CONTACT DETAILS

✉ JOHN DELZER
jd@karbank.com

✉ PAUL FOGEL, SIOR
pf@karbank.com

☎ 816.221.4488
816.221.4494 fax

🌐 karbank.com

Information furnished regarding property is from sources deemed reliable but no warranty or representation is made as to the accuracy thereof and same is submitted subject to errors, omissions, prior sale or lease or withdrawal without notice.

FIRST FLOOR

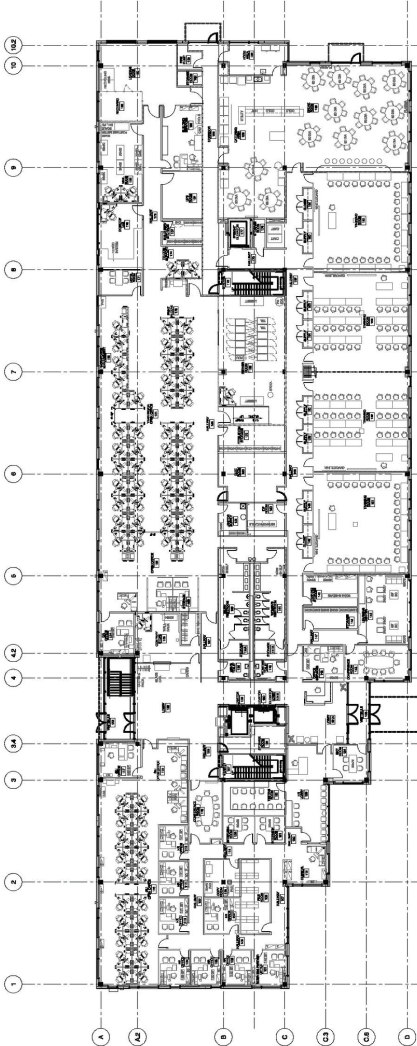

SECOND FLOOR

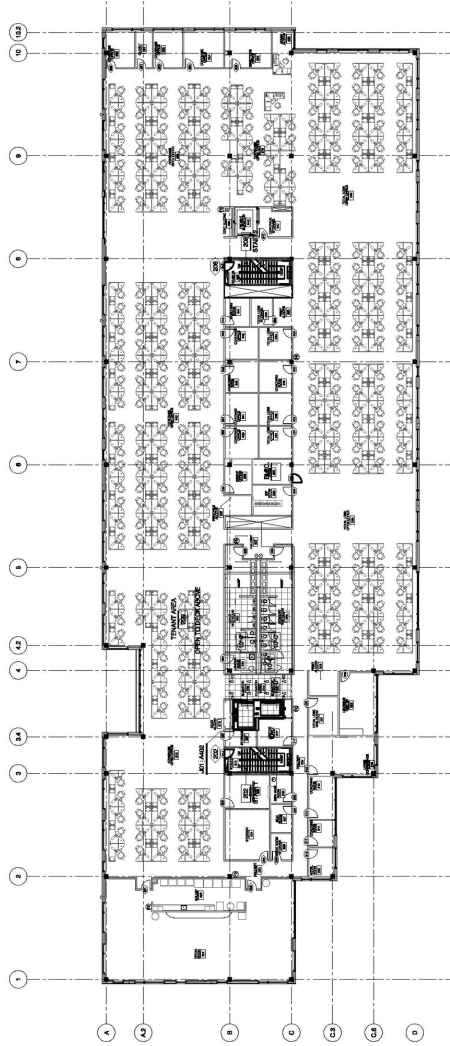

THIRD FLOOR

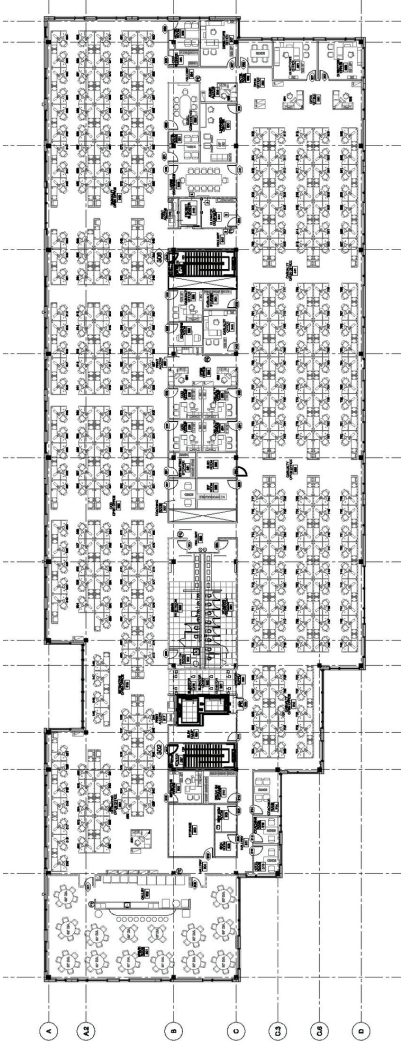

16850 WEST 119TH STREET
OLATHE, KS
119TH STREET TECH PARK BUILDING 4