

# For Lease

Taylor Industrial, 6660 Taylor Dr. | Red Deer, AB



## Demographics *(within 3 km)*



NEIGHBORHOOD  
Red Deer



POPULATION  
36,126



MEDIAN AGE  
37



HOUSEHOLD INCOME  
\$90,956

## Building Details



PARKING  
Ample Surface  
Parking



YEAR BUILT  
2000



TRAFFIC COUNT  
23,000 VPD | 67th Street  
22,000 VPD | Taylor Drive



Unit A210, 9705 Horton Road SW,  
Calgary, Alberta, T2V 2X5  
P (403) 214-2344

[blackstonecommercial.com](http://blackstonecommercial.com)

## First 3 Months FREE on 5 Year Term

### Property Details

	Area	Rent
Unit 104	4,148 SF	Net Rent \$14.00 PSF
Unit 106B	2,858 SF	Net Rent \$13.00 PSF
	Yard Area	Rent/Month
Size Available:	B   3,240 SF	\$ 300/month
	D   16,361 SF	\$1,000/month
	H   6,521 SF	\$ 600/month
	I   6,835 SF	\$ 600/month
	J   13,670 SF	\$ 800/month
	K   7,500 SF	\$ 700/month
Op Costs:	\$5.32 PSF	
Availability:	Immediately	
Zoning:	I1 - Light Industrial	
Power:	200 Amp	
Loading:	Drive-in Overhead	
Ceiling Height:	20'	

### Highlights

- Industrial/showroom space available on Taylor Drive with excellent access and exposure
- FREE Mezzanine space available (approx. 25% of main floor)
- District allows a variety of warehousing, distribution, sales and service business
- Newly renovated
- Large fenced and secure yard space available

# Site Plan

Unit 104 | 4,148 SF

Unit 106B | 2,858 SF

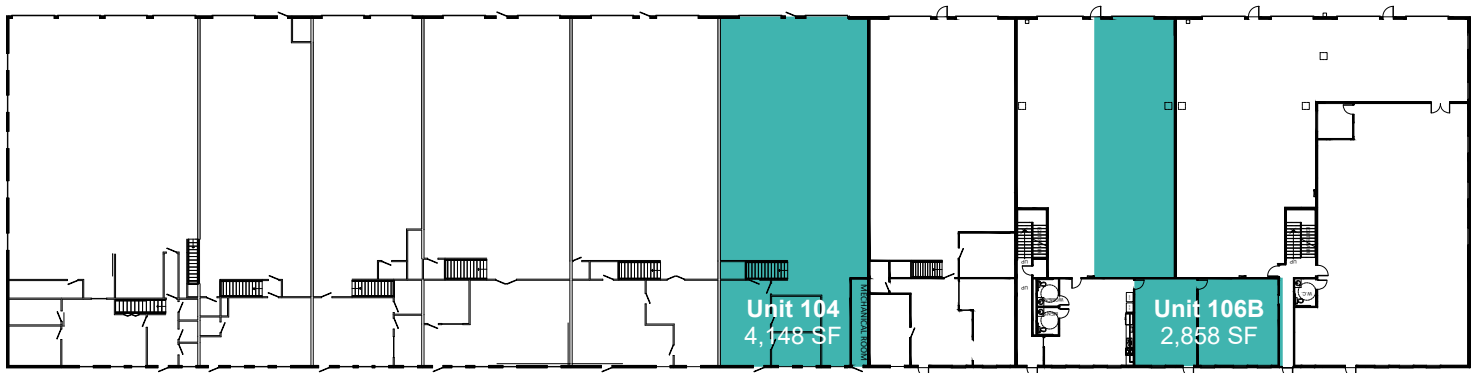





# Thank you for your Interest!

## For More Info.

### Mahmud Rahman

P 403.930.8651

E mrahman@blackstonecommercial.com

### Randy Wiens

P 403.930.8649

E rwiens@blackstonecommercial.com

Unit A210, 9705 Horton Road SW, Calgary, Alberta T2V 2X5 | P (403) 214-2344

This document has been prepared by Blackstone Commercial for advertising and general information only. Although information has been obtained from sources deemed reliable, Blackstone Commercial and / or their representatives, brokers or agents make no guarantees, representations or warranties of any kind, expressed or implied, regarding the information including, but not limited to, warranties of content, accuracy and reliability. Blackstone Commercial excludes unequivocally all inferred or implied terms, conditions and warranties arising out of this document and excludes all liability for loss and damages arising therefrom. © 2024. All rights reserved. This document is the copyrighted property of Blackstone Commercial.

[blackstonecommercial.com](https://blackstonecommercial.com)

Follow us:  
Blackstone  
Commercial



 **Blackstone**  
Commercial Real Estate Services