

Midwest Office Park

7221-7223 Engle Road
Fort Wayne, IN 46804



OFFICE

FOR LEASE

SHELBY WILSON

Broker
260 424 8448
shelby.wilson@sturgespg.com

KEVIN ELLIS

Broker
260 424 8448
kevin.ellis@sturgespg.com



Midwest Office Park

7221-7223 Engle Road
Fort Wayne, IN 46804

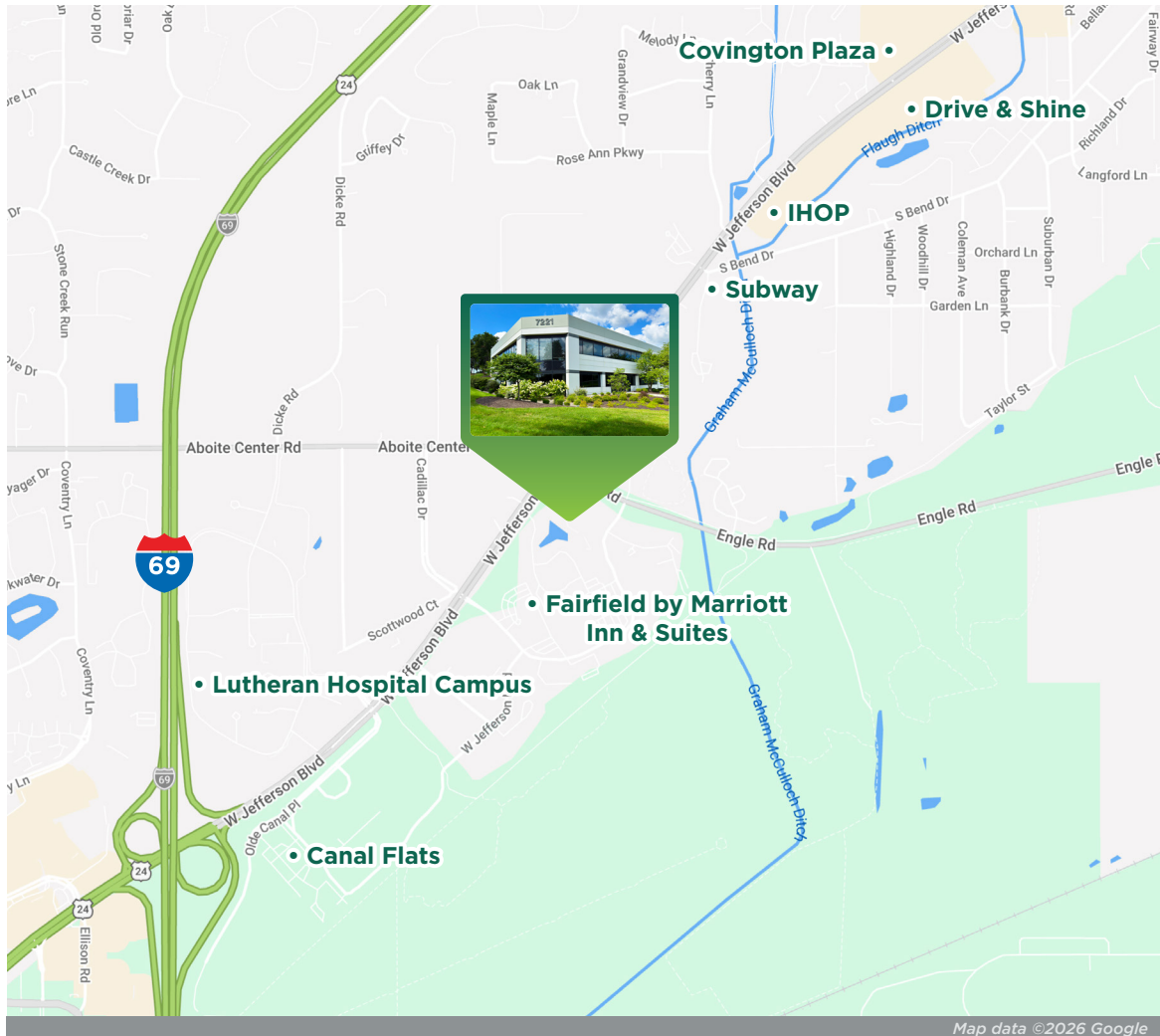

Spectacular Southwest Location

With a remarkable southwest Fort Wayne location less than one mile from Lutheran Hospital and I-69, Midwest Office Park is a fantastic place to take your business to the next level.

- ▶ Located within seven miles of Downtown Fort Wayne and the Fort Wayne International Airport
- ▶ Front door parking on both levels
- ▶ Full-service leases with professional and responsive management

SHELBY WILSON

Broker
260 424 8448
shelby.wilson@sturgespg.com

KEVIN ELLIS

Broker
260 424 8448
kevin.ellis@sturgespg.com

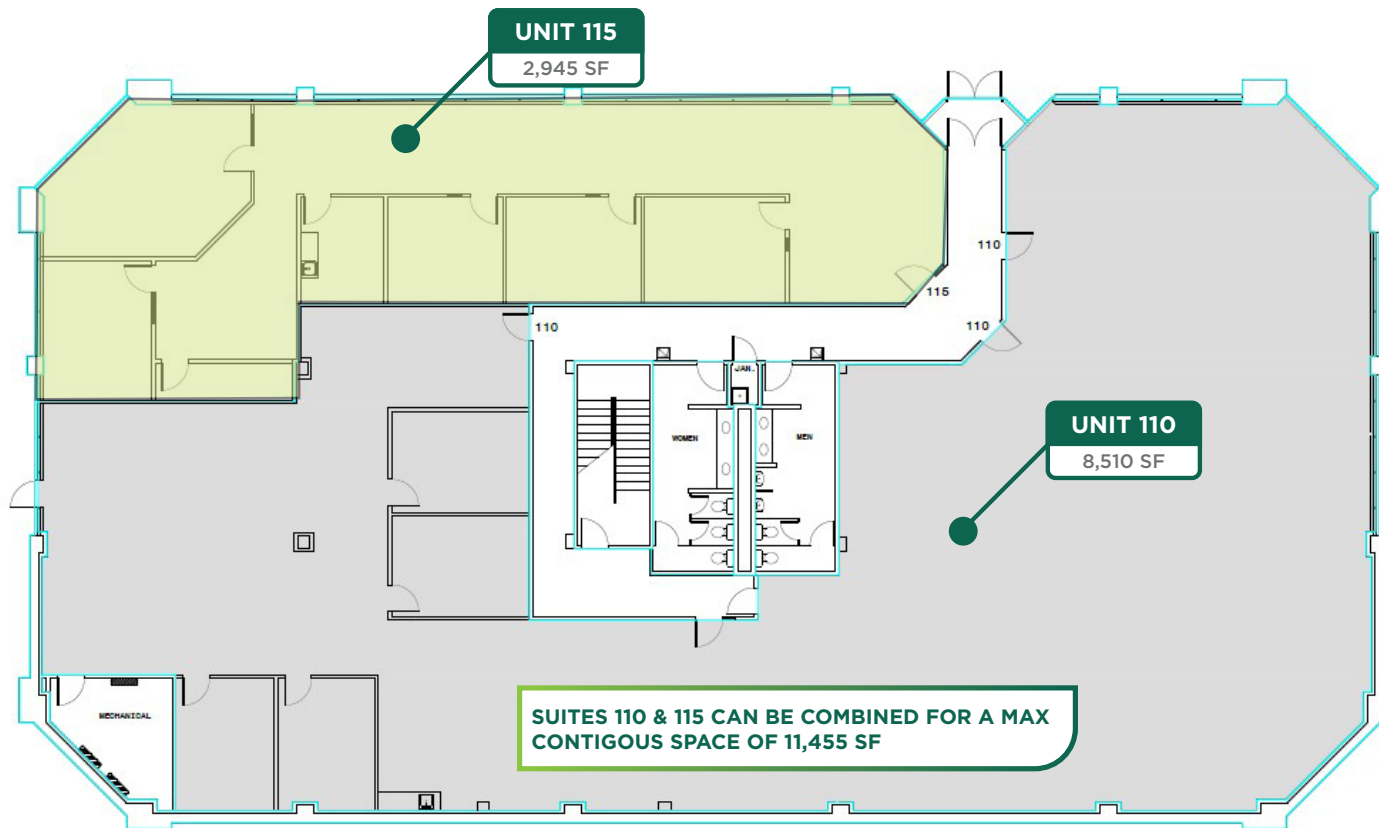
**Midwest Office Park**7221-7223 Engle Road
Fort Wayne, IN 46804**7221 Engle Road**

Floor plans may not be to scale. Contact broker for detailed floor plan.

SHELBY WILSONBroker
260 424 8448
shelby.wilson@sturgespg.com**KEVIN ELLIS**Broker
260 424 8448
kevin.ellis@sturgespg.com



Midwest Office Park

7221-7223 Engle Road
Fort Wayne, IN 46804

7223 Engle Road

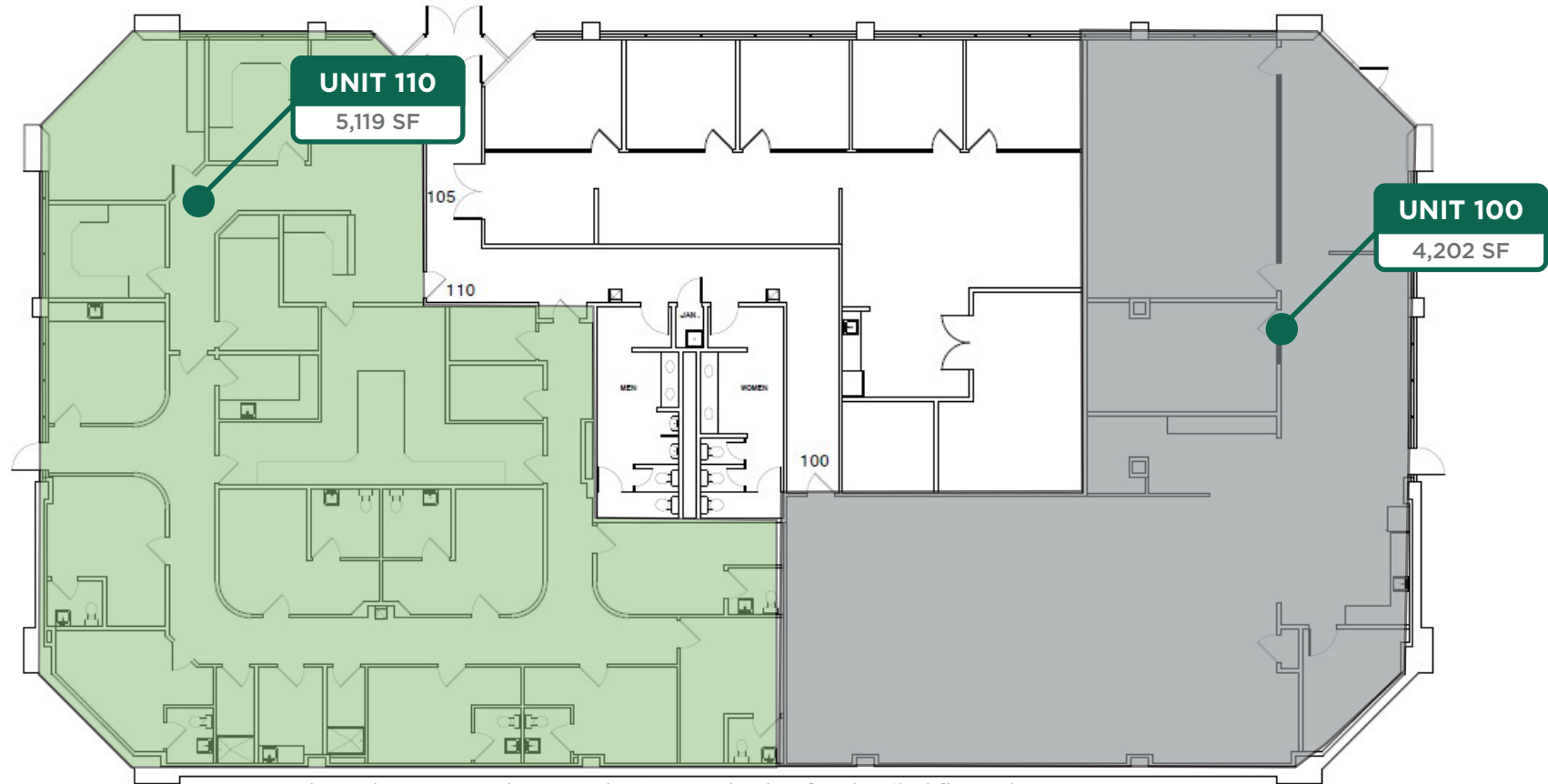

Floor plan may not be to scale. Contact broker for detailed floor plan.

SHELBY WILSON

Broker
260 424 8448
shelby.wilson@sturgespg.com

KEVIN ELLIS

Broker
260 424 8448
kevin.ellis@sturgespg.com

© 2026 Sturges, LLC. This information has been obtained from sources believed reliable. We have not verified it and make no guarantee, warranty, or representation about it. Any projections, opinions, assumptions, or estimates used are for example only and do not represent the current or future performance of the property. You and your advisors should conduct an independent investigation of the property to determine the suitability of the property for your needs. Photos herein are the property of their respective owners and use of these images without the express written consent of the owner is prohibited. Maps used herein are attained via Google Maps and/or Google Earth, and are therefore the property of Google.



Midwest Office Park

7221-7223 Engle Road
Fort Wayne, IN 46804



PROPERTY INFORMATION

Address	7221-7223 Engle Road
City, State, Zip	Fort Wayne, IN 46804
County	Allen
Township	Aboite
Parcel Number	02-11-24-129-008.000-038

SITE DATA

Site Acreage	4.99 AC
Zoning & Description	C1 - Professional Office
Parking Description	Surface on both levels
Parking Ratio	4/1,000 SF

AVAILABLE UNITS

Total Building SF	46,937 SF	
Total Available	20,776 RSF	
Max Contiguous	11,455 RSF	
Units Available	RSF	Rate/Mo
• 7221-Suite 110	8,510	\$13,474.16
• 7221-Suite 115	2,945	\$4,662.91
• 7221-Suites 110 & 115	11,455	\$18,137.08
• 7223- Suite 100	4,202	\$6,653.16
• 7223-Suite 110	5,119	\$8,105.08

BUILDING INFORMATION

Property Type	Multi-tenant office
Year Built	1990
# of Stories	2 (each building)
Construction Type	Concrete
Roof	Flat
Heating	Gas fired unit
A/C	Gas fired unit
Sprinklered	No
Elevators	No
Signage	Tenant directory on monument signage

RESPONSIBLE PARTIES

Utilities	Landlord
Lawn & Snow	Landlord
Property Taxes	Landlord
Property Insurance	Landlord
Maintenance & Repairs	Landlord
Common Area	Landlord
Roof & Structure	Landlord
Janitorial	Landlord

LEASE INFORMATION

Lease Rate & Type	\$19.00/SF/Yr Modified Gross
Terms	5 year minimum
Availability	Immediate

ADDITIONAL INFORMATION

- Professional office space close to major retail and services
- Within one mile of I-69 interchange

UTILITIES

Electric Provider	AEP
Natural Gas Provider	NIPSCO
Water & Sewer Provider	City Utilities
High Speed Data	Frontier Copper/ Comcast Copper

SHELBY WILSON

Broker
260 424 8448
shelby.wilson@sturgespg.com

KEVIN ELLIS

Broker
260 424 8448
kevin.ellis@sturgespg.com