



# CAPITAL REAL ESTATE

COMMERCIAL

713.681.1100 www.cretx.com  
7720 Westview Dr. Houston, TX 77055-5029

**SPEC. WAREHOUSE GPIP LOT 23**  
**3639 PEEK RD.,**  
**KATY, TX 77449**  
**LOT 23 - 2.62 AC**

**BUILDING FOOTPRINT:**  
**5" CONCRETE PAVING**  
**6" CONCRETE PAVING**  
**CRUSHED CONCRETE:**  
**PARKING SPACES:**

**24,600 SF**  
**6,137 SF**  
**13,408 SF**  
**6,235 SF**  
**18**

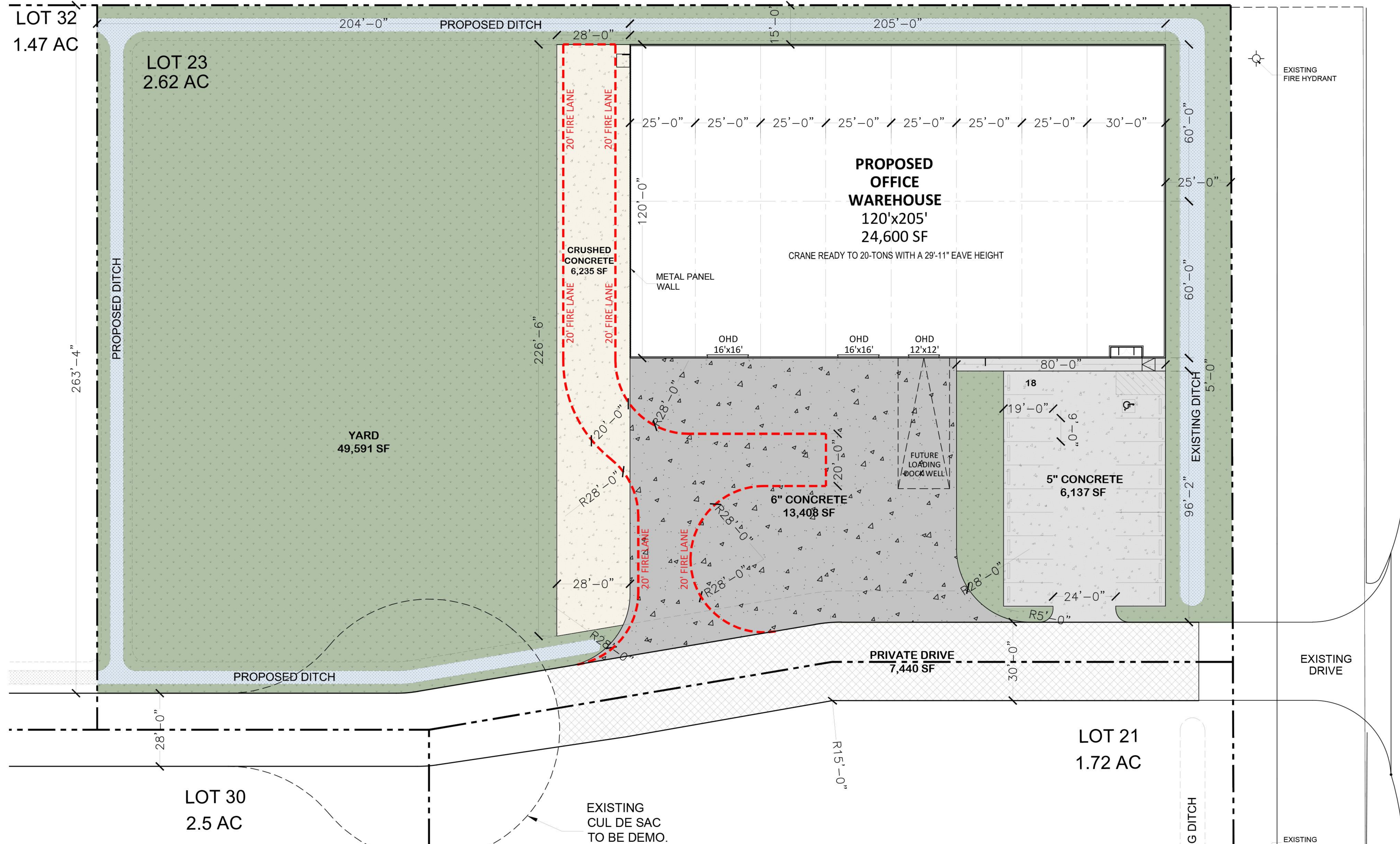

PEEK ROAD

