

6677 SANTA MONICA BLVD LOS ANGELES

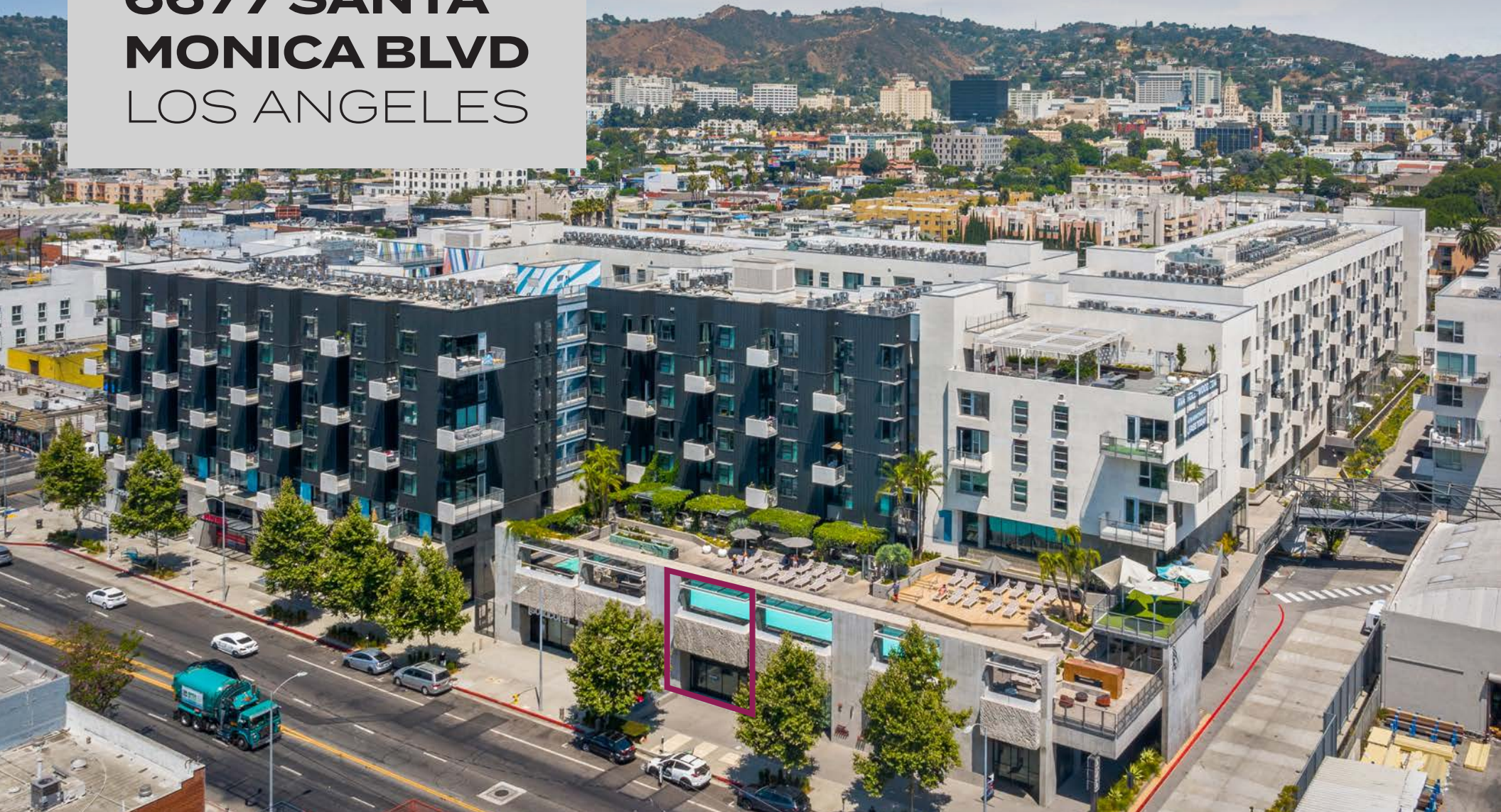

**2ND GENERATION
FITNESS SPACE FOR LEASE**

JOIN

MOTHER'S
CALIFORNIA MARKET

[solidcore]

**STRETCH
LAB**

**STEREO
SCOPE**

JLL

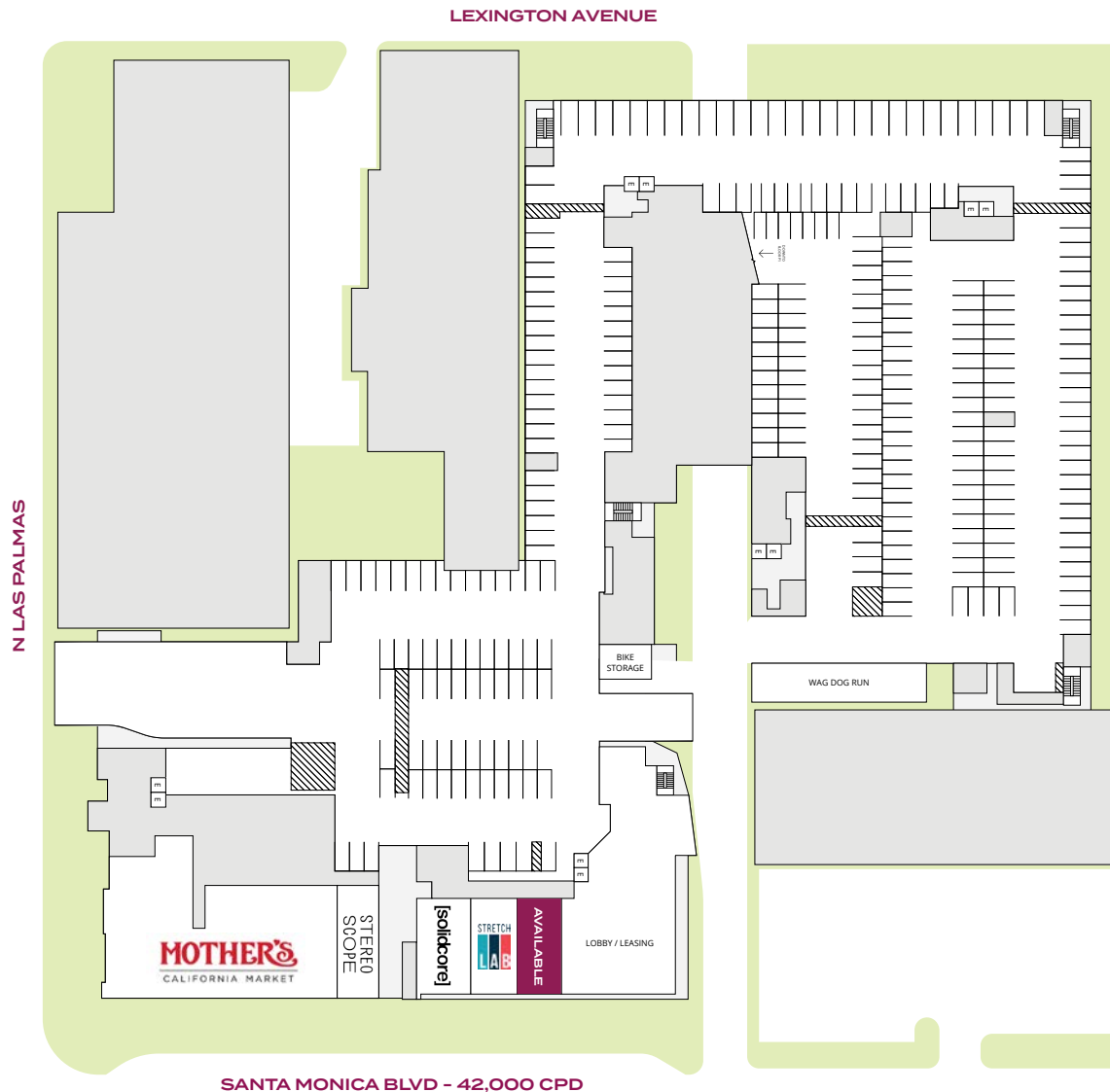

PROJECT HIGHLIGHTS

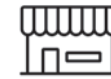

2ND GENERATION FITNESS SPACE

- ▶ ASKING RATE: Available Upon Request
- ▶ HISTORY: Formerly YogaSix
- ▶ SIZE: $\pm 2,406$ SF facing Santa Monica Blvd. (42,000 CPD)
- ▶ PARKING: 125 retail parking spaces
- ▶ NEIGHBORHOOD: Hollywood Media District
- ▶ SITE: AVA Hollywood - 695 luxury apartments above ground floor retail
- ▶ Neighbors include Mother's Market, Stereoscope Coffee, [solidcore] & StretchLab



AREA OVERVIEW



US
101

CAPITOL RECORDS

TCL CHINESE THEATER

SUNSET BLVD

SUNSET BLVD

AVA
HOLLYWOOD

MOTHER'S
CALIFORNIA MARKET

[solidcore]

STRETCH
LAB

STEREO
SCOPE

WEST
HOLLYWOOD
GATEWAY

Mendocino
Farms

BEST
BUY

TARGET

|| pause

SLIGHT
GLASS

JACQUES MARIE MAGE
LOS ANGELES

MIZ
LA
LA

KAISER
PERMANENTE

EX NIHILO
PARIS

NILI LOTAN

TARTINE
BAKERY

SUPERVINYL

SiriusXM

SPROUTS
FARMERS MARKET

HIGHLAND AVE

PETIT TROIS

MELROSE AVE

EREWHON
ORGANIC GROCER & CAFE

NORDSTROM

AMC
THEATRES

THE
GROVE

Apple

MOZZA

MOZZA



HOLLYWOOD

STANDOUT DEMOGRAPHICS WITHIN 3 MILES

\$128,861

Average Household Income

\$918M

Total Retail Spending

36.3

Median Age

71,147

Daytime Population

\$1.53M

Median Home Value

65%

College Degree



MATTHEW FAINCHTEIN

Managing Director
matthew.fainchtein@jll.com
310 430 2548
CA LIC. #01503546

RYAN HAWLEY

Vice President
ryan.hawley@jll.com
213 393 3300
LIC. #02146998



Although information has been obtained from sources deemed reliable, neither Owner nor JLL makes any guarantees, warranties or representations, express or implied, as to the completeness or accuracy as to the information contained herein. Any projections, opinions, assumptions or estimates used are for example only. There may be differences between projected and actual results, and those differences may be material. The Property may be withdrawn without notice. Neither Owner nor JLL accepts any liability for any loss or damage suffered by any party resulting from reliance on this information. If the recipient of this information has signed a confidentiality agreement regarding this matter, this information is subject to the terms of that agreement. ©2025 Jones Lang LaSalle IP, Inc. All rights reserved.