

TLG

COMMERCIAL REAL ESTATE

LAND FOR SALE



# Bradford Hills Retail Pad

## Thomasville Road, Tallahassee, FL 32309

### TREY DESANTIS

Partner/Sales Associate  
850.766.6868  
trey@tlgproperty.com

### TLG REAL ESTATE SERVICES

3520 Thomasville Road, Suite 200  
Tallahassee, FL 32309  
O: 850.385.6363



## EXECUTIVE SUMMARY

## BRADFORD HILLS RETAIL PAD

THOMASVILLE ROAD, TALLAHASSEE, FL 32309

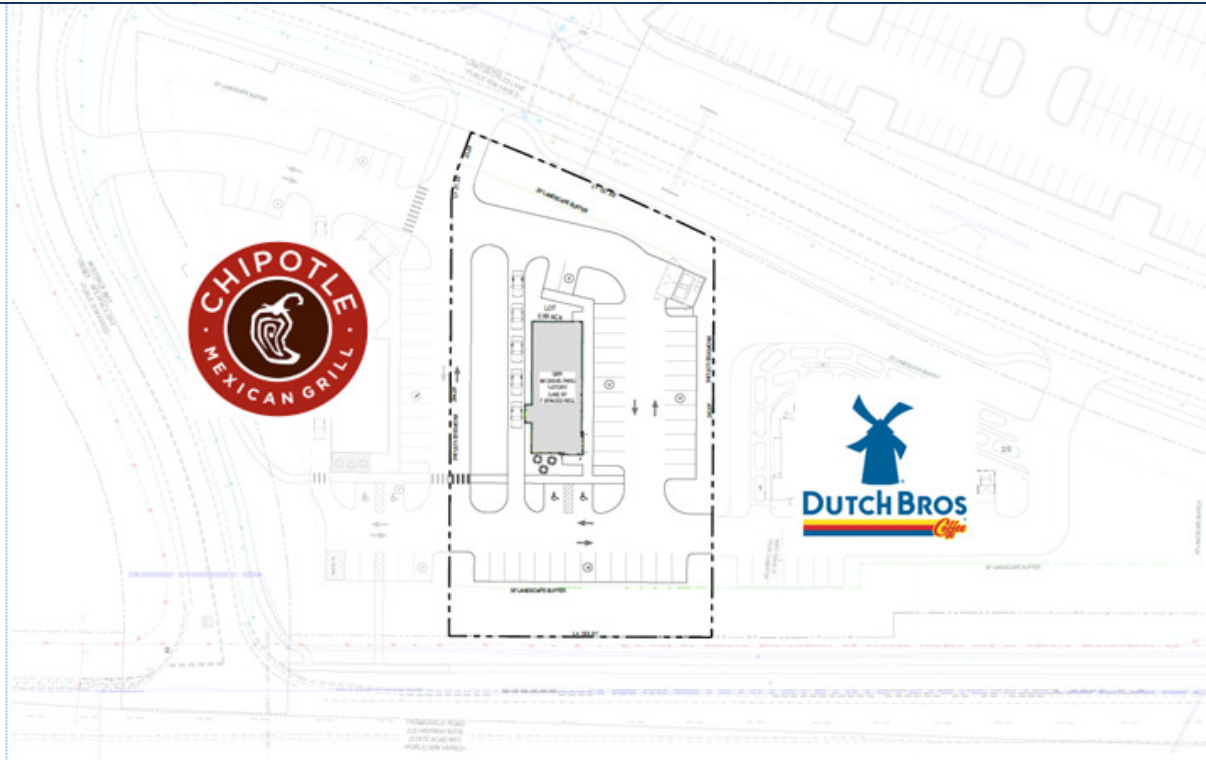

## OFFERING SUMMARY

|                    |             |
|--------------------|-------------|
| <b>Sale Price:</b> | \$1,250,000 |
| <b>Lot Size:</b>   | 0.99 Acres  |
| <b>Zoning:</b>     | BC-1        |

## PROPERTY OVERVIEW

0.99-acre parcel fronting Thomasville Road in Bradfordville (North Tallahassee). These pads are just off of what will be the signalized intersection of Thomasville Road and Rhea Road and located at the entrance to a 155- acre mixed-use project known as Bradford Hills that will consist of The Grove (a luxury apartment complex), a townhome component, 20 plus acres of retail and professional office uses, and a permitted site for a 160-bed assisted living facility. All utilities are to the property lines and offsite stormwater is allocated to the parcels. These parcels are also in front of Lawton Chiles High School, one of the top rated high schools in the State of Florida with over 2,200 students in grades 9-12.

## LOCATION OVERVIEW

This property fronts Thomasville Road (HWY 319) the gateway into Tallahassee from Georgia and beyond and is surrounded by dense high-end residential and commercial uses. Join Publix, Target, Chic-Fil-A, Wendy's Zaxbys, Walgreens and numerous other retail and restaurant uses all in close proximity. Parcel is located in between two other retail pads that are under contract with Chipotle and Dutch Bros Coffee.

**[Click Here for Zoning Information](#)**

**Trey DeSantis**  
850.766.6868  
trey@tlgproperty.com

**TLG REAL ESTATE SERVICES**  
3520 Thomasville Road, Suite 200, Tallahassee, FL 32309  
850.385.6363







ADDITIONAL PHOTOS

# BRADFORD HILLS RETAIL PAD

THOMASVILLE ROAD, TALLAHASSEE, FL 32309

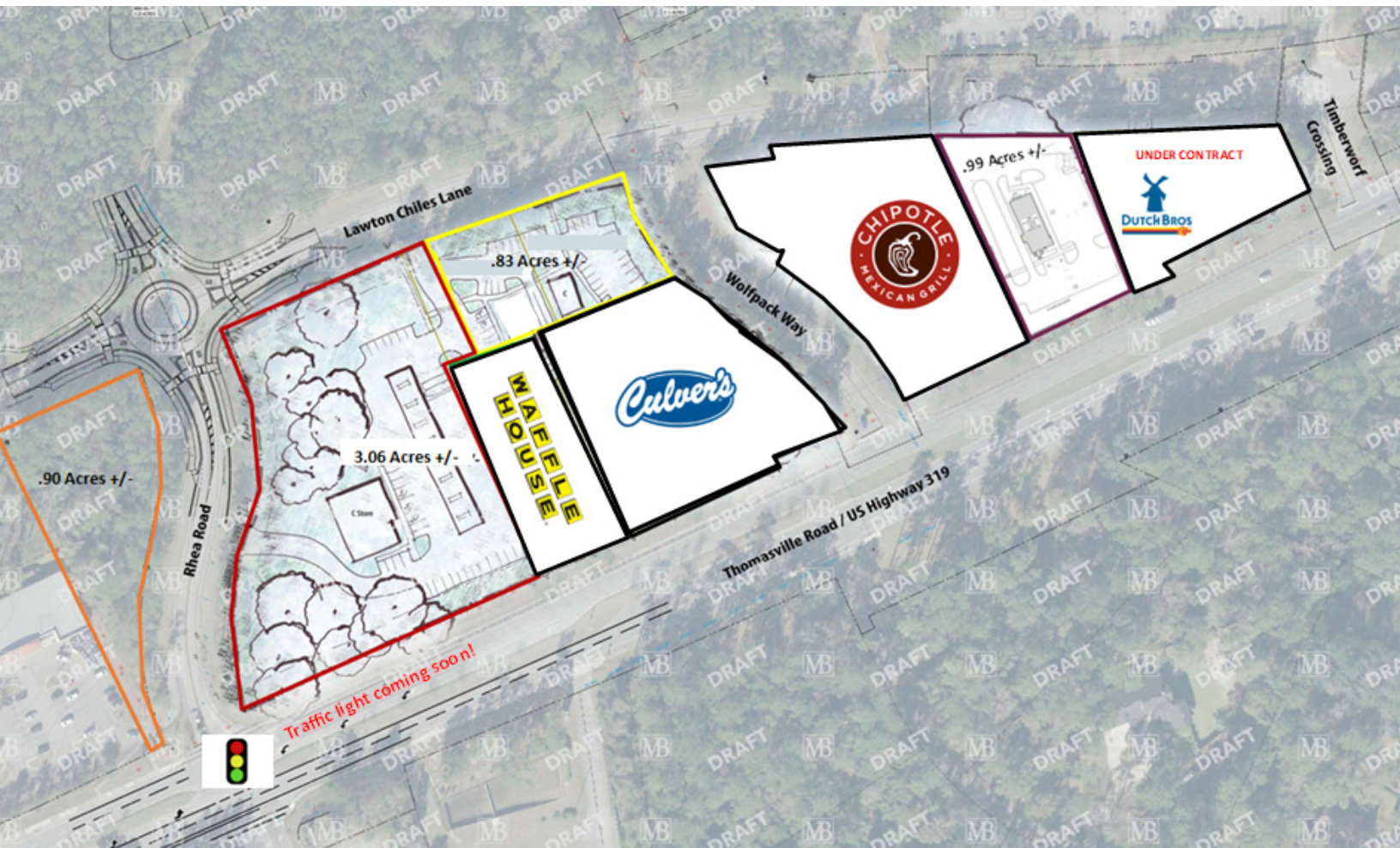

**Trey DeSantis**  
850.766.6868  
trey@tlgproperty.com

**TLG REAL ESTATE SERVICES**  
3520 Thomasville Road, Suite 200, Tallahassee, FL 32309  
850.385.6363







OVERLAY

# BRADFORD HILLS RETAIL PAD

THOMASVILLE ROAD, TALLAHASSEE, FL 32309



**Trey DeSantis**  
850.766.6868  
trey@tlgproperty.com

**TLG REAL ESTATE SERVICES**  
3520 Thomasville Road, Suite 200, Tallahassee, FL 32309  
850.385.6363







SITE PLAN

# BRADFORD HILLS RETAIL PAD

THOMASVILLE ROAD, TALLAHASSEE, FL 32309



**Phase 1 of The Grove is officially complete and tenants have begun moving in!**

**Trey DeSantis**  
850.766.6868  
trey@tlgproperty.com

**TLG REAL ESTATE SERVICES**  
3520 Thomasville Road, Suite 200, Tallahassee, FL 32309  
850.385.6363







RETAILER MAP

## BRADFORD HILLS RETAIL PAD

THOMASVILLE ROAD, TALLAHASSEE, FL 32309



Trey DeSantis  
850.766.6868  
trey@tlgproperty.com

TLG REAL ESTATE SERVICES

3520 Thomasville Road, Suite 200, Tallahassee, FL 32309

850.385.6363



This information has been obtained from sources believed reliable. We have not verified it and make no guarantee, warranty or representation about it. Any projections, opinions, assumptions or estimates used are for example only and do not represent the current or future performance of the property. You and your advisors should conduct a careful, independent investigation of the property to determine to your satisfaction the suitability of the property for your needs. Photos herein are the property of their respective owners and use of these images without the express written content of the owner is prohibited.





## DEMOGRAPHICS MAP

## BRADFORD HILLS RETAIL PAD

THOMASVILLE ROAD, TALLAHASSEE, FL 32309

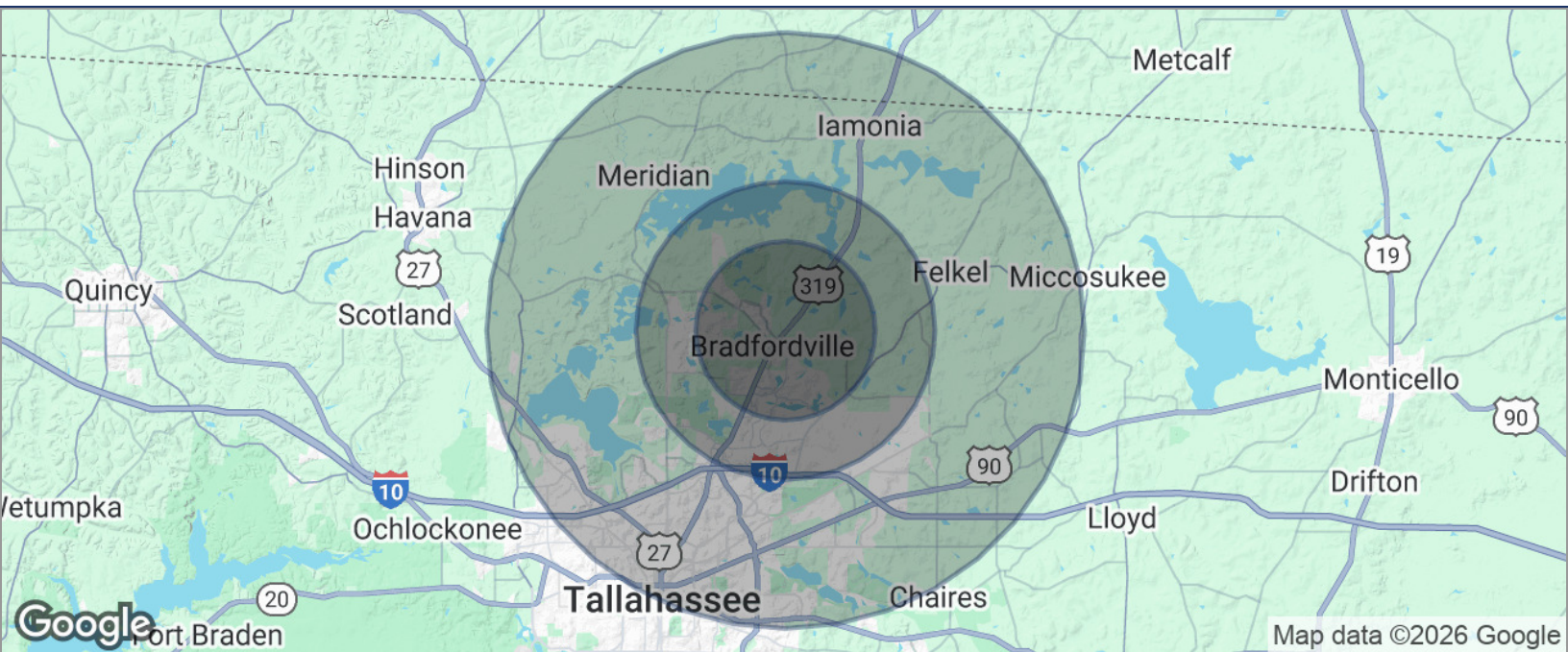

| POPULATION          | 3 MILES   | 5 MILES   | 10 MILES  |
|---------------------|-----------|-----------|-----------|
| TOTAL POPULATION    | 23,283    | 46,396    | 168,396   |
| MEDIAN AGE          | 42.0      | 42.2      | 39.2      |
| MEDIAN AGE (MALE)   | 42.1      | 41.2      | 37.5      |
| MEDIAN AGE (FEMALE) | 42.6      | 43.2      | 40.7      |
| HOUSEHOLDS & INCOME | 3 MILES   | 5 MILES   | 10 MILES  |
| TOTAL HOUSEHOLDS    | 9,227     | 18,505    | 75,438    |
| # OF PERSONS PER HH | 2.5       | 2.5       | 2.2       |
| AVERAGE HH INCOME   | \$119,339 | \$117,147 | \$84,877  |
| AVERAGE HOUSE VALUE | \$296,464 | \$297,695 | \$236,533 |

\* Demographic data derived from 2020 ACS - US Census

Trey DeSantis  
850.766.6868  
trey@tlgproperty.com

TLG REAL ESTATE SERVICES  
3520 Thomasville Road, Suite 200, Tallahassee, FL 32309  
850.385.6363

