

SUBLEASE / DIRECT

Dadeland Centre I

9155 S Dadeland Blvd | Miami, FL 33156

Sublease Space

5,052 SF

Asking Rent

\$53.00/ SF Gross

Base Year 2025

Available

09/01/2025

Lease Expiration

Flexible

Positioned at the Heart of Miami's Premier Business District, **Dadeland Centre I** offers an unmatched blend of accessibility, visibility, and prestige. This Class A office building is located in the thriving Dadeland submarket, just steps from world-class retail at Dadeland Mall and premier dining options. With immediate access to US-1 and the Palmetto Expressway, and just minutes from the Metrorail and Miami International Airport, **Dadeland Centre I** is perfectly situated for both local and regional connectivity.

Dadeland Centre I delivers a modern, professional environment ideal for high-performing companies seeking a dynamic business setting. Tenants benefit from on-site amenities, structured parking, 24/7 security, and well-maintained common areas. The property also offers flexible floor plates to accommodate a wide range of business needs—from boutique firms to national corporations—making it a premier choice for companies aiming to elevate their brand presence in South Florida.

Floor Plan | Suite 1708: ±5,052 SF

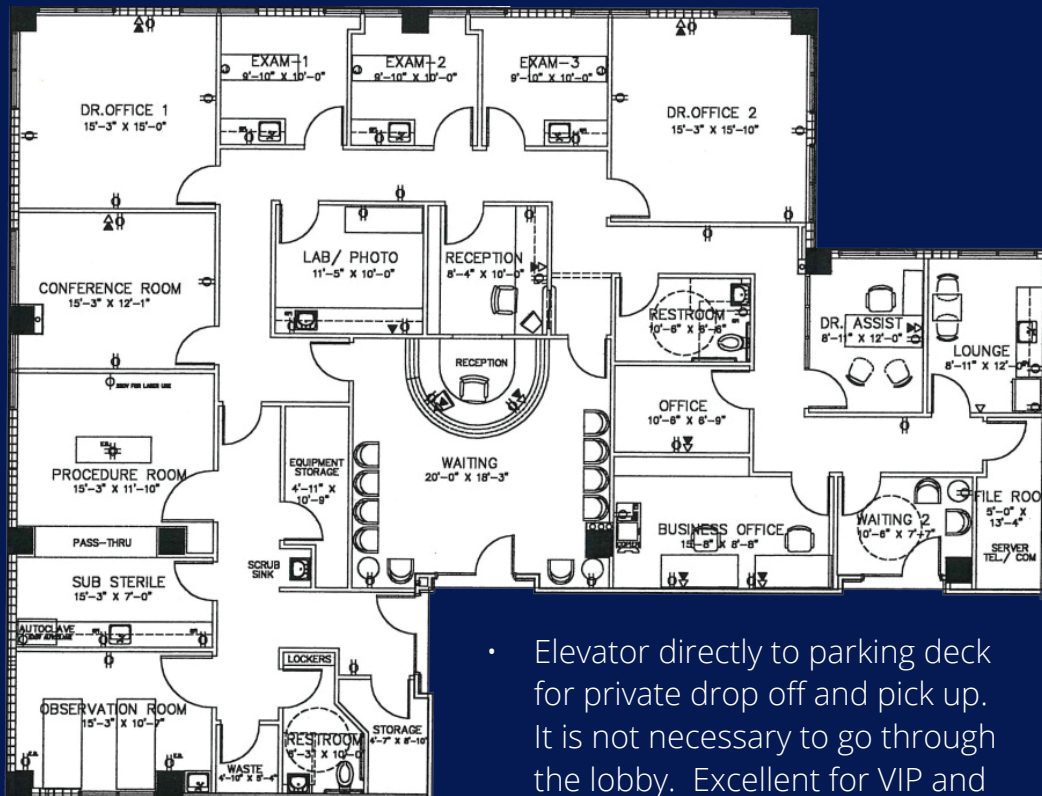

Suite Features:

- **Rare turnkey medical space**
- 1 operating room, a reception area, 3 exam rooms, 2 large doctors' offices, break room, lab, imaging room, recovery bed room for up to two patients, and shower area
- Currently used as a plastic surgery and aesthetics center

- Elevator directly to parking deck for private drop off and pick up. It is not necessary to go through the lobby. Excellent for VIP and discreet clientele.

Location Overview

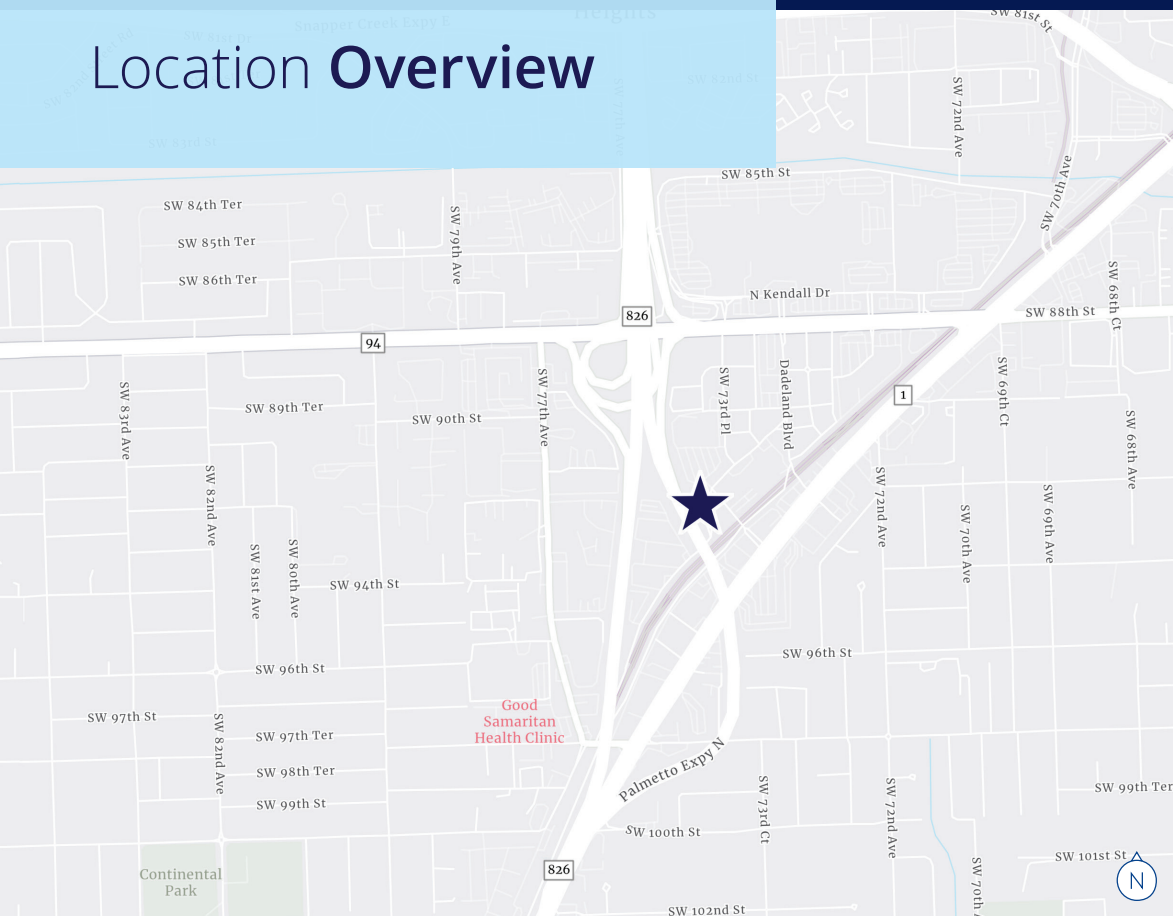

CONTACT US

Alexander Brown

Senior Vice President

+1 954 652 4632

alexander.brown@colliers.com



Colliers International Florida, LLC
200 E Broward Blvd, Suite 120
Fort Lauderdale, FL 33301

Copyright © 2025 Colliers International Florida, LLC. The information contained herein has been obtained from sources deemed reliable. While every reasonable effort has been made to ensure its accuracy, we cannot guarantee it. No responsibility is assumed for any inaccuracies. Readers are encouraged to consult their professional advisors prior to acting on any of the material contained in this report.