

Orlando MSA - Florida Turnpike Industrial Outdoor Storage & Truck Parking

Direct Access US Hwy 27 - Lake County, FL

20731 US HWY 27
Groveland, FL 34736
[Google Maps](#)

1.0 - 9.23 AC OF INDUSTRIAL OUTDOOR STORAGE SPACE | AVAILABLE Q1 2025



Industrial Outdoor Storage & Truck Parking

20731 US HWY 27 Groveland, FL 34736



Outdoor Storage & Truck Parking

Prime Location on US HWY 27 - Gateway to Central Florida

Located adjacent to Christopher C. Ford Commerce Park in Groveland, Florida, this prime industrial development site offers excellent visibility and access with significant frontage on US Highway 27. Zoned for light industrial use it provides optimal conditions for outdoor storage and truck parking. The strategic location ensures quick access to Florida's Turnpike, State Road 50, and State Road 19, enhancing logistical and operational efficiency for efficient freight transport throughout Central Florida, including Orlando, Ocala, and Gainesville.

LEASABLE SPACE	1.0 - 9.23 AC
PARKING	Up to 250+ Semi Truck, Trailer Spaces. 12ftx70ft
SURFACE	Gravel Surface with highly engineered, stable sub-base
SECURITY	Secured, Fully Gated 24/7 Video Monitored
LIGHTING	New site lighting

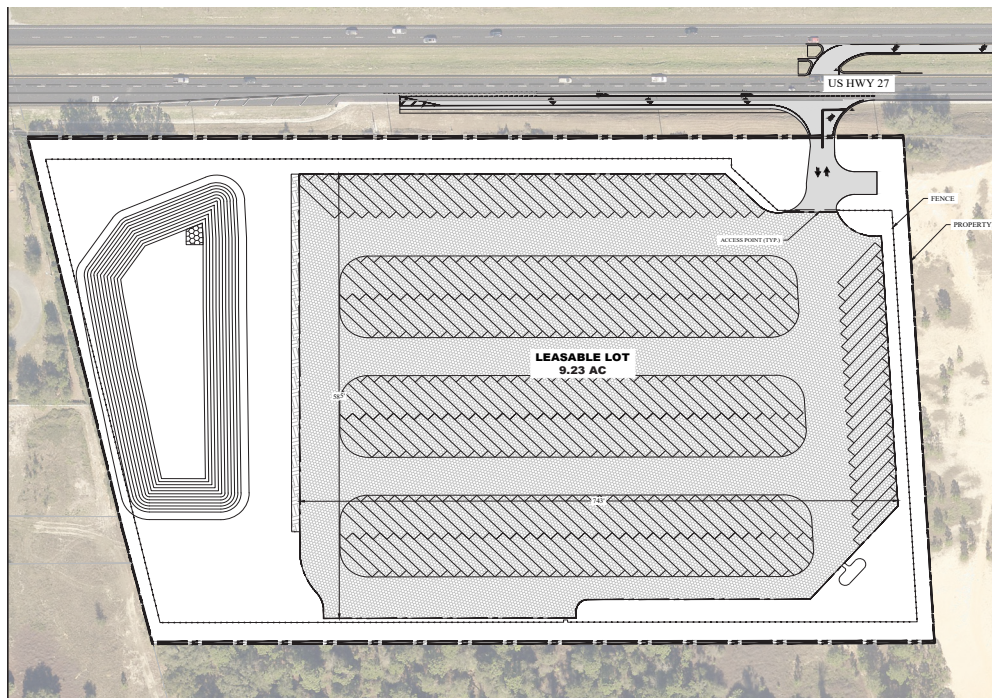

2024 DEMOGRAPHICS	10 MILE RADIUS	30 MILE RADIUS
TOTAL POPULATION	132,024	1,801,119
DAYTIME WORKERS	34,271	971,367
DAYTIME POPULATION	120,425	,019,457
TOTAL HOUSEHOLDS	52,156	716,188
AVERAGE HOUSEHOLD INCOME	\$83,687	\$82,573
TOTAL BUSINESSES	3,918	86,501

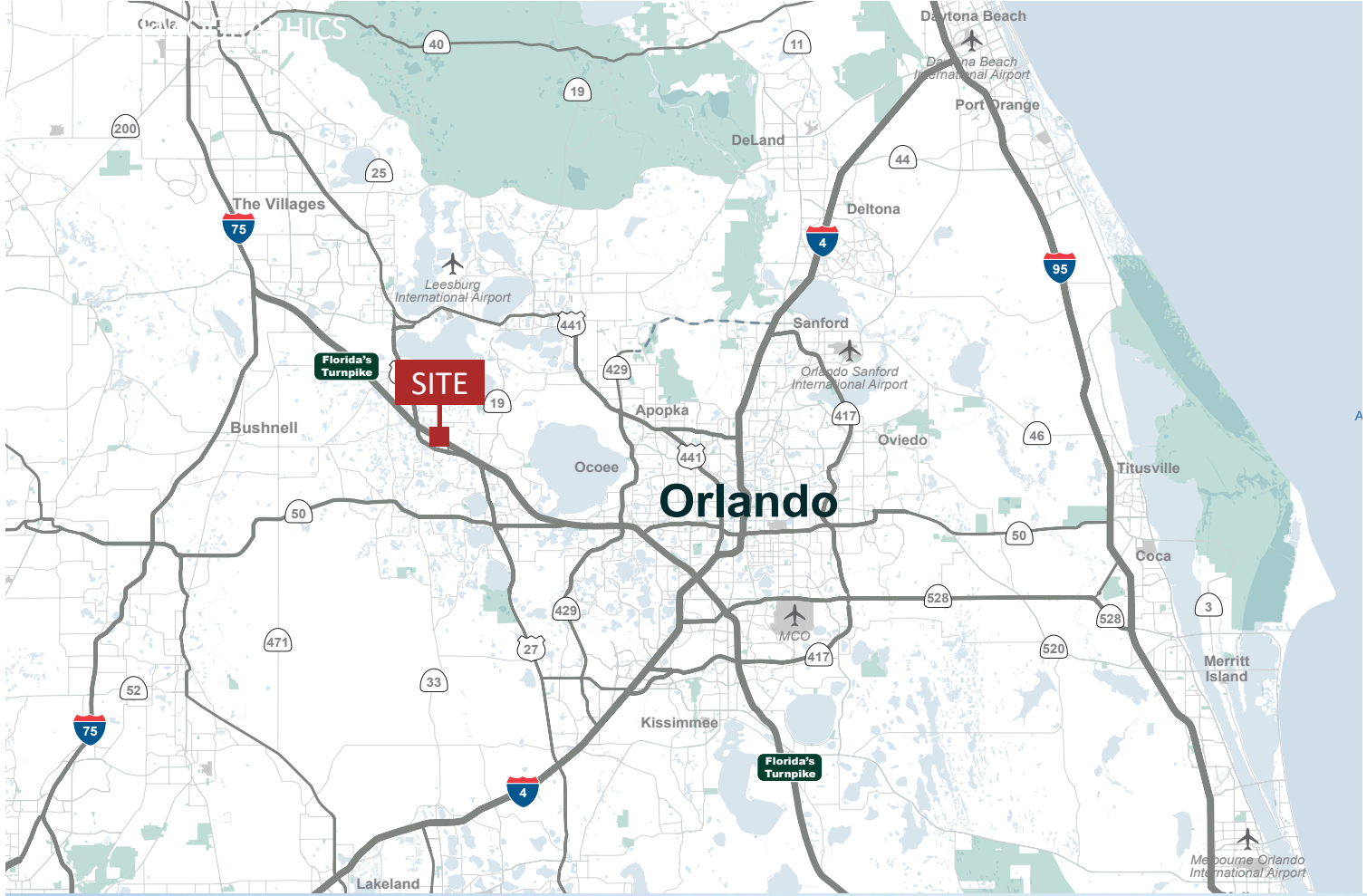
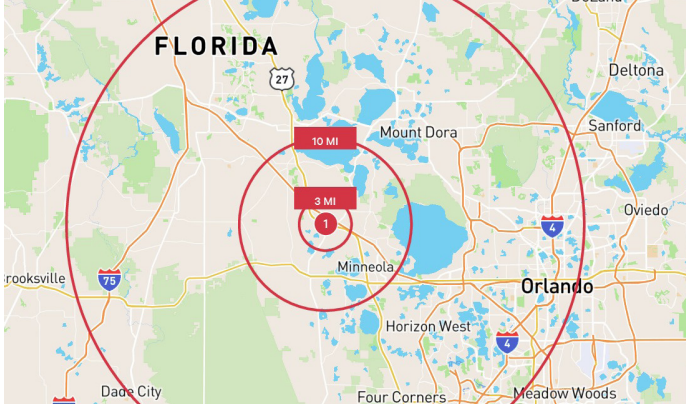

Industrial Outdoor Storage & Truck Parking

20731 US HWY 27 Groveland, FL 34736

Industrial | For Lease

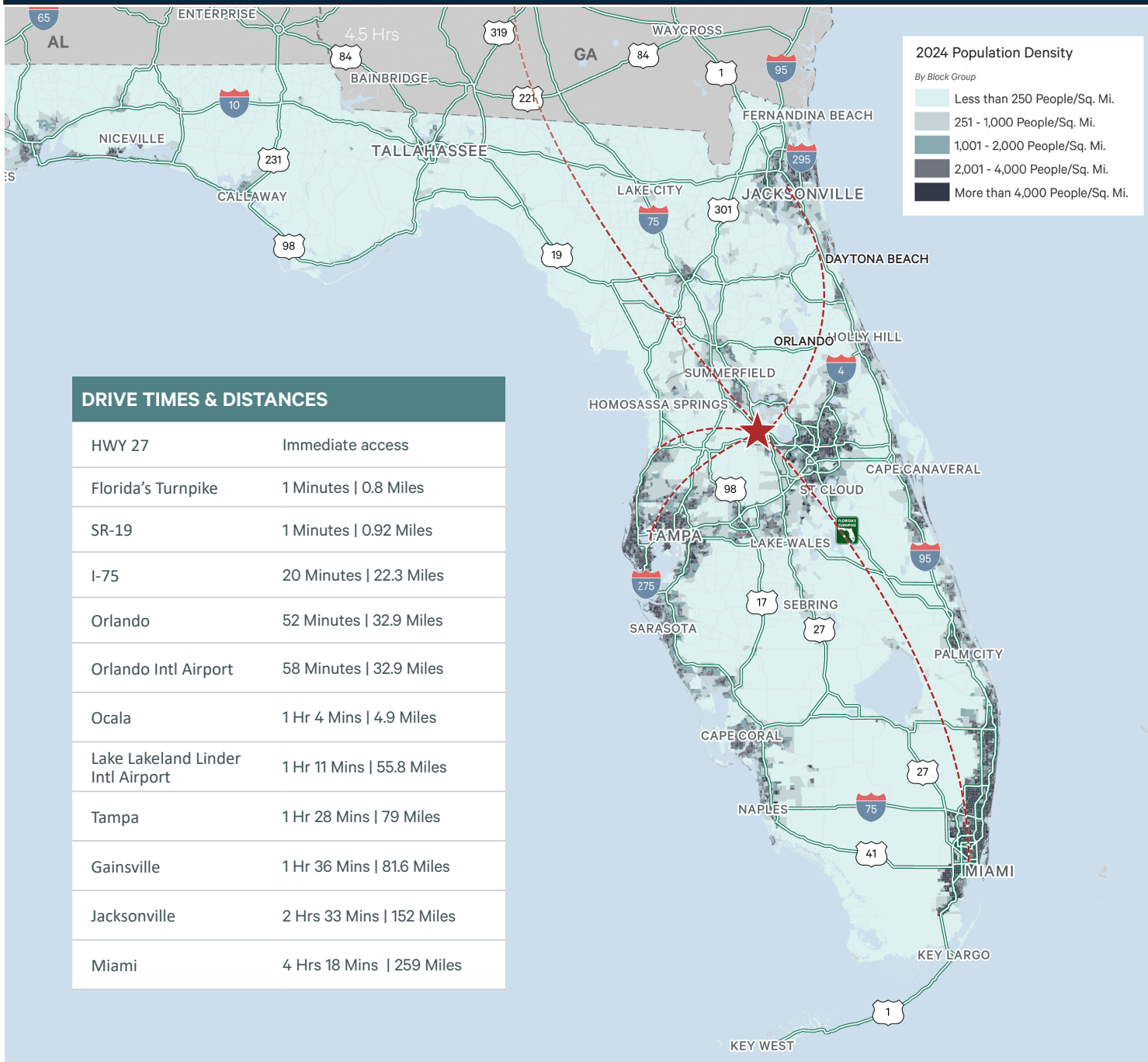

Contact Us

David Murphy

Vice Chairman
+1 407 404 5020
david.murphy@cbre.com

Monica Wonus

Senior Vice President
+1 407 404 5042
monica.wonus@cbre.com

Gaby Gissy

Associate
+1 407 404 5012
gaby.gissy@cbre.com

Lee Earle

Client Services Specialist
+1 407 404 5095
lee.earle@cbre.com

© 2024 CBRE, Inc. All rights reserved. This information has been obtained from sources believed reliable but has not been verified for accuracy or completeness. CBRE, Inc. makes no guarantee, representation or warranty and accepts no responsibility or liability as to the accuracy, completeness, or reliability of the information contained herein. You should conduct a careful, independent investigation of the property and verify all information. Any reliance on this information is solely at your own risk. CBRE and the CBRE logo are service marks of CBRE, Inc. All other marks displayed on this document are the property of their respective owners, and the use of such marks does not imply any affiliation with or endorsement of CBRE. Photos herein are the property of their respective owners. Use of these images without the express written consent of the owner is prohibited.

www.cbre.com/people/david-murphy