

Industrial | For Sublease or Assignment

CBRE

# 362 Industrial Park Drive NE

Lawrenceville, Georgia 30046

±14,000 – 228,560 SF Available





**362 Industrial Park Drive NE**  
Lawrenceville, Georgia 30046

**For Sublease or Assignment**

# Property Features

- + ±14,000 - 228,560 SF
- + 20' - 27' Clear Height
- + Sprinklered
- + 11 Docks
  - including 8 pit levelers and 1 oversized door
- + 4 Drive Ins
- + 1 Van High Door
- + LED Lighting Throughout
- + Gym with Lockers and Showers
- + Numerous Ventilation & HVLS Fans
- + Fenced
- + Flexible sublease terms available
- + Large Class A Showroom/Office
  - Executives offices with wet bars, bathrooms & showers
  - Koi pond
  - Multiple break rooms
  - 17 private offices
  - 5 conference rooms
  - Multiple open areas with HVAC for office, showroom and R&D
- + Manufacturing features:
  - Machine Shop
  - 6 cranes
  - Paint booth
  - Wash station with drains and drying oven
  - Water treatment pit
  - Sand blasting room
- + Includes auxiliary building
  - ± 14,000 SF
  - 1 dock, 3 drive ins
  - 2 bathrooms





362 Industrial Park Drive NE  
Lawrenceville, Georgia 30046

For Sublease or Assignment





362 Industrial Park Drive NE  
Lawrenceville, Georgia 30046

For Sublease or Assignment

# Building Plan

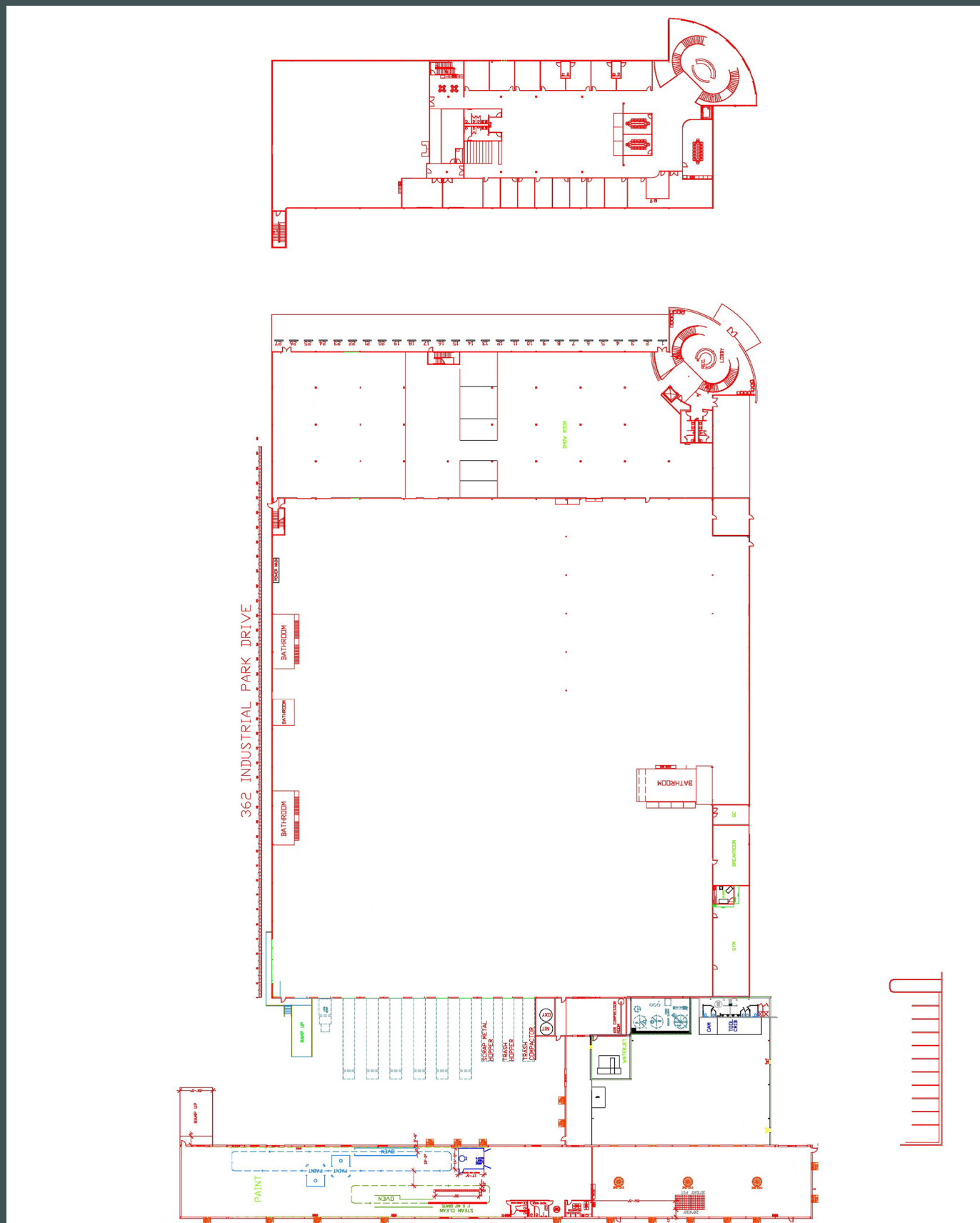

362 Industrial Park Drive NE  
Lawrenceville, Georgia 30046

For Sublease or Assignment

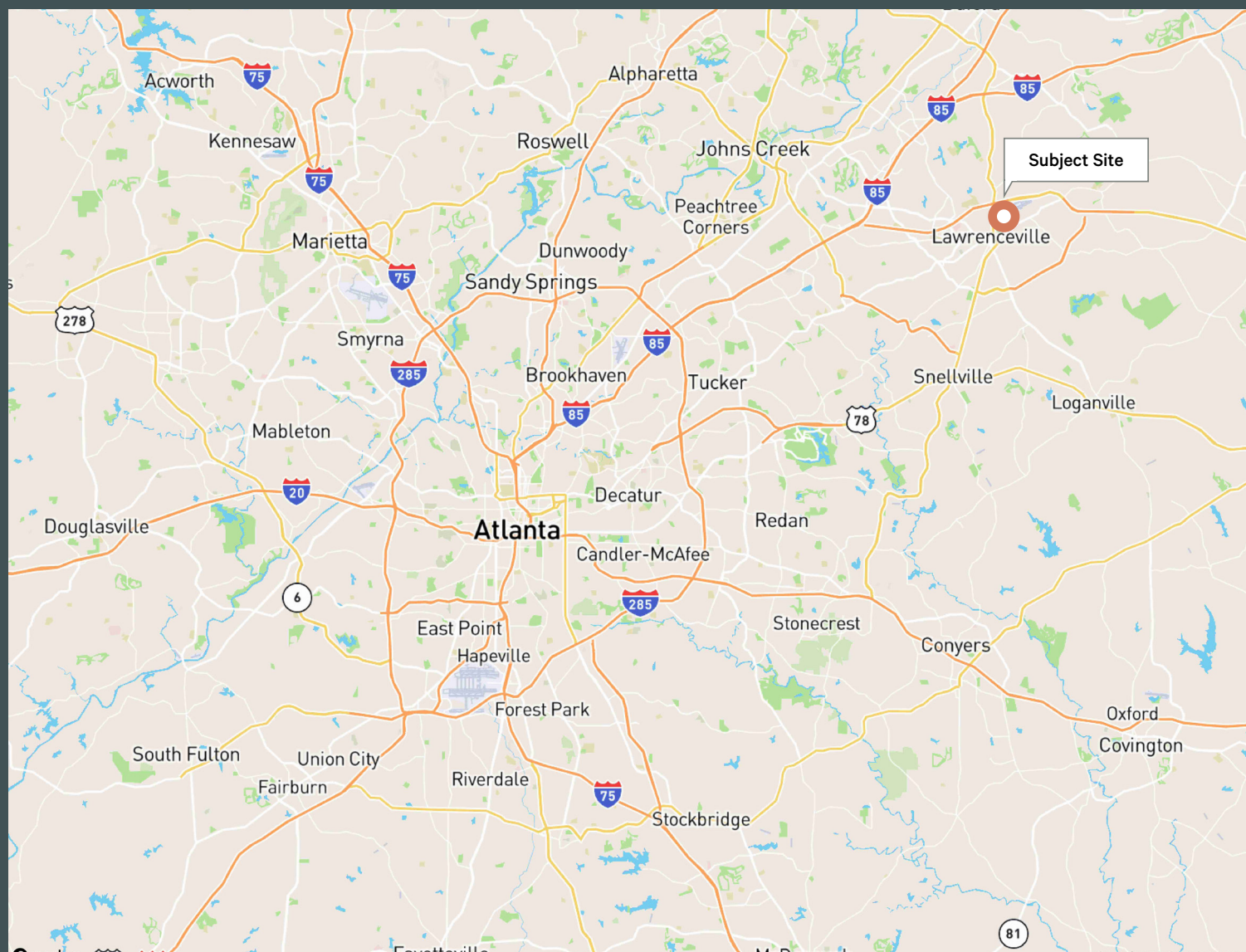

## Contact Us

**Rob Kruer**

First Vice President  
+1 770 363 5240  
[rob.kruer@cbre.com](mailto:rob.kruer@cbre.com)

**CBRE, Inc.**

+1 404 504 7900

© 2024 CBRE, Inc. All rights reserved. This information has been obtained from sources believed reliable, but has not been verified for accuracy or completeness. You should conduct a careful, independent investigation of the property and verify all information. Any reliance on this information is solely at your own risk. CBRE and the CBRE logo are service marks of CBRE, Inc. All other marks displayed on this document are the property of their respective owners, and the use of such logos does not imply any affiliation with or endorsement of CBRE. Photos herein are the property of their respective owners. Use of these images without the express written consent of the owner is prohibited.

[www.cbre.com/atlanta](http://www.cbre.com/atlanta)

**CBRE**