

INDUSTRIAL
BUILDING
FOR SALE
OR LEASE

TRANSWESTERN
REAL ESTATE
SERVICES

24450 INDOPLEX CIR

Farmington Hills, MI 48335

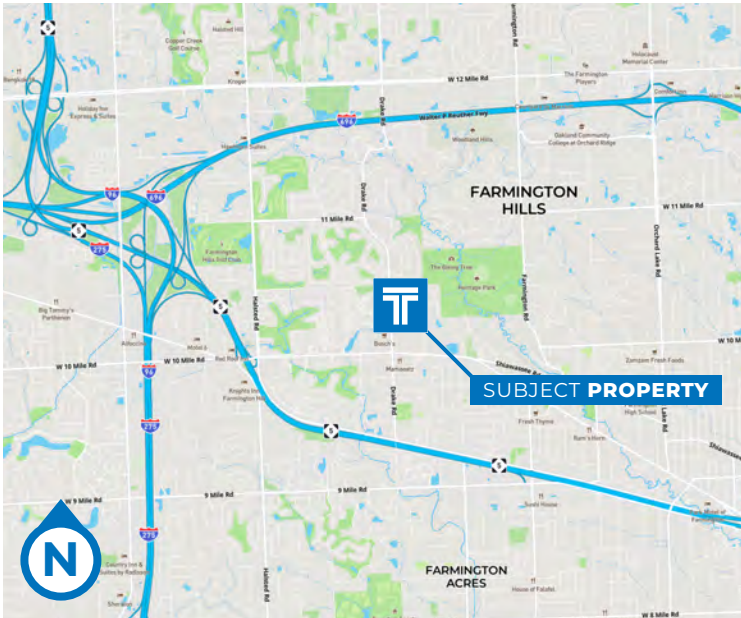

PROPERTY SPECIFICATIONS

- **BUILDING SIZE:** ±28,641 SF
- **LAND:** ±1.51 AC
- **OFFICE:** ±3,641 SF and ±1,500 SF SECOND FLOOR
- **WAREHOUSE:** ±25,000 SF
- **CEILING:** TBD
- **LOADING:** 1 DOCK / 3 OVERHEAD DOORS
- **CRANES:** (2) 7.5 TON CRANES
- **POWER:** 1000 AMPS 240V
- **SPRINKLERS:** YES
- **PARKING:** AMPLE
- **YEAR BUILT:** 1973
- **PARCEL NO. (APN):** 22-23-21-303-025
- **RE TAXES (2022):** \$19,208 / \$0.71 PSF
- **BACKUP POWER:** FULL BUILDING GENERAC GENERATOR
- **LEASE RATE:** **CALL FOR PRICING**
- **SALE PRICE:** **CALL FOR PRICING**

Charles Howard
Senior Vice President
(248) 821-7722
charles.howard@transwestern.com

The information provided herein was obtained from sources believed reliable; however, Transwestern makes no guarantees, warranties or representations as to the completeness of accuracy thereof. The presentation of this property is submitted subject to errors, omissions, change of price or conditions, prior to sale or lease, or withdrawal without notice. Copyright © 2023 Transwestern.

INDUSTRIAL
BUILDING
FOR SALE
OR LEASE

TRANSWESTERN
REAL ESTATE
SERVICES

24450 INDOPLEX CIR

Farmington Hills, MI 48335



Charles Howard
Senior Vice President
(248) 821-7722
charles.howard@transwestern.com

The information provided herein was obtained from sources believed reliable; however, Transwestern makes no guarantees, warranties or representations as to the completeness of accuracy thereof. The presentation of this property is submitted subject to errors, omissions, change of price or conditions, prior to sale or lease, or withdrawal without notice. Copyright © 2023 Transwestern.