









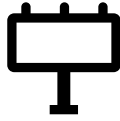

89 Plaistow Road • Five Corners Shopping Center • Haverhill, MA



6,500 SF • 2nd Generation Restaurant • 232 Seats • Built Out For Hibachi • **For Lease**



| | | | |
|---|--|--|---|
|  <p>Formerly Kobe Steakhouse & Sushi</p> <p>6,500 SF</p> |  <p>232 Seats</p> |  <p>Pylon Signage</p> |  |
| <p>Co-Tenants:</p>      |  <p>Available Now</p> |  <p>Located on Route 125 MA/NH Border</p> <p>25K Cars/Day</p> | |



PHOTOS



89 PLAISTOW ROAD / ROUTE 125 • HAVERHILL, MA



FLOOR PLAN

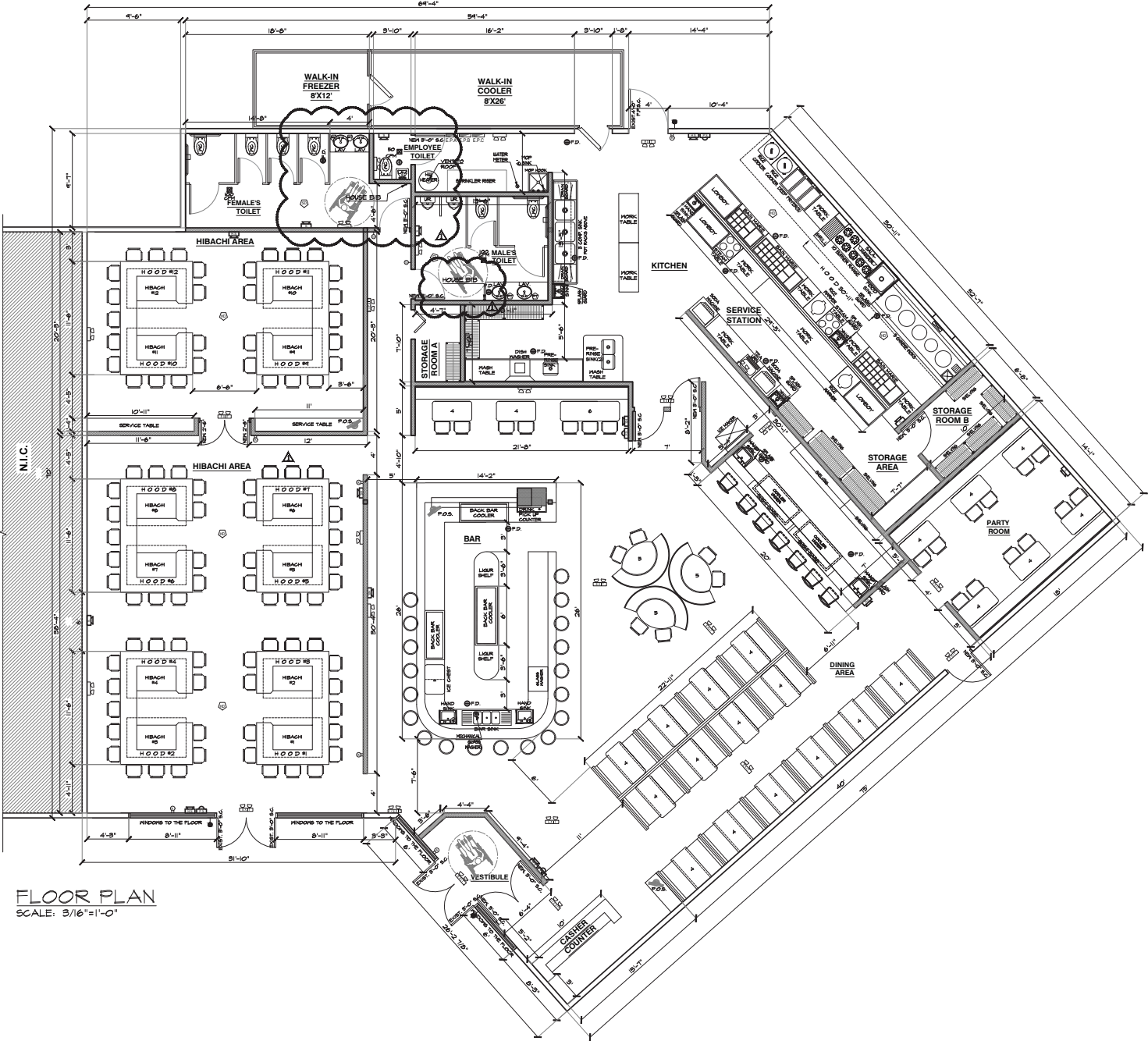

FLOOR PLAN
SCALE: 3/16"=1'-0"



CLOSE AERIAL



POPULATION

| | |
|---------------|---------|
| 2 Mile: | 16,897 |
| 5 Mile: | 98,944 |
| 15 Min Drive: | 156,560 |



EMPLOYEES

| | |
|---------------|--------|
| 2 Mile: | 6,484 |
| 5 Mile: | 31,729 |
| 15 Min Drive: | 53,504 |



MEDIAN HH INCOME

| | |
|---------------|-----------|
| 2 Mile: | \$119,599 |
| 5 Mile: | \$108,859 |
| 15 Min Drive: | \$101,052 |



89 PLAISTOW ROAD / ROUTE 125 • HAVERHILL, MA



AERIAL & DEMOGRAPHICS

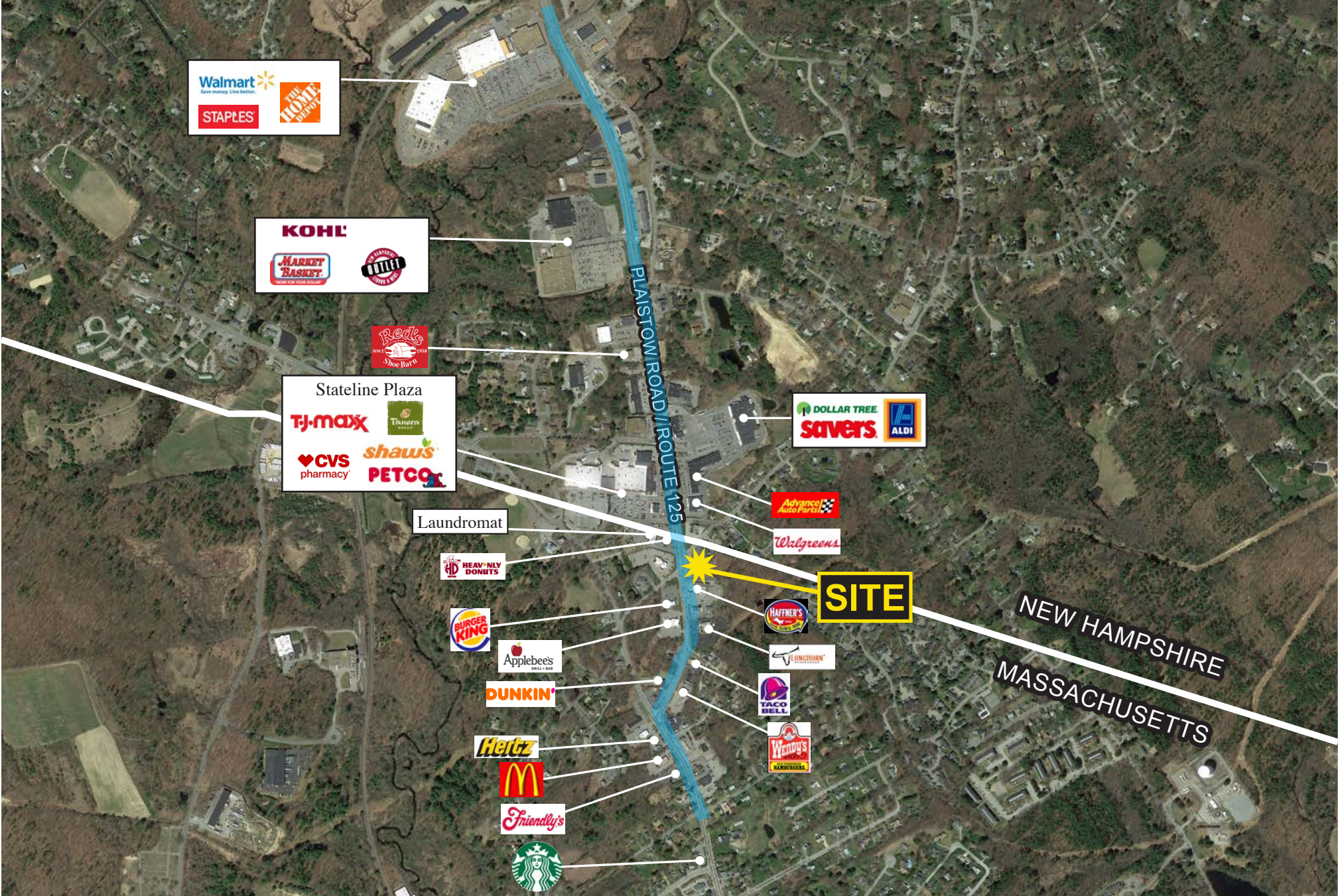

89 PLAISTOW ROAD / ROUTE 125 • HAVERHILL, MA



Find Your Place.

JIM CONVISER
JIM@CONVISERPG.COM
MOBILE: (617) 839-0456

ADAM CONVISER
ADAM@CONVISERPG.COM
MOBILE: (617) 593-1700



CONVISER PROPERTY GROUP, INC
220 RESERVOIR STREET, SUITE 9 • NEEDHAM, MA 02494
O: (781) 320-0600 • F: (781) 791-4599 • WWW.CONVISERPG.COM



89 PLAISTOW ROAD / ROUTE 125 • HAVERHILL, MA



Ver: 1.28.26