

GIBSON MILL

(2) ±7,500 SF INDUSTRIAL SPACES
AVAILABLE FOR LEASE

320 Sign Dr NW

Concord, NC 28027

Ryan Kendall
Vice President
704 612 0395
ryan.kendall@avisonyoung.com

Tom Tropeano, SIOR
Principal
704 413 0228
tom.tropeano@avisonyoung.com

Chris Loyd
Principal
704 612 0238
chris.loyd@avisonyoung.com

**AVISON
YOUNG**

Property Specifications

Gibson Mill | 320 Sign Dr NW

Address: 320 Sign Drive NW
Concord, NC 28027

Available SF: ±7,500 sf
±7,500 sf

Clear Height: 22'

Loading Doors: Access to eight (8) shared DH doors
Access to one (1) shared DI door

Column Spacing: ±25' x 25'

Fire Protection: Wet sprinkler

Availability: Immediately

Asking Rate: Call brokers for pricing

Lease Terms: Flexible terms available

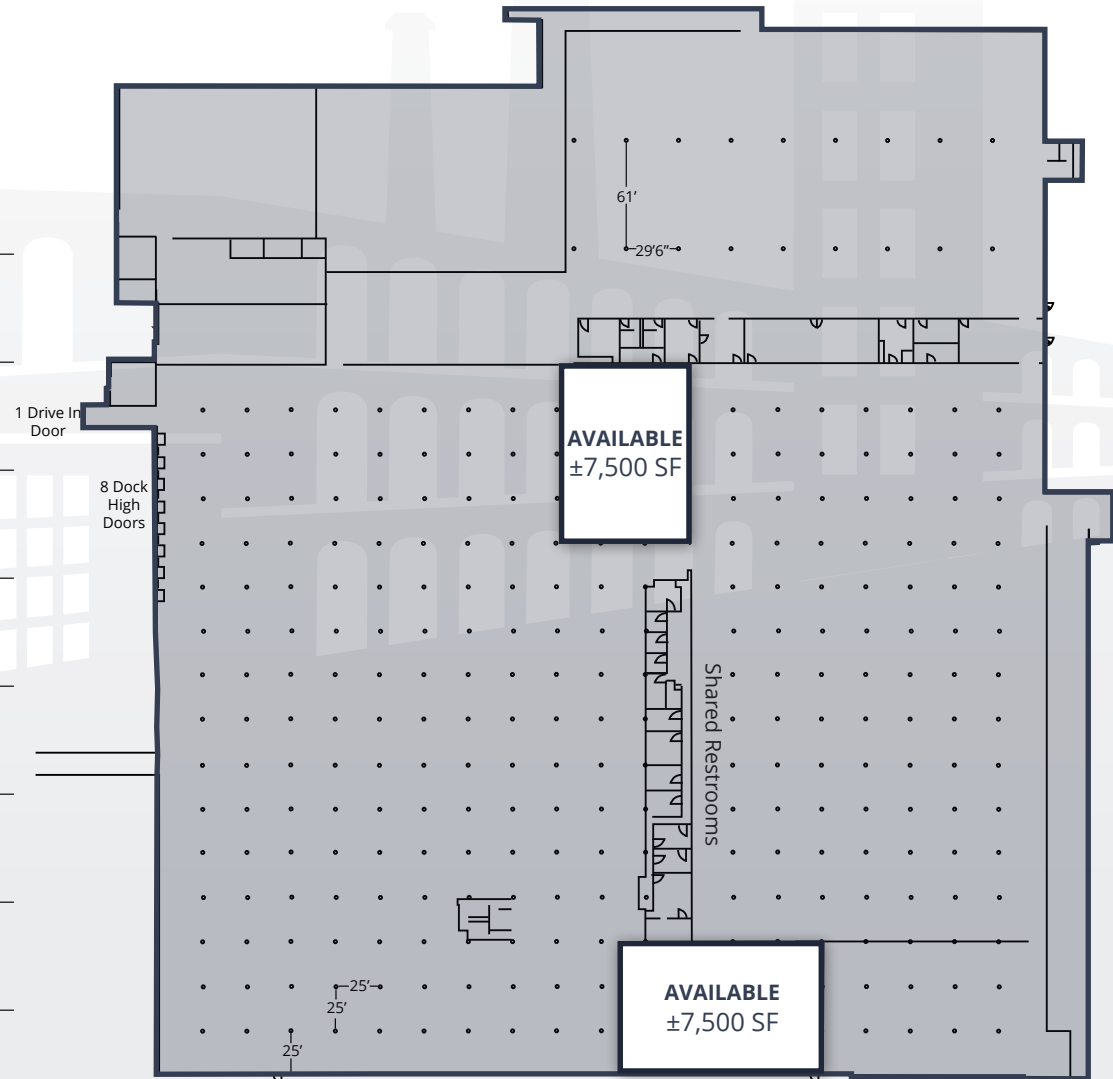

For more information please contact:

Ryan Kendall
Vice President
704 612 0395
ryan.kendall@avisonyoung.com

Tom Tropeano, SIOR
Principal
704 413 0228
tom.tropeano@avisonyoung.com

Chris Loyd
Principal
704 612 0238
chris.loyd@avisonyoung.com

**AVISON
YOUNG**

Property Photos

Gibson Mill | 320 Sign Dr NW



For more information please contact:

Ryan Kendall
Vice President
704 612 0395
ryan.kendall@avisonyoung.com

Tom Tropeano, SIOR
Principal
704 413 0228
tom.tropeano@avisonyoung.com

Chris Loyd
Principal
704 612 0238
chris.loyd@avisonyoung.com



Location Overview

Gibson Mill | 320 Sign Dr NW

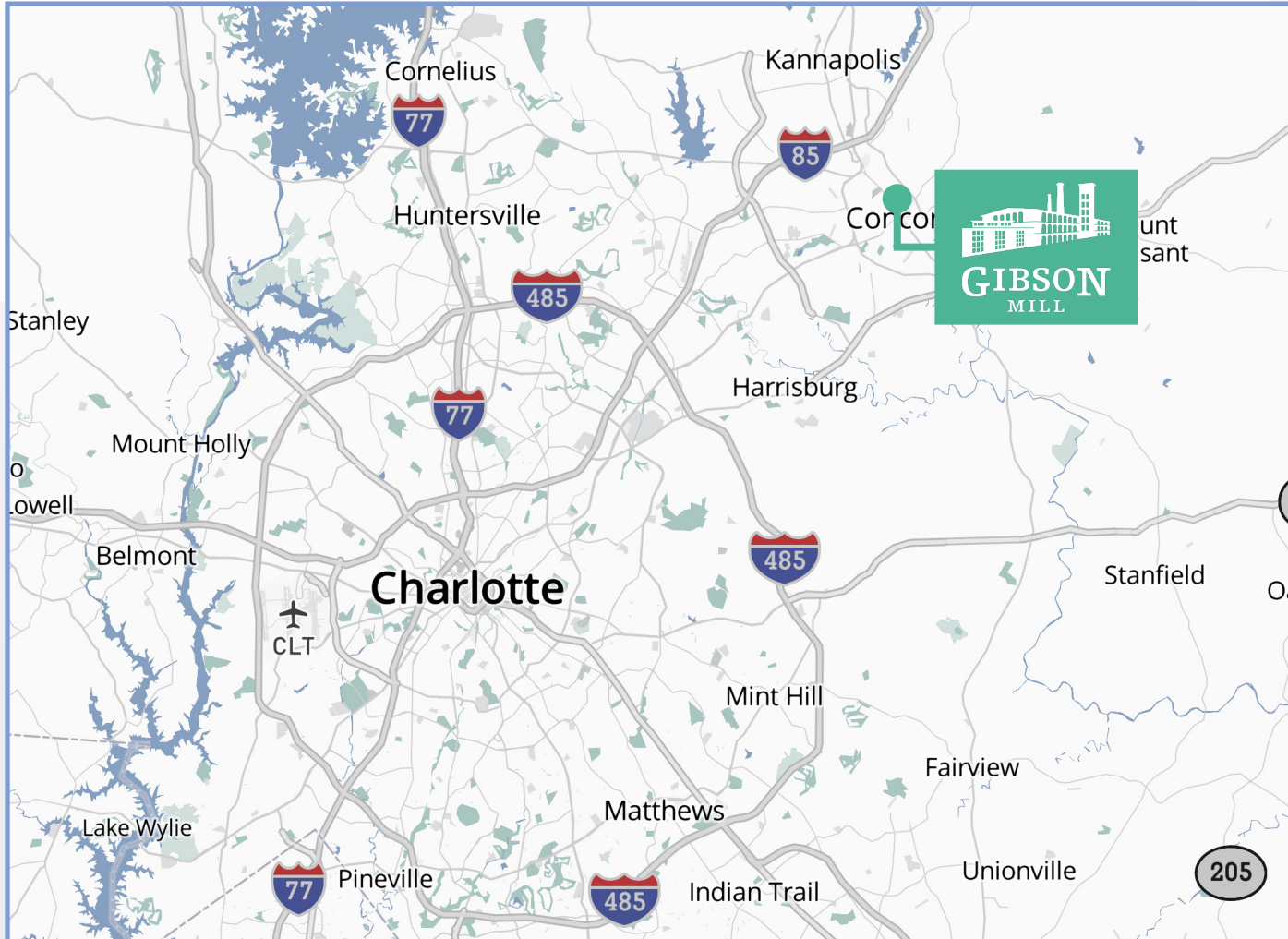

INTERSTATE 85
four miles



INTERSTATE 485
ten miles

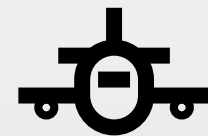

CONCORD
REGIONAL
AIRPORT
eleven miles

For more information please contact:

Ryan Kendall

Vice President
704 612 0395

ryan.kendall@avisonyoung.com

Tom Tropeano, SIOR

Principal
704 413 0228

tom.tropeano@avisonyoung.com

Chris Loyd

Principal
704 612 0238

chris.loyd@avisonyoung.com

**AVISON
YOUNG**