

# ±71,929 SF INDUSTRIAL BUILDINGS AVAILABLE

507-531 E EUCLID AVE | COMPTON, CA 90222

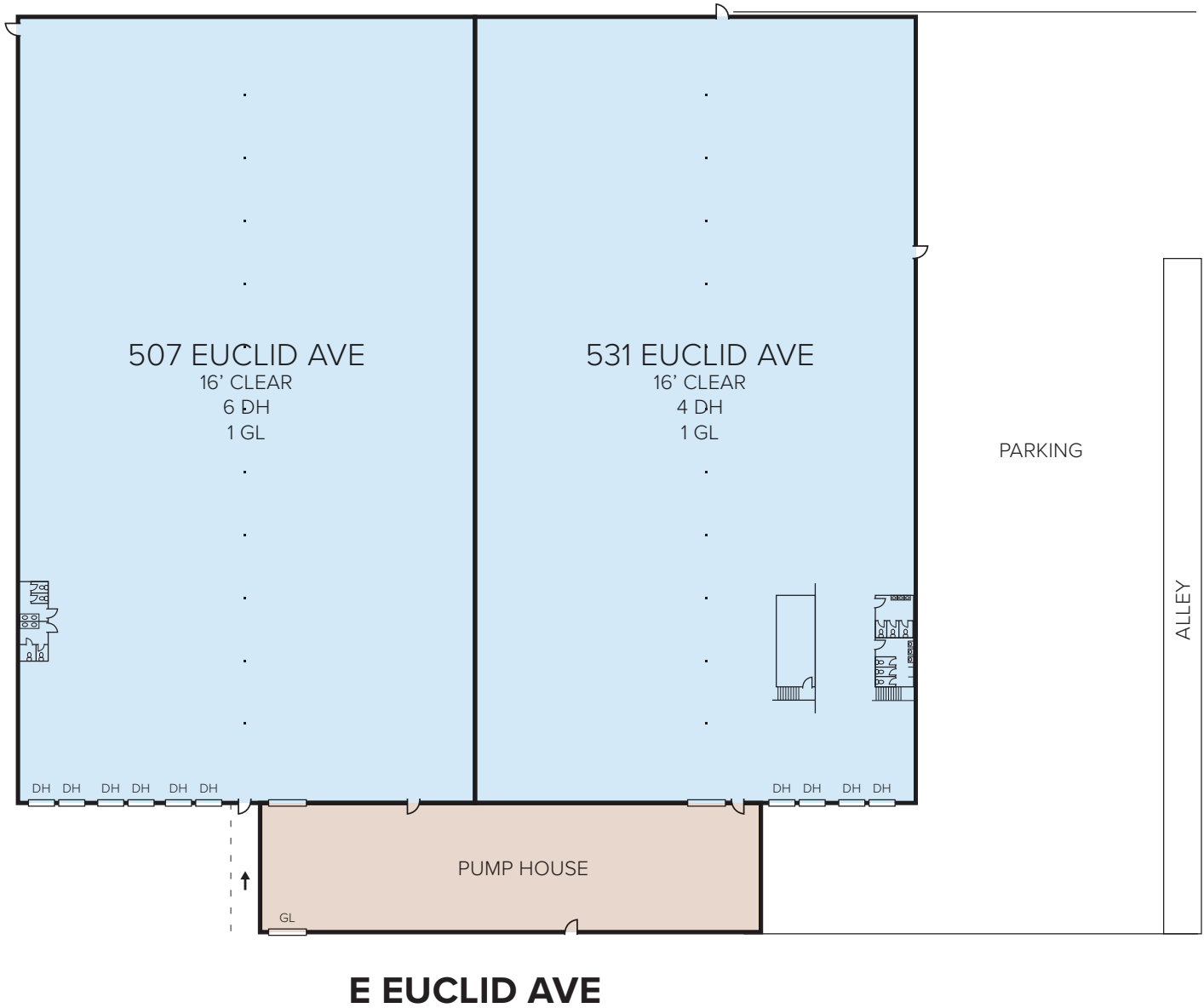

FOR MORE INFORMATION, PLEASE CONTACT

NOTE: Drawing not to scale. All measurements and sizes are approximate. Lessee to Verify

### REMY MOSES

Principal | LIC NO 01938772  
e rmoses@lee-associates.com  
o 310.965.1752

### DAVID BALES

Principal | LIC NO 01388502  
e dbales@lee-associates.com  
o 310.965.1740

### DOUG CLINE

Senior Vice President | LIC NO 01142005  
e dcline@lee-associates.com  
c 213.324.2957

**Team-Cline.com**

### EVAN JURGENSEN

Senior Vice President | LIC NO 01967347  
e ejurgensen@lee-associates.com  
o 323.922.3733

**Team-Cline.com**

### JACK R. CLINE, JR.

President | LIC NO 00854279  
e jcline@lee-associates.com  
c 213.590.3512

**Team-Cline.com**