



For sale

1006 N Sheppard Street Richmond, VA

- Approximately 2,000 SF building for sale
- 12'6" ceiling height to joist
- TOD-1 Zoning
- Redevelopment opportunity
- Located in the heart of Scott's Addition
- Oversize grade level door (10'x14') with small office
- .046 acres
- 1 block from Broad Street, Boulevard and W Marshall Street

Contact us:

John Carpin (Owner/Agent)
Senior Vice President
+1 804 267 7216
john.carpin@colliers.com

2221 Edward Holland Dr
Suite 600 | Richmond, VA
P: +1 804 320 5500
colliers.com/richmond

Copyright © 2024 Colliers International. Information herein has been obtained from sources deemed reliable, however its accuracy cannot be guaranteed. The user is required to conduct their own due diligence and verification.

Floor Plan

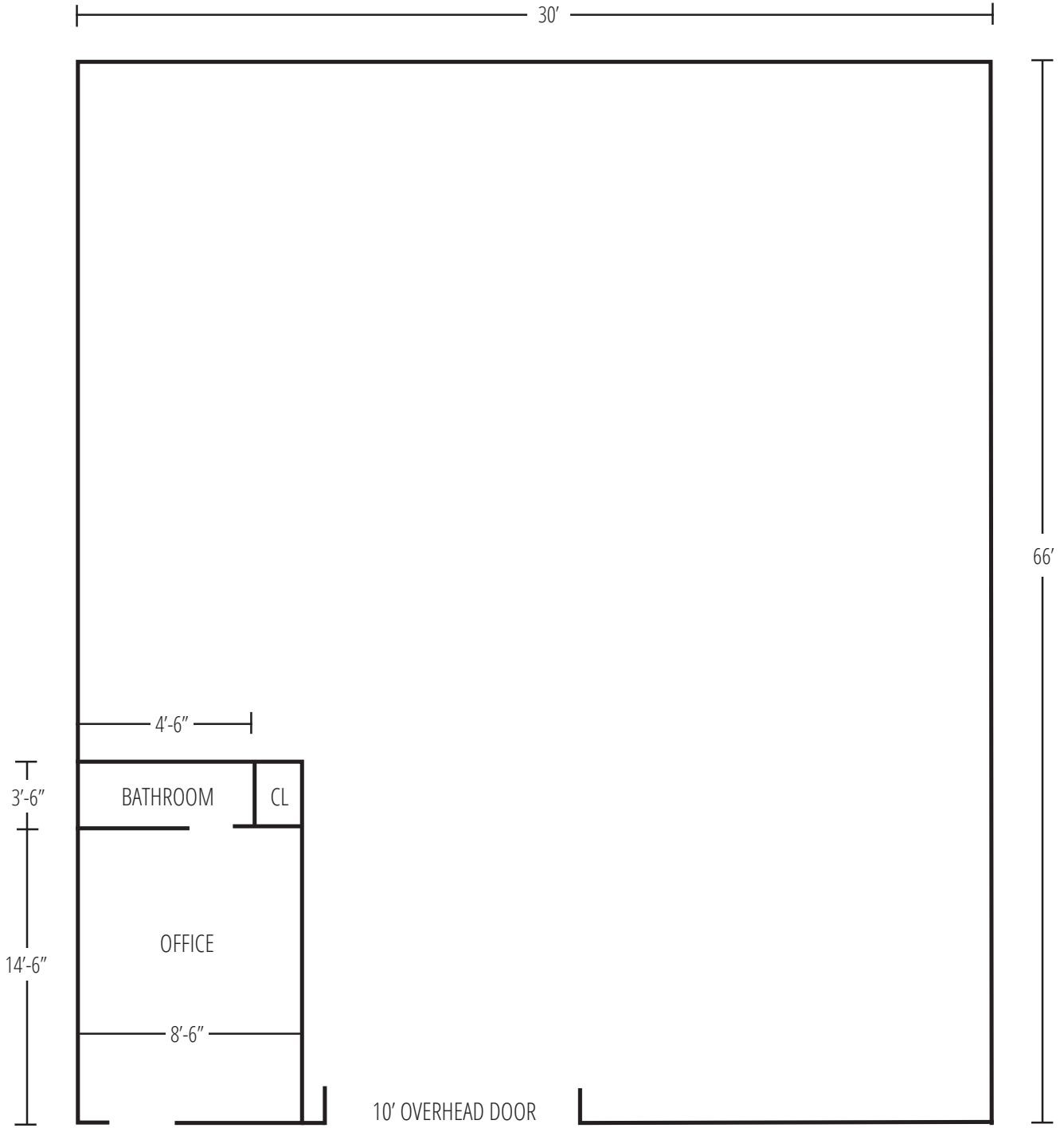

1006 N Sheppard St

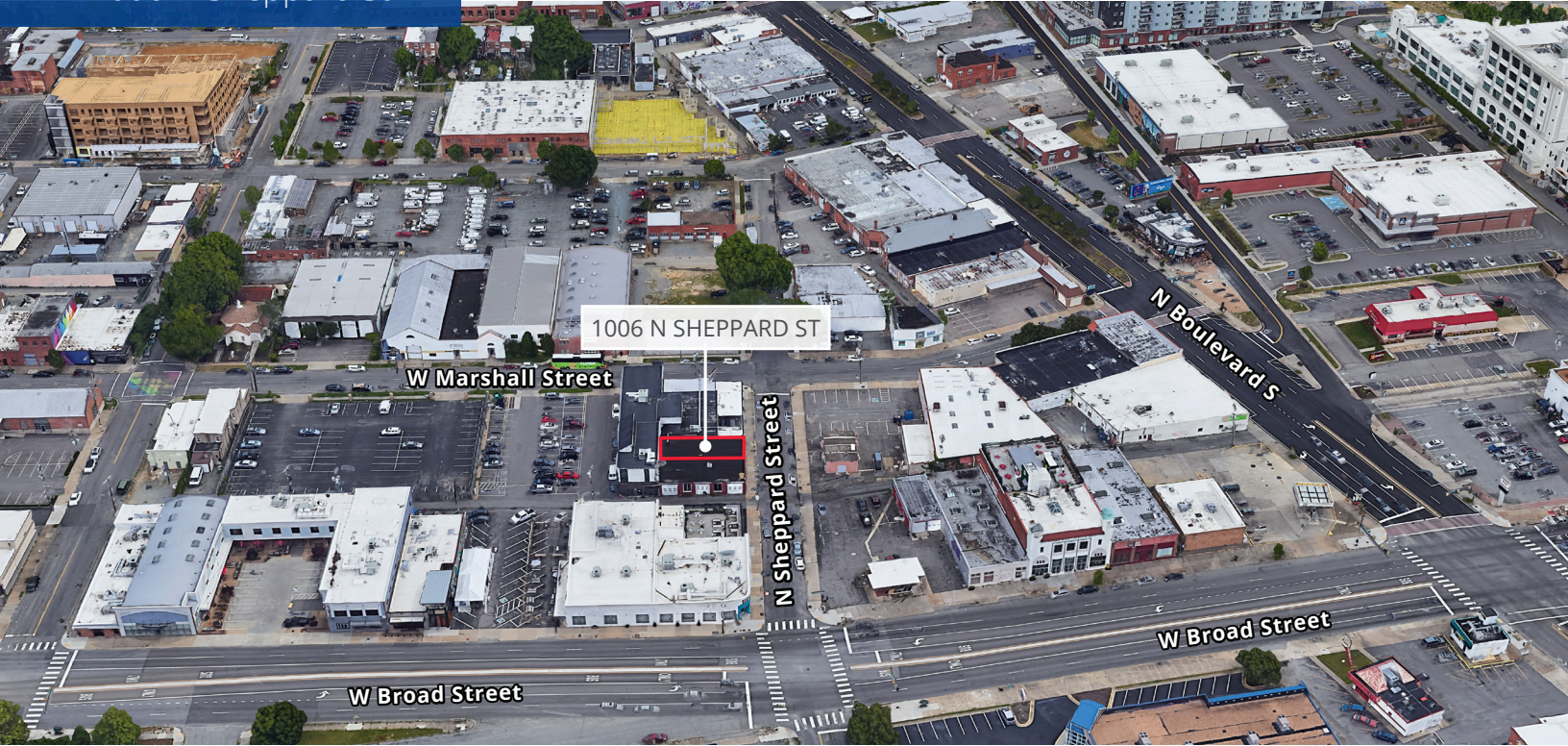

SCOTT'S ADDITION

BEERWORKS VASEN
TAZZA KING POPS
Pete's Ching SYRACUSE

DIAMOND DISTRICT
Proposed Redevelopment

Redevelopment Plans include:

- Redevelopment of 67 acres
- New 10,000-capacity stadium to replace The Diamond
- Will include additional mixed-use development to include a hotel and infrastructure upgrades

VCU ATHLETICS VILLAGE
Proposed Redevelopment

Development Plans include:

- The developments will include new facilities for tennis, soccer and outdoor track & field in addition to practice fields and an indoor multipurpose facility

1006 N SHEPPARD ST

Contact us:

John Carpin (Owner/Agent)
Senior Vice President
+1 804 267 7216
john.carpin@colliers.com

2221 Edward Holland Dr
Suite 600 | Richmond, VA
P: +1 804 320 5500
colliers.com/richmond