



## High-Traffic Pad Site

2405 W Loop 250 N, Midland, TX 79705

### Property Features

- This well-positioned .61 acre parcel of land in the heart of Midland's retail and restaurant corridor is available for sale, ground lease or build-to-suit
- Excellent visibility & access to N Loop 250 boasting an average of 80,000 VPD
- Serving a population of 70,355 with an average household income of \$129,201 within a 3 mile radius

### Area Retailers & Businesses:

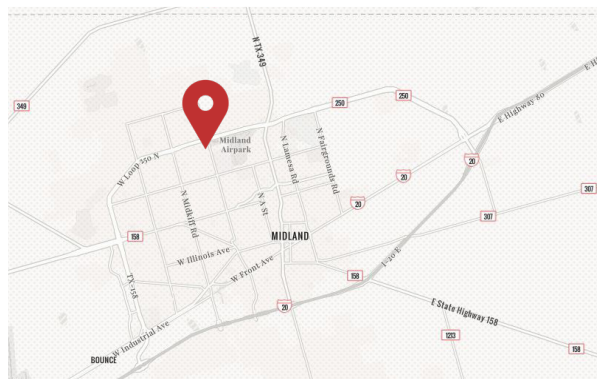

LOT SIZE - ACRES	.61 Acres
LOT SIZE - SF	26,543 SF
SALE PRICE	\$500,000
LEASE RATE	Contact Broker

NO WARRANTY OR REPRESENTATION, EXPRESS OR IMPLIED, IS MADE AS TO THE ACCURACY OF THE INFORMATION CONTAINED HEREIN, AND THE SAME IS SUBMITTED SUBJECT TO ERRORS, OMISSIONS, CHANGE OF PRICE, RENTAL OR OTHER CONDITIONS, PRIOR SALE, LEASE OR FINANCING, OR WITHDRAWAL WITHOUT NOTICE, AND OF ANY SPECIAL LISTING CONDITIONS IMPOSED BY OUR PRINCIPALS NO WARRANTIES OR REPRESENTATIONS ARE MADE AS TO THE CONDITION OF THE PROPERTY OR ANY HAZARDS CONTAINED THEREIN ARE ANY TO BE IMPLIED.

Shannon Powell  
shannon@naiwheelhouse.com  
+1 281 788 1758  
naiwheelhouse.com

Logan Greene  
logan@naiwheelhouse.com  
+1 325 207 9178  
naiwheelhouse.com

# AVAILABLE

## POTENTIAL SITE PLAN

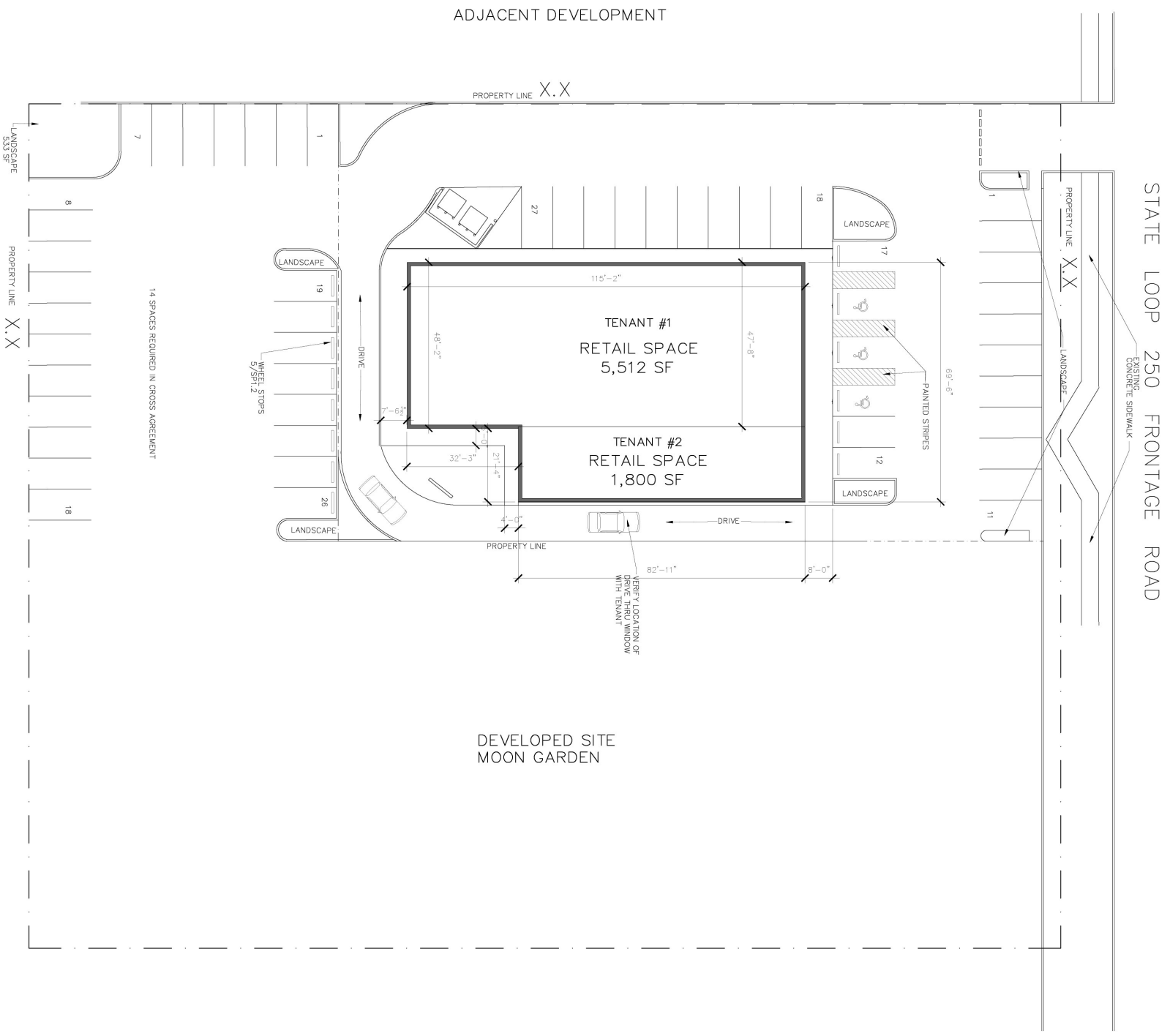



# AVAILABLE

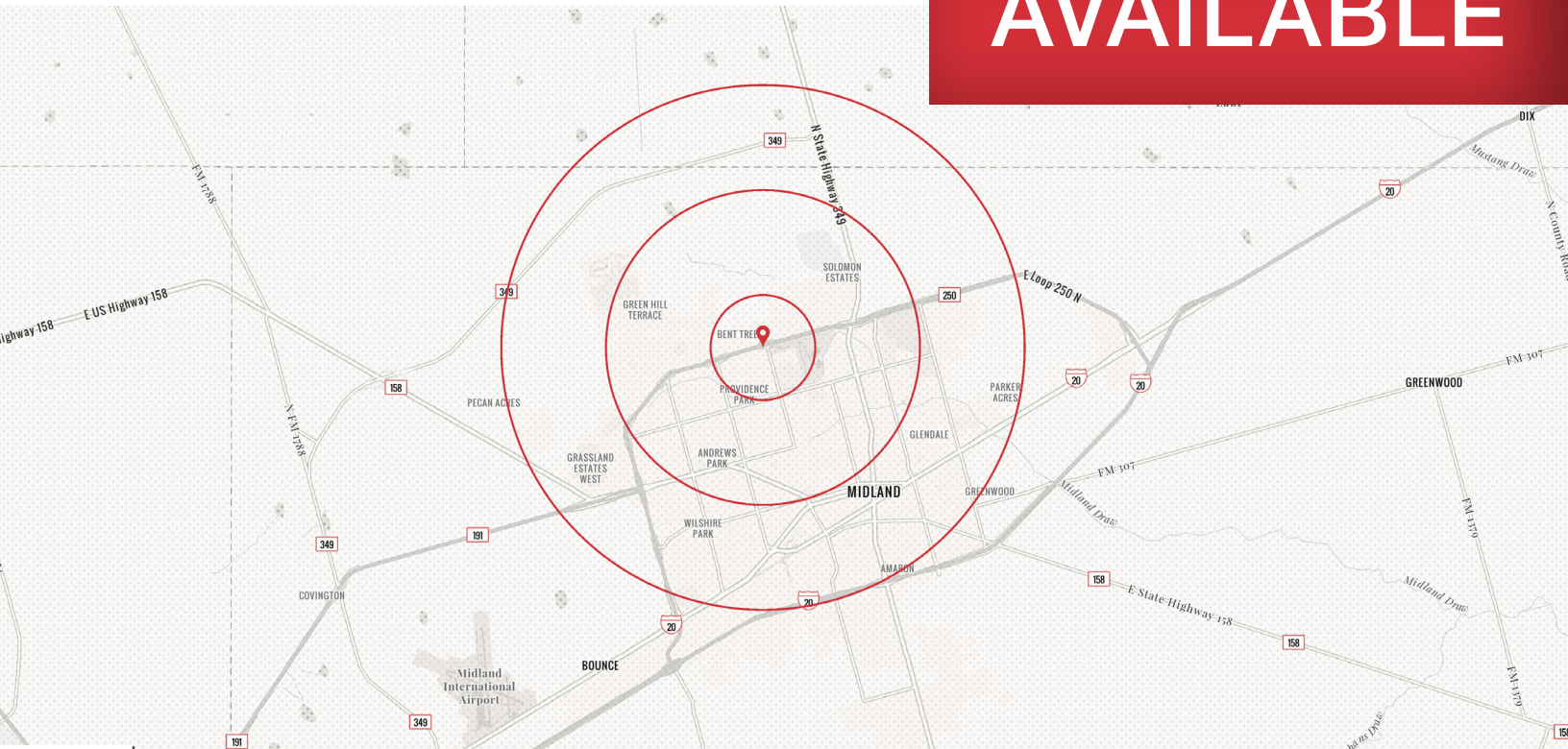

## Demographic Summary:

	1 MILE	3 MILES	5 MILES
POPULATION	9,670	70,355	134,688
AVG HH INCOME	\$123,530	\$129,201	\$127,438
HOUSEHOLDS	4,123	27,763	49,716
MEDIAN AGE	36.7	35.2	34.2

## Location Advantages

- Located near the busy intersection of N Loop 250 & N Garfield Street, two major arterial roads in Midland, Texas
- Excellent visibility & frontage on N Loop 250 boasting an average of 80,000 VPD
- Quick access to N Loop 250 makes this location easy to get to from anywhere in Midland