

# FREESTANDING BUILDING



**MID-AMERICA<sup>®</sup>**  
Real Estate-Michigan, Inc.

20000 W. 10 Mile Road / Southfield, MI

**FOR LEASE**



RETAIL OPPORTUNITY

# FREESTANDING BUILDING



## Address

20000 W. 10 Mile Road  
Southfield, MI 48075

## Availability

1 Story Building: 2,419 SF  
2 Story Building: 2,530 SF

## Features

Located at the hard corner of W. 10 Mile Road and Evergreen, this property sits at a high-traffic intersection with over 29,000 vehicles per day. The building is just east of the John C. Lodge Freeway, and provides convenient access to Northwestern Highway. With Lawrence Technological University, AT&T Corporate, and Corewell Health nearby, the property benefits from strong demographics and a dense daytime population.

## Co-Tenants



## Demographics (2025)

	1 MILE	3 MILES	5 MILES
POPULATION	7,367	103,649	310,455
HOUSEHOLDS	2,904	46,120	136,468
AVG HOUSEHOLD INCOME	\$96,407	\$87,202	\$100,511
DAYTIME POPULATION	21,299	128,611	331,922

# FREESTANDING BUILDING

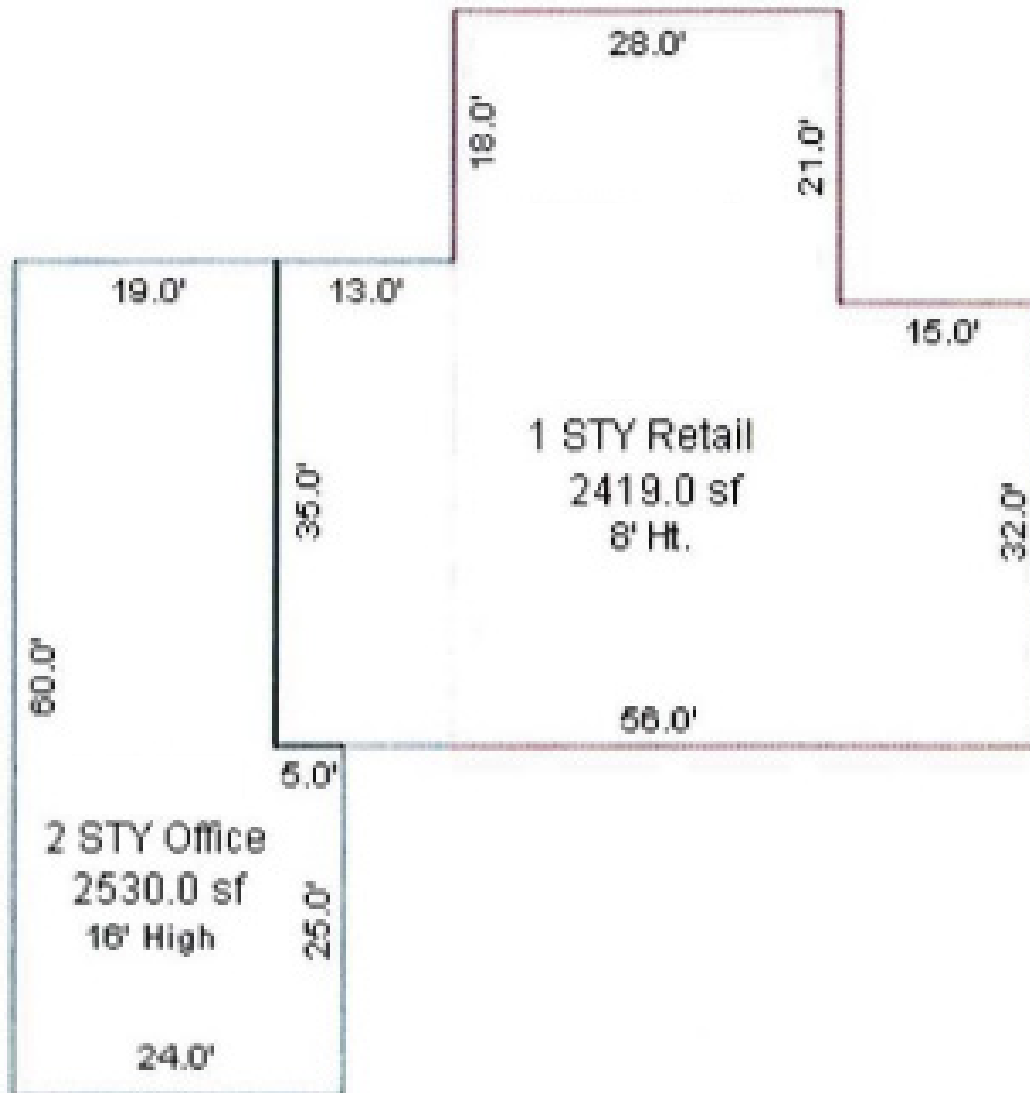

# FREESTANDING BUILDING



# FREESTANDING BUILDING

Jake  
Lievois

Mid-America Real Estate -  
Michigan, Inc.

T: 248.855.6800

[JLievois@MidAmericaGrp.com](mailto:JLievois@MidAmericaGrp.com)



38500 Woodward Ave, Suite 100  
Bloomfield Hills, Michigan 48304  
248.855.6800

[MidAmericaGrp.com](http://MidAmericaGrp.com)



CONTACT