



HEALEY BUILDING

# Downtown Restaurant / Retail Space For Lease HISTORIC HEALEY BUILDING

Bounded by Broad Street, Walton Street, Forsyth Street & Poplar Street



## Healey Building

57 Forsyth St NW, Suite 63 (On the Corner of Poplar & Forsyth Street)  
Atlanta, GA 30303

**SIZE:** 1,500 to 3,115 RSF (can be subdivided)

**RATE:** Negotiable

**OPEX:** \$9.24/SF

- Street Level Exposure and Access
- Built Out Restaurant Space with Vent, Hood, Grease Trap, Refrigerator and Freezer
- Adjacent to , GSU Aderhold Learning Center, Rialto Theatre & the GSU School of Music
- Formerly Big Dave's Cheesesteaks
- Located in the Heart of the Opportunity Zone. For more information go to <https://www.investatlanta.com/business/bonds-incentives/opportunity-zones/>
- Building on the National Register of Historic Places
- Available Immediately



Dave Smith

404.428.2134

[dave@intowncommercial.com](mailto:dave@intowncommercial.com)

For complete details, please visit: [www.alanjoelpartners.com](http://www.alanjoelpartners.com)

**ALAN JOEL PARTNERS**  
Commercial Real Estate Brokerage & Investment

455 East Paces Ferry Rd, Suite 312  
Atlanta, GA 30305

The information was obtained from sources we assume are reliable. We do not doubt its accuracy, however we do not guarantee it. No liability is assumed for errors and omissions. Information is subject to changes and withdrawal without notice.



# Healey Building Suite 63 3,115 RSF

HEALEY BUILDING

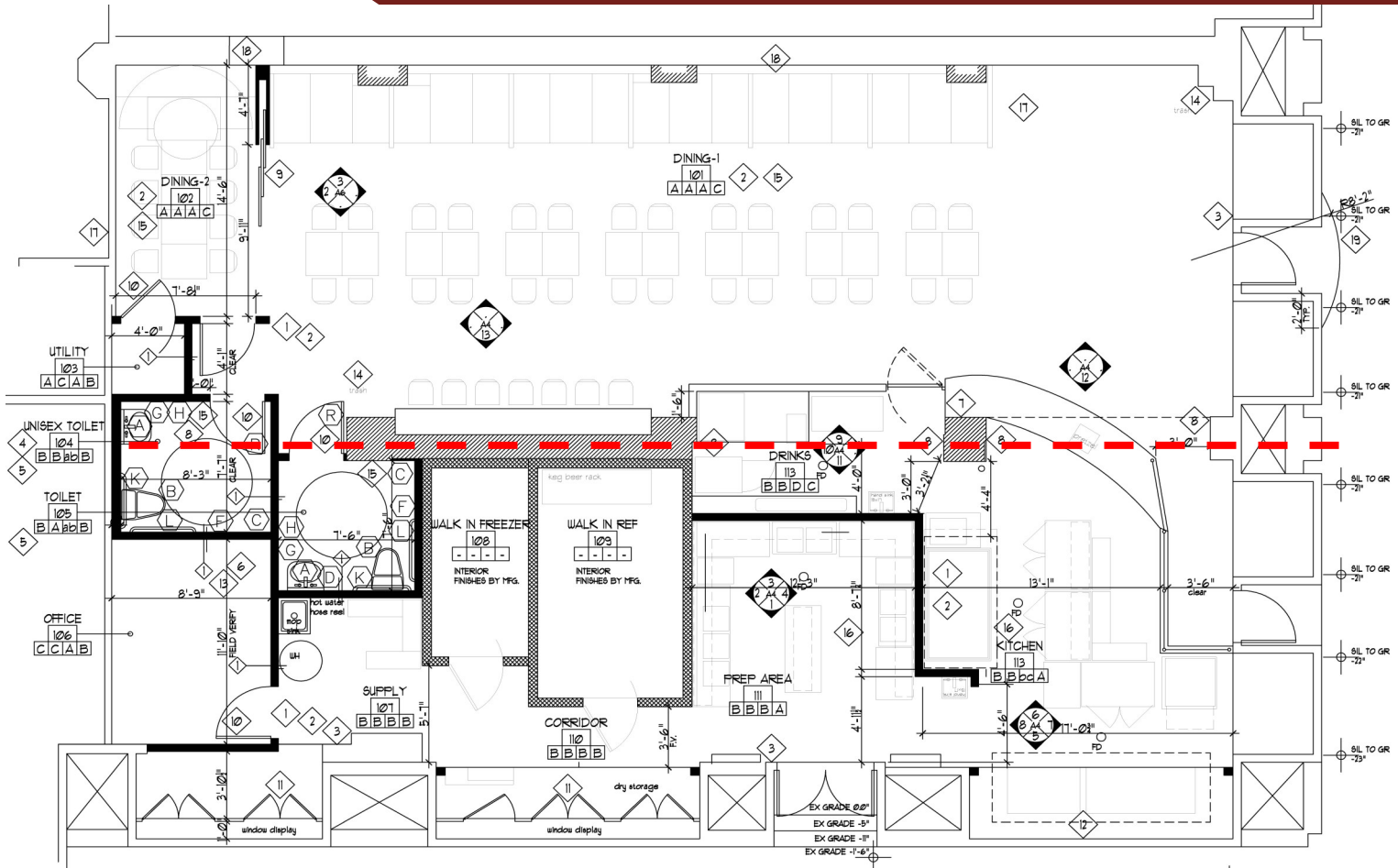

Dave Smith  
404.428.2134  
dave@intowncommercial.com

For complete details, please visit: [www.alanjoelpartners.com](http://www.alanjoelpartners.com)



455 East Paces Ferry Rd, Suite 312  
Atlanta, GA 30305  
(ph) 404.869.2600

The information was obtained from sources we assume are reliable. We do not doubt its accuracy, however we do not guarantee it. No liability is assumed for errors and omissions. Information is subject to changes and withdrawal without notice.





HEALEY BUILDING

# Healey Building Retail Floor Plan

Walton Street



455 East Paces Ferry Rd, Suite 312  
Atlanta, GA 30305  
(ph) 404.869.2600

The information was obtained from sources we assume are reliable. We do not doubt its accuracy, however we do not guarantee it. No liability is assumed for errors and omissions. Information is subject to changes and withdrawal without notice.