

LEASE

51,000 SF Warehouse Available

CLOSE PROXIMITY TO THE PORT OF BALTIMORE

6001 ERDMAN AVE.

Baltimore, MD 21205



SPACE FEATURES

AVAILABLE

51,000 sf

CEILING

16'

OFFICE SPACE

Approx. 3,600 sf

ROOF

New 2020

RENTAL RATE

\$5.25/NNN

OUTSIDE STORAGE

.75 Acres - Fenced

LOADING

4 Covered Docks /
2 Drive-In Doors

LIGHTING

New Interior LED Lights

PARKING

20 Spaces Avail

FLOOR PLAN

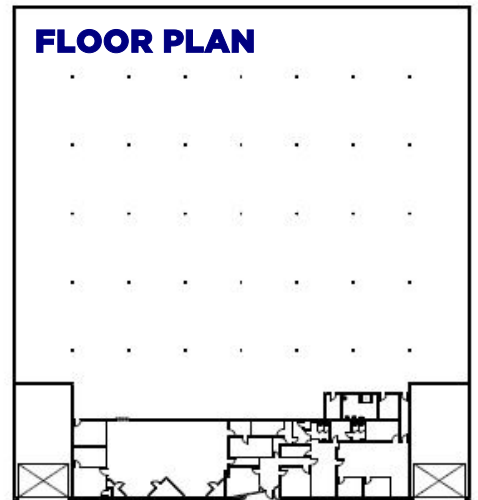

Existing Main Level Plan

SCALE: 1" = 30'



SAVILLS BALTIMORE

102 West Pennsylvania Avenue, Suite 302, Towson, MD 21204

96 3-? - A6; 3B? 6521 724-716 4 =?<=2?AF 3-? @ 2 72; A- 9<? 36 -; 06 4 @3<: @<B?02@122: 21 7296 / 2 Z <
??=??@2; A- A6; @: - 12 - @A- A52 - OOB?- OF A5272<3 -; 1 A @@B/; @A21 @B/ 720AA- 2??<?@ <: @@@; @ 05-; 42 <3
=?@2 72; A- 9<? <A52? 0<; 1 @6; @ =?6? @ 2 2- @2 <? 36 -; 06 4 <? D @51?- D - 9D @5<BA; <A@2





Manufacturing/warehouse facility with great access to Port of Baltimore, I-95, & I-895.



For more information, please contact:

Michael Clark
Senior Managing Director
+1 410 844 3901
MClark@savills.us

SAVILLS BALTIMORE

102 West Pennsylvania Avenue, Suite 302, Towson, MD 21204

96 3-? - A6<; 3B?; 66521 724-716 4 =?-2?AF 3-? @ 2 ?2; A- 9<? 36 -; 06 4 @ 3<: @<B?02@122: 21 ?296 / 2 Z <
??=??2@; A- A6<; @: - 12 - @A- A52 - OOB?- OF A5272<3 -; 1 A @ @B/; 6A21 @B/ 720AA- 2??<?@ <; @ @6<; @ 05-; 42 <3
=762 ?2; A- 9<? <A52? 0<; 1 6<; @ =76? @ 2 2- 2 <? 36 -; 06 4 <? D 651?- D- 9D 65<BA; <A6D2

