

FOR LEASE

±25 ACRES

TRUCK PARKING AND STORAGE YARDS

6645 LONE TREE ROAD | SACRAMENTO, CA

IN THE METRO AIR PARK - MASTER PLANNED INDUSTRIAL DEVELOPMENT

SITE

LONE TREE RD



GUARDIAN YARDS
INDUSTRIAL OUTDOOR STORAGE

CBRE

LOCATION AERIAL VIEW



SITE

amazon

SC Johnson
A science company
at work for a better world

Walmart

SACRAMENTO
INTERNATIONAL AIRPORT

METRO AIR PARK
MASTER PLANNED INDUSTRIAL DEVELOPMENT



GUARDIAN YARDS

INDUSTRIAL OUTDOOR STORAGE



FOR LEASE **±25 ACRES** (ALL OR PART)
TRUCK PARKING AND STORAGE YARDS

PROPERTY OVERVIEW

THE PROJECT OFFERS A UNIQUE OPPORTUNITY FOR USERS TO FULFILL LOGISTICS PARKING, EQUIPMENT LAY-DOWN AND STORAGE YARD NEEDS WITHIN SACRAMENTO'S MOST ACTIVE INDUSTRIAL PARK. **PARKING LOTS AND YARDS CAN BE CUSTOMIZED TO MEET A USER'S UNIQUE NEEDS.**



ADDRESS:

**6645 LONE TREE ROAD,
SACRAMENTO, CA 95836**



LAND AREA:

**25 ACRES
TOTAL**



ZONING:

**SPA - SPECIAL PLANNING AREA
SPA - METRO AIR PARK
SPA SUBAREA - LIGHT
MANUFACTURING & DISTRIBUTION**



ACCESSORS PARCEL #:

201-1020-108-0000

SITE PLAN



NOT TO SCALE—
ALL DIMENSIONS
ARE APPROXIMATE.

LONE TREE ROAD

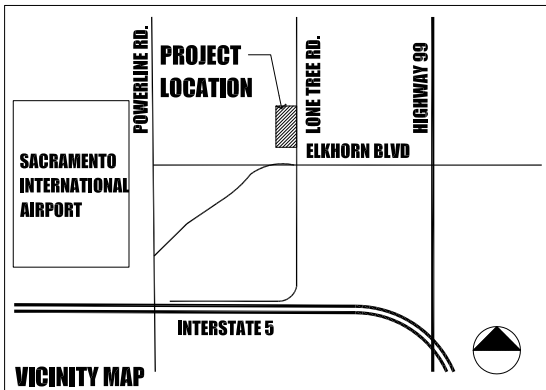
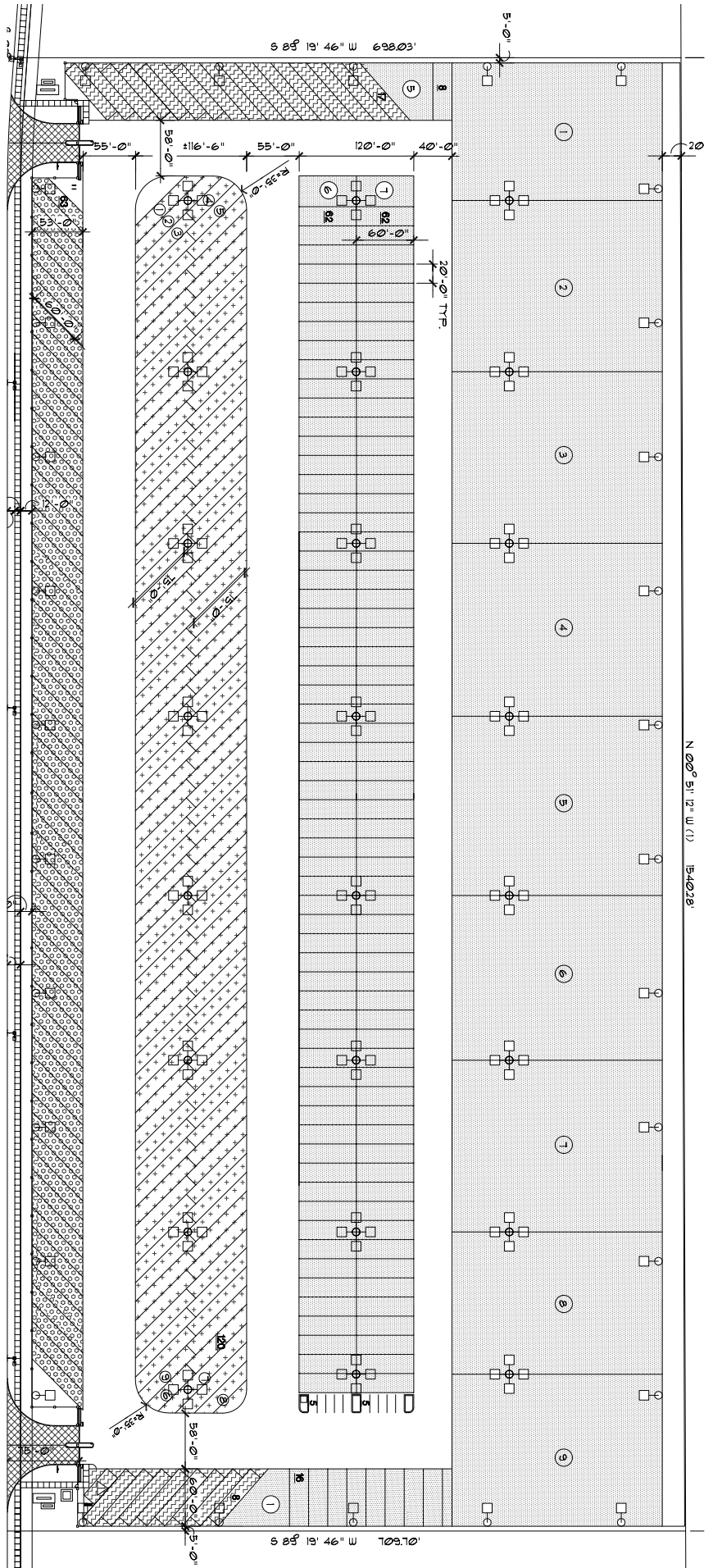

±25 ACRES
TRUCK PARKING AND
STORAGE YARDS



FUTURE
RESIDENTIAL

6645
LONE TREE ROAD
SACRAMENTO, CA

IN THE
METRO AIR PARK -
MASTER PLANNED
INDUSTRIAL
DEVELOPMENT



EXISTING IN CONSTRUCTION FUTURE DEVELOPMENT



CONTACT US:

TODD SANFILIPPO, SIOR
EXECUTIVE VICE PRESIDENT
+1 916 847 3206
TODD.SANFILIPPO@CBRE.COM
LIC. 01045162

WALTER SMYTH
SENIOR VICE PRESIDENT
+1 916 781 4843
WALTER.SMYTH@CBRE.COM
LIC. 00956946

MATT SUSAC
FIRST VICE PRESIDENT
+1 916 781 4832
MATT.SUSAC@CBRE.COM
LIC. 01979110

[CBRE.COM/ROSEVILLE](https://www.cbre.com/roseville)



© 2024 CBRE, Inc. All rights reserved. This information has been obtained from sources believed reliable, but has not been verified for accuracy or completeness. You should conduct a careful, independent investigation of the property and verify all information. Any reliance on this information is solely at your own risk. CBRE and the CBRE logo are service marks of CBRE, Inc. All other marks displayed on this document are the property of their respective owners, and the use of such logos does not imply any affiliation with or endorsement of CBRE. Photos herein are the property of their respective owners. Use of these images without the express written consent of the owner is prohibited. PMStudio_August2024