

For Lease



**1,000 SF - 2,155 SF
AVAILABLE**

**2,002 SF
AVAILABLE**



Hunnington

Hunnington Properties, Inc.
3773 Richmond Ave., Suite 800
Houston, Texas 77046
713-623-6944
hproperties.com

Commons at Lake Olympia

1021 Lake Olympia Pkwy
Missouri City, Texas 77459

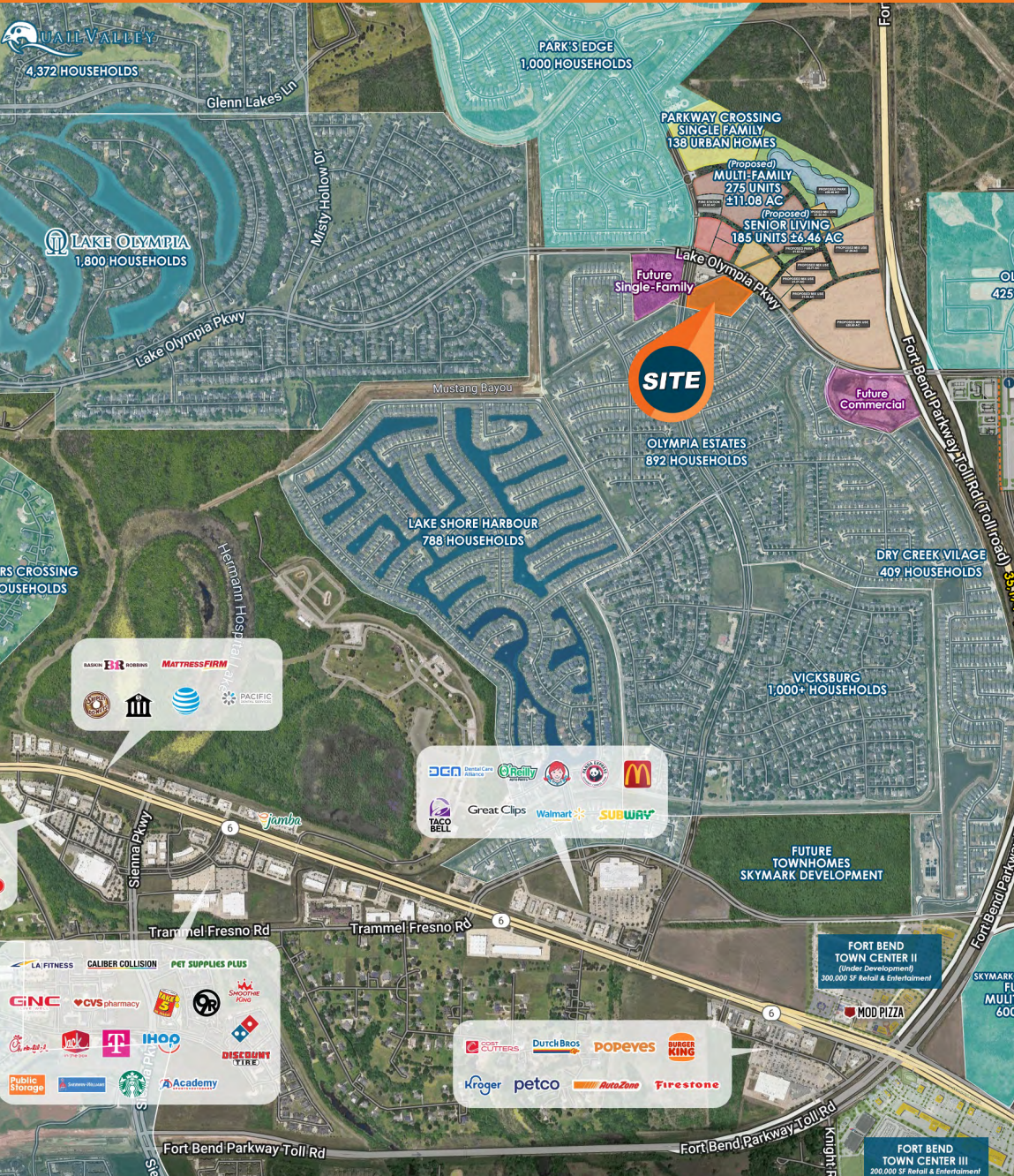

COMMONS AT LAKE OLYMPIA

1021 Lake Olympia Pkwy, Missouri City, Texas 77459

PROPERTY INFORMATION

Space For Lease	2,002 SF 1,000 SF - 2,155 SF (Will Divide)
Rental Rate	\$32.00 PSF
NNN	\$9.00 PSF
Building Size	17,357 SF

PROPERTY HIGHLIGHTS

- Commercial Reserves available at lighted intersection of Lake Olympia & Vicksburg
- Adjacent to new 7-11 convenient store with cross access to median breaks on Lake Olympia and Vicksburg
- Dr Horton and Gateway Homes have over 1500 homes Easy access to Fort Bend Tollway

DEMOGRAPHICS

Population (2024)	1 mi. - 7,526 3 mi. - 56,574 5 mi. - 134,507
Average Household Income	1 mi. - \$144,778 3 mi. - \$177,517 5 mi. - \$182,432
Traffic Count	Fort Bend Pkwy: 35,174 vpd Lake Olympia Pkwy: 9,475 vpd

Jonathan Aron
Principal | Brokerage
jonathan@hpiproperties.com

Hunington Properties, Inc.
3773 Richmond Ave., Ste. 800, Houston, Texas 77046 • 713-623-6944
hpiproperties.com

For Lease

-  Available
-  In Negotiation
-  Leased | Sold

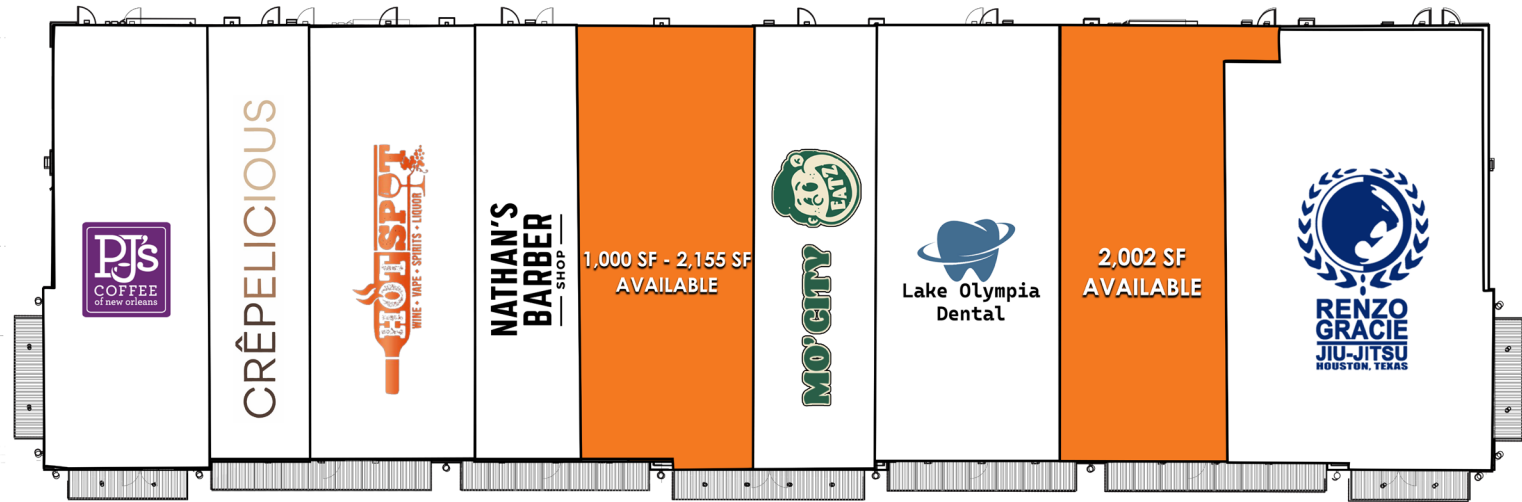

For Lease



Hunington



(Future)
PARKWAY CROSSING
138 TOWNHOMES

(Future) (Future)
MULTI-FAMILY **SENIOR LIVING**
275 UNITS ±11.08 AC 220 UNITS ±6.46 AC

(Future)
MEDICAL FACILITY

(FUTURE)
DEVELOPMENT

LAKE OLYMPIA PKWY

VICKSBURG BLVD

Under Construction
7-ELEVEN

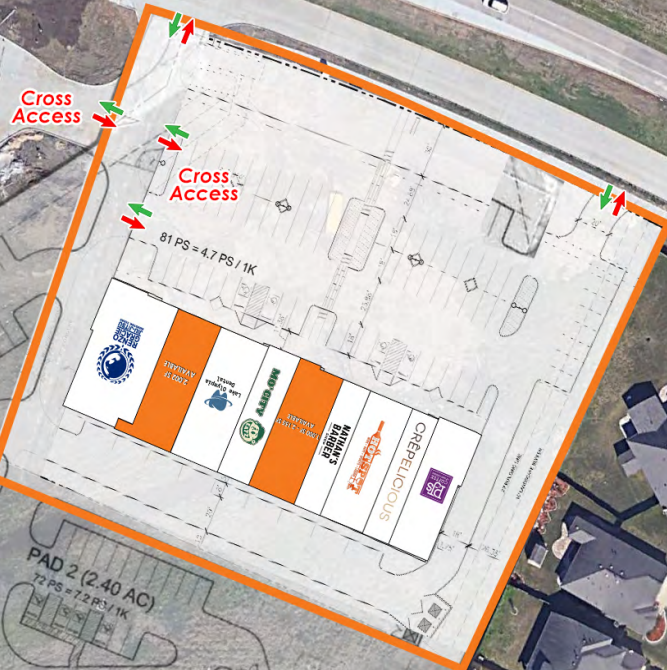

Cross Access

Cross Access

Cross Access

(Future)
Development

PAD 1 (1.72 AC)

PAD 2 (2.40 AC)

PATIO

REST.
5.6K SF

DAYCARE
10K SF

For Lease



Huntington

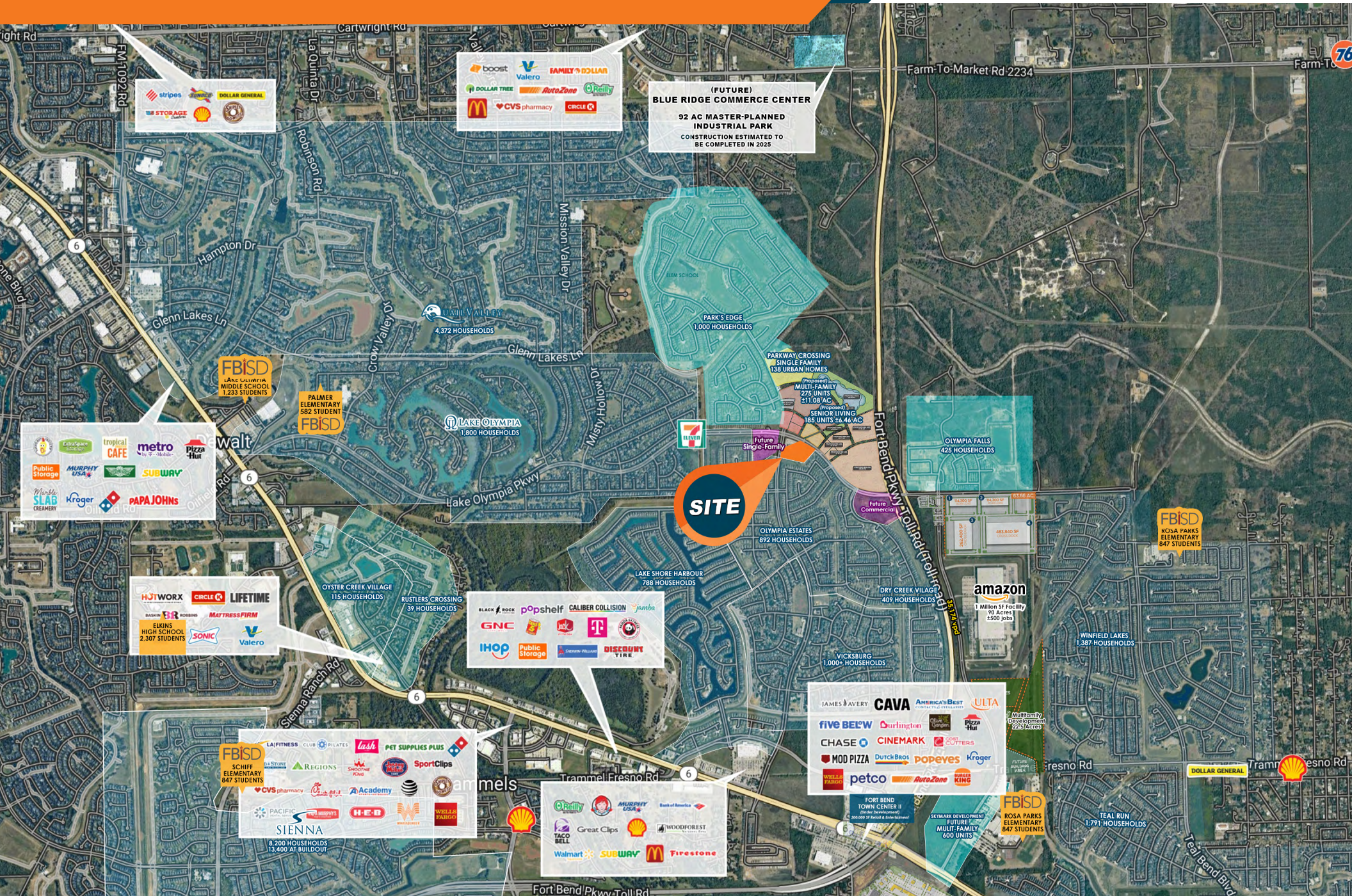

The information contained herein while based upon data supplied by sources deemed reliable, is subject to errors or omissions and is not in any way, warranted by Huntington Properties, or by any agent, independent associate, subsidiary or employee of Huntington Properties. This information is subject to change.

