

5300 AUTO CLUB DRIVE
DEARBORN, MICHIGAN

OFFICE FOR SALE OR LEASE
22,000 - 88,252 Square Feet Available



**SIGNATURE
ASSOCIATES**
KNOW SIGNATURE | KNOW RESULTS

PREMIER OFFICE / R&D CAMPUS



PROPERTY FEATURES

- 20,000-88,252 square feet available
- Part of a unique 3-building campus, all connected with a total available of 449,000 square feet
- Prominent visibility in the hub of Dearborn
- 4-story Class A building
- Access to large auditorium, storage and showroom areas
- Attractively priced to sell
- Very competitive lease opportunity
- Lease rate is negotiable
- Sale price is negotiable

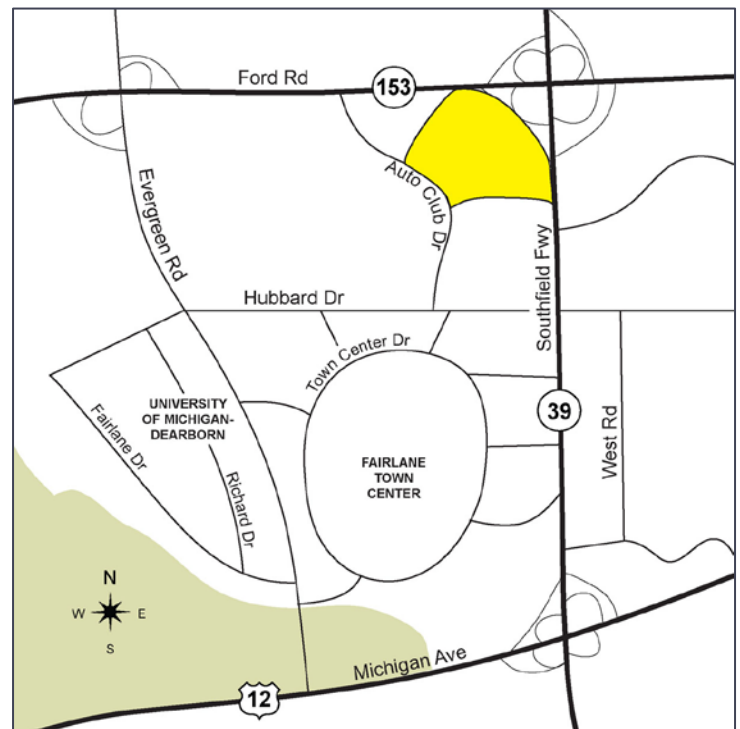

For more information, please contact:

JUSTIN GAFFREY
(248) 799 3143
jgaffrey@signatureassociates.com

CHRIS SECONTINE
(248) 799 3174
csecontine@signatureassociates.com

SIGNATURE ASSOCIATES
One Towne Square, Suite 1200
Southfield, MI 48076
www.signatureassociates.com

5300 Auto Club Drive – Dearborn, Michigan

Office For Sale or Lease

22,000 - 88,252
Square Feet
AVAILABLE

1st Floor

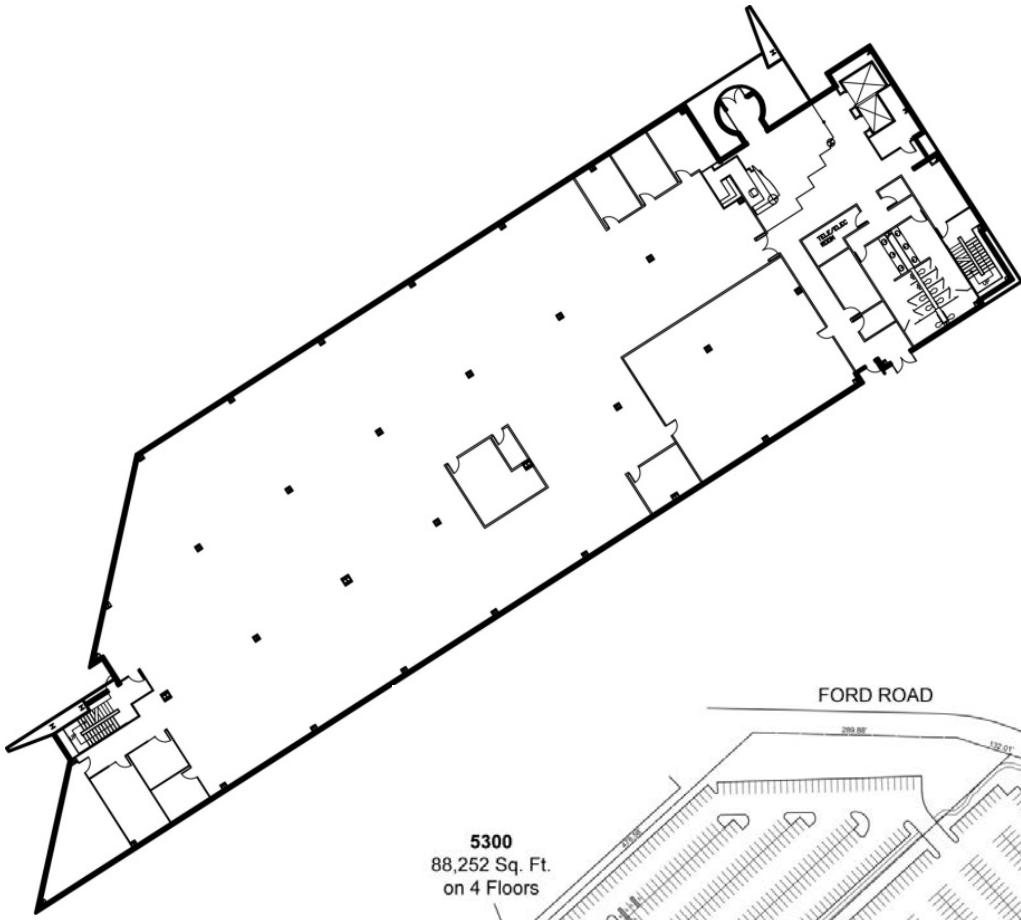

Site Plan

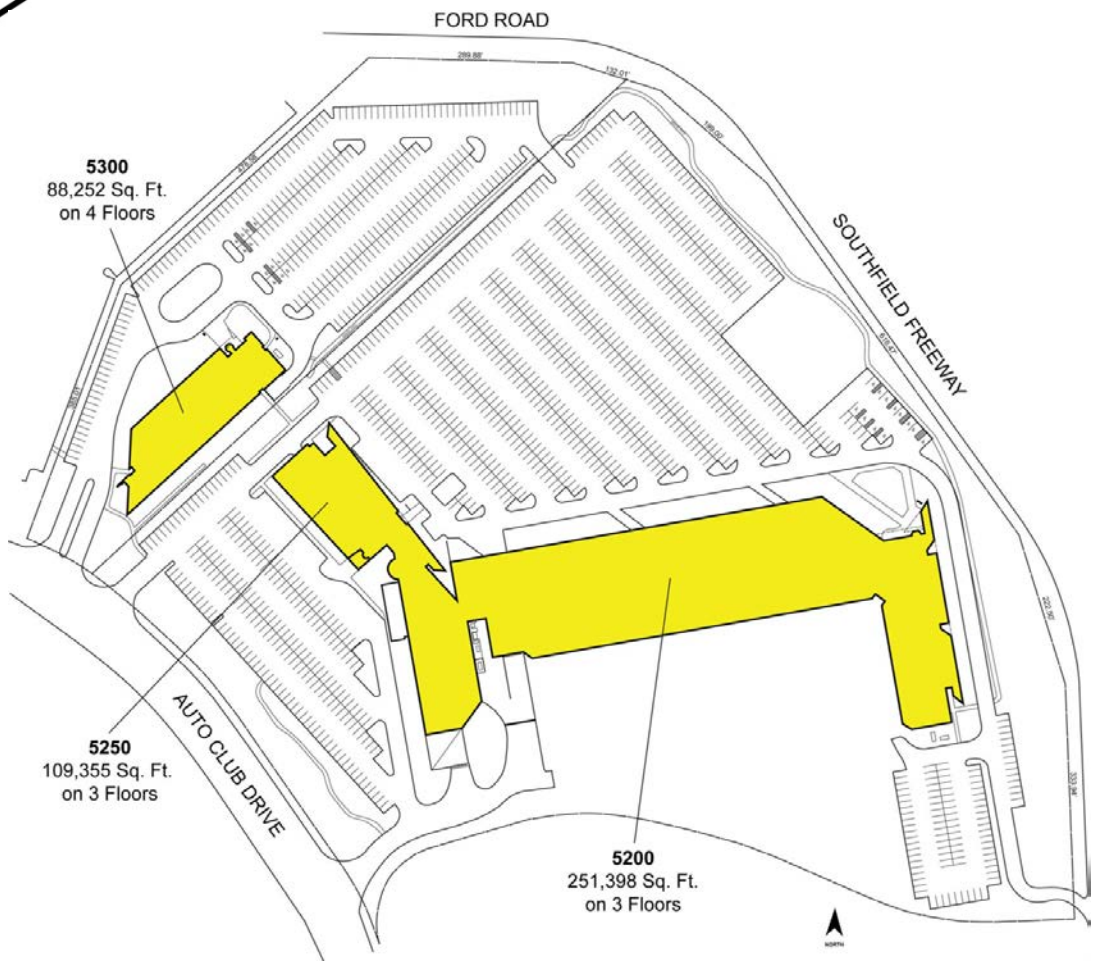

5300
88,252 Sq. Ft.
on 4 Floors

5250
109,355 Sq. Ft.
on 3 Floors

5200
251,398 Sq. Ft.
on 3 Floors

For more information, please contact:

JUSTIN GAFFREY
(248) 799 3143
jgaffrey@signatureassociates.com

CHRIS SECONTINE
(248) 799 3174
csecontine@signatureassociates.com

SIGNATURE ASSOCIATES
One Towne Square, Suite 1200
Southfield, MI 48076
www.signatureassociates.com

Information is subject to verification and no liability for errors or omissions is assumed. Price is subject to change and listing withdrawal.