



Colliers

1816 SW Remington Trail // Huntsville, AL 35824

TRIPP ALEXANDER, CCIM, SIOR
+1 205 552 4343
tripp.alexander@colliers.com

JOE AZAR, CCIM
+1 205 949 2692
joe.azar@colliers.com

FOR LEASE

±155,959 SF

**Office/Warehouse/Production Space &
Trailer Parking Lot**

JETPLEX INDUSTRIAL PARK

PROPERTY HIGHLIGHTS

Location	1816 SW Remington Trail, Huntsville, AL 35824
Space Available	<p>± 155,959 SF Total</p> <ul style="list-style-type: none"> • ± 22,022 SF of Office • ± 133,948 SF Warehouse/production SF
Auto Parking	<p>Concrete truck court</p> <p>Up to 3.0 acres of paved auto/trailer parking per negotiation</p>
Construction	Concrete construction with TPO membrane roof
Dock Doors	12 dock height doors with various existing equipment
Sprinklers	100% fire suppression system coverage
Power	Heavy power
Additional Details	<ul style="list-style-type: none"> • Existing office space and restrooms • 35'x50' typical column spacing • Excellent shipping/ receiving space layout • Security office with gated entry • Concrete truck court • Excellent location within Jetplex Industrial Park • Adjacent to Huntsville International Airport and the Port of Huntsville • ± 2.50 miles to I-565 via Exit 9 • ± 7.50 miles to Redstone Arsenal and Cummings Research Park (CRP)

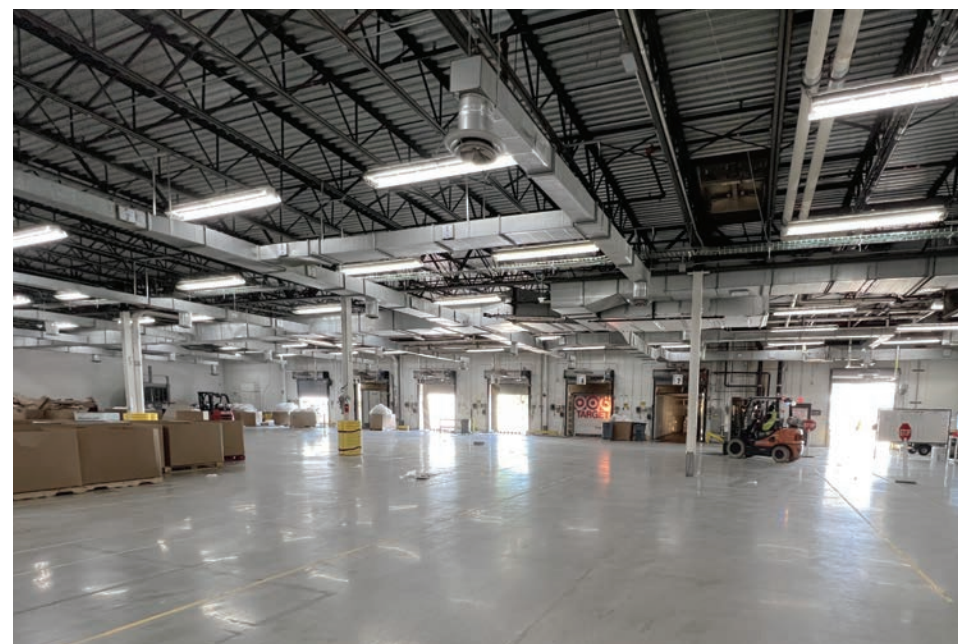
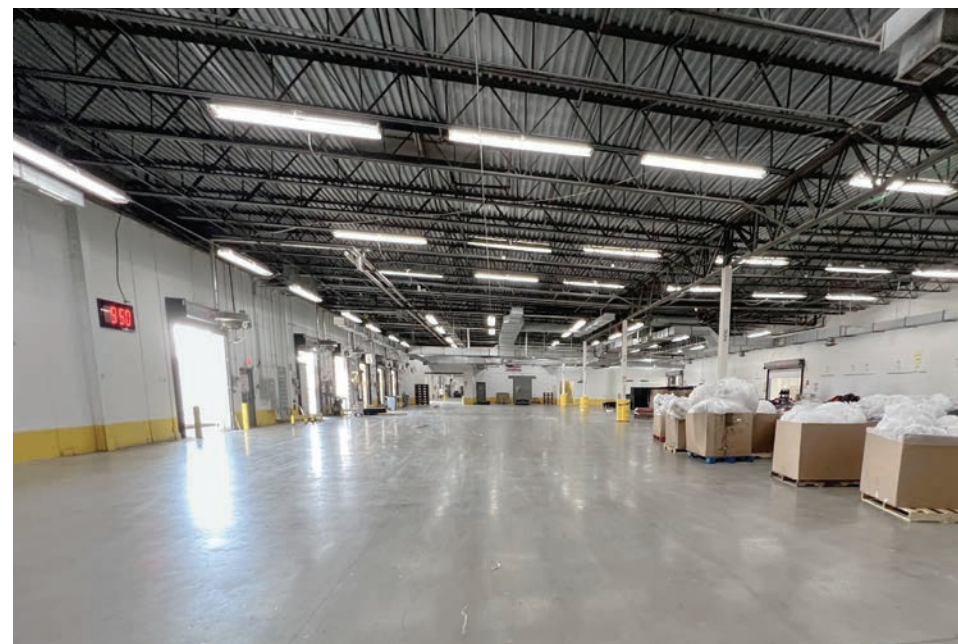



25 & 50 MILE RADIUS MAP



SITE PLAN

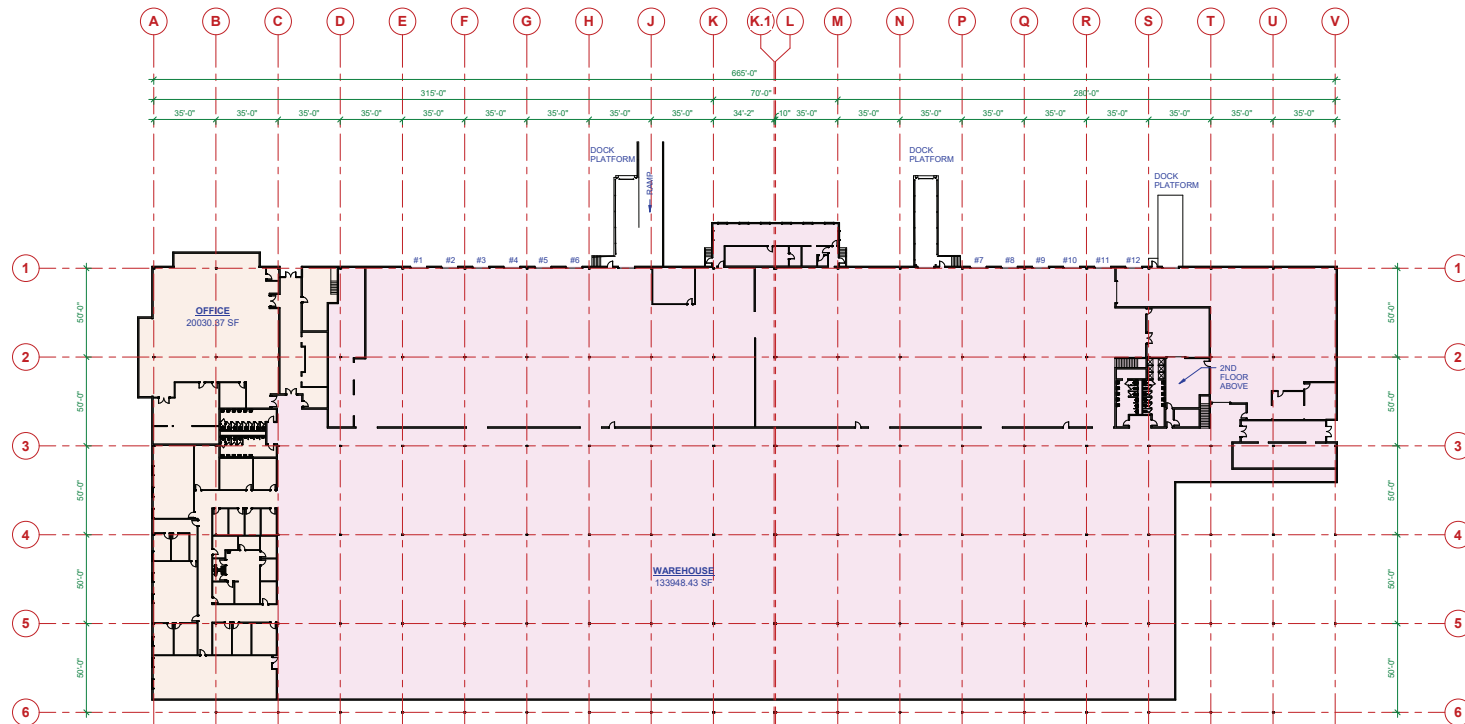

1 1ST FLOOR - COMPOSITE AREA PLAN
A2 1" = 30'-0"

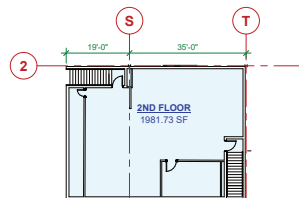

2 2ND FLOOR - MEZZANINE PLAN
A2 1/16" = 1'-0"



LOCATION MAP

2.5

miles to
I-565

11

miles to
I-65

92

miles to
Birmingham

123

miles to
Nashville

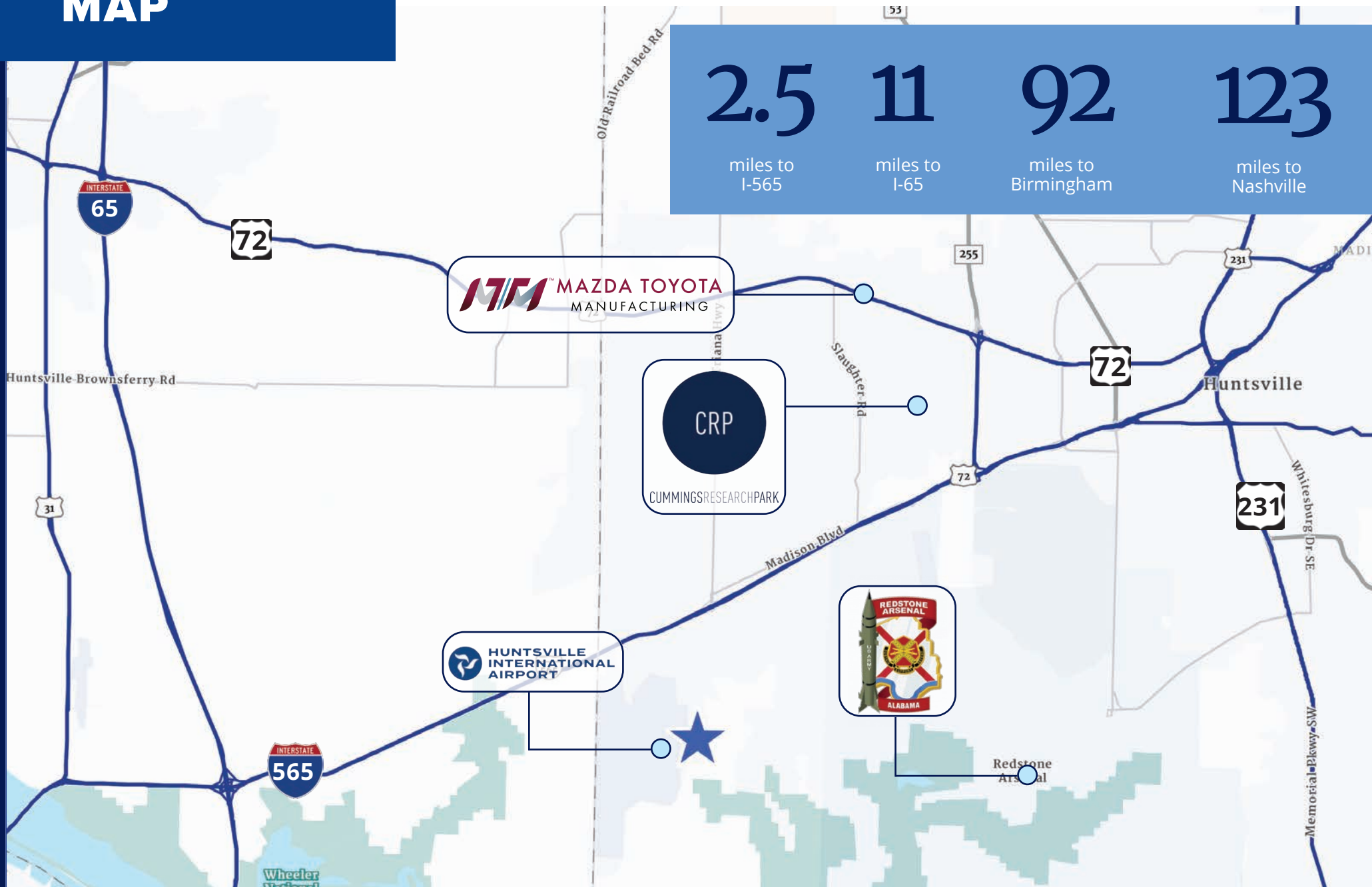

AREA MAP





FOR LEASE

1816 SW Remington Trail // Huntsville, AL 35824

JETPLEX INDUSTRIAL PARK

TRIPP ALEXANDER, CCIM, SIOR

JOE AZAR, CCIM

+1 205 552 4343

tripp.alexander@colliers.com

+1 205 949 2692

joe.azar@colliers.com



Colliers

This document/email has been prepared by Colliers for advertising and general information only. Colliers makes no guarantees, representations or warranties of any kind, expressed or implied, regarding the information including, but not limited to, warranties of content, accuracy and reliability. Any interested party should undertake their own inquiries as to the accuracy of the information. Colliers excludes unequivocally all inferred or implied terms, conditions and warranties arising out of this document and excludes all liability for loss and damages arising there from. This publication is the copyrighted property of Colliers and /or its licensor(s). © 2025. All rights reserved. This communication is not intended to cause or induce breach of an existing listing agreement. Colliers | Alabama.

Colliers | Alabama
880 Montclair Road, Suite 250
Birmingham, AL 35213
+1 205 445 0955 main
colliers.com