

"TRIANGLE PLAZA"

PARTS OF THE N.E. 1/4 & S.E. 1/4 OF SECTION 4, T.2N., R.12E.,
CITY OF STERLING HEIGHTS, MACOMB COUNTY, MICHIGAN.

LIBER PAGE

SHEET 1 OF 3 SHEETS
NORTHEAST CORNER OF
SECTION 4, T.2N., R.12E.

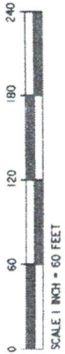

PLAT LEGEND
ALL DIMENSIONS ARE IN FEET
ALL CURVILINEAR DIMENSIONS ARE SHOWN ALONG THE ARC.
THE SYMBOL "O" INDICATES A MONUMENT WHICH IS A 1 1/2" DIAMETER
STEEL PIN OR AN IRON PIPE 1/2" IN DIAMETER WITH A CAP.
ALL BEARINGS ARE IN RELATION TO THE BEARINGS OF THE
SOUTH LINE OF RIVER VIEW GARDENS SUB. NO. 2 AS RECORDED IN
LIBER 20, PAGE 27, M.C.R.
BU DENOTES BOUNDARY.

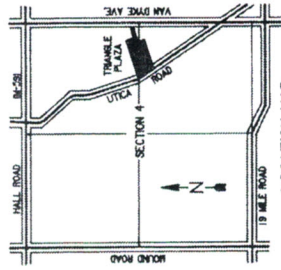

UNPLATTED

RADIUS = 486.73
ARC = 47.57
DELTA = 05°35'57"
CHORD = 47.55
CH. BRG. = N 75°11'29" E

RADIUS = 486.73
ARC = 41.70
DELTA = 05°35'57"
CHORD = 41.69
CH. BRG. = S 75°11'29" W

NO.	RADIUS	ARC	DELTA	CHORD	BEARING
1	486.73	47.57	05°35'57"	47.55	N 75°11'29" E
2	486.73	41.70	05°35'57"	41.69	S 75°11'29" W
3	180.00	15.33	04°52'44"	15.32	N 74°49'52" E
4	180.00	10.22	04°52'44"	10.22	N 74°49'52" E
5	180.00	73.94	23°32'04"	73.42	N 65°30'12" E
6	180.00	49.29	23°32'04"	48.95	N 65°30'12" E

THE PLAT IS SUBJECT TO RESTRICTIONS AS REQUIRED BY THE STATE OF MICHIGAN, AND THE DEPARTMENT OF NATURAL RESOURCES AND THE MICHIGAN DEPARTMENT OF PUBLIC HEALTH, WHICH ARE HEREBY REFERRED TO BY REFERENCE TO THE RECORDS OF THIS COUNTY.

FLOOD PLAIN CONTOUR AS ESTABLISHED BY THE DEPARTMENT OF NATURAL RESOURCES (ELEVATION 823.00 / NGV DATUM 1)

Donald W. Beattie



NOTE: THERE SHALL BE NO DIRECT VEHICULAR ACCESS TO UTICA ROAD FROM LOTS 8 AND 9.

60825

MCS ASSOCIATES, INC.
CIVIL ENGINEERING & SURVEYING
STERLING HEIGHTS, MICHIGAN 48310