

Georgetown Shopping Center

S IH 35 Service Rd & Jesse Cocke Dr
Georgetown, TX 78628
www.cbre.com

14,600 SF

Retail Outparcel
Building

Property Details

- + Great visibility from IH-35
- + Next to Costco and Lowe's Home Improvement (currently under construction)
- + Easy access to I-35
- + Minutes from Georgetown Town Center

Retail Opportunity Available in Proposed Shopping Center



Georgetown Outparcel Building

S IH 35 Service Rd & Jesse Cocke Dr | Georgetown, TX 78628

For Lease

Close Up Aerial Georgetown Pad

2201a I-35 | Georgetown, TX 78628



© 2022 CBRE, Inc. All rights reserved. This information has been obtained from sources believed reliable, but has not been verified for accuracy or completeness. You should conduct a careful, independent investigation of the property and verify all information. Any reliance on this information is solely at your own risk. CBRE and the CBRE logo are service marks of CBRE, Inc. All other marks displayed on this document are the property of their respective owners, and the use of such logos does not imply any affiliation with or endorsement of CBRE. 08/15/2023 420020

Georgetown Outparcel Building

S IH 35 Service Rd & Jesse Cocke Dr | Georgetown, TX 78628

For Lease

High Aerial Georgetown Pad

2201a I-35 | Georgetown, TX 78628

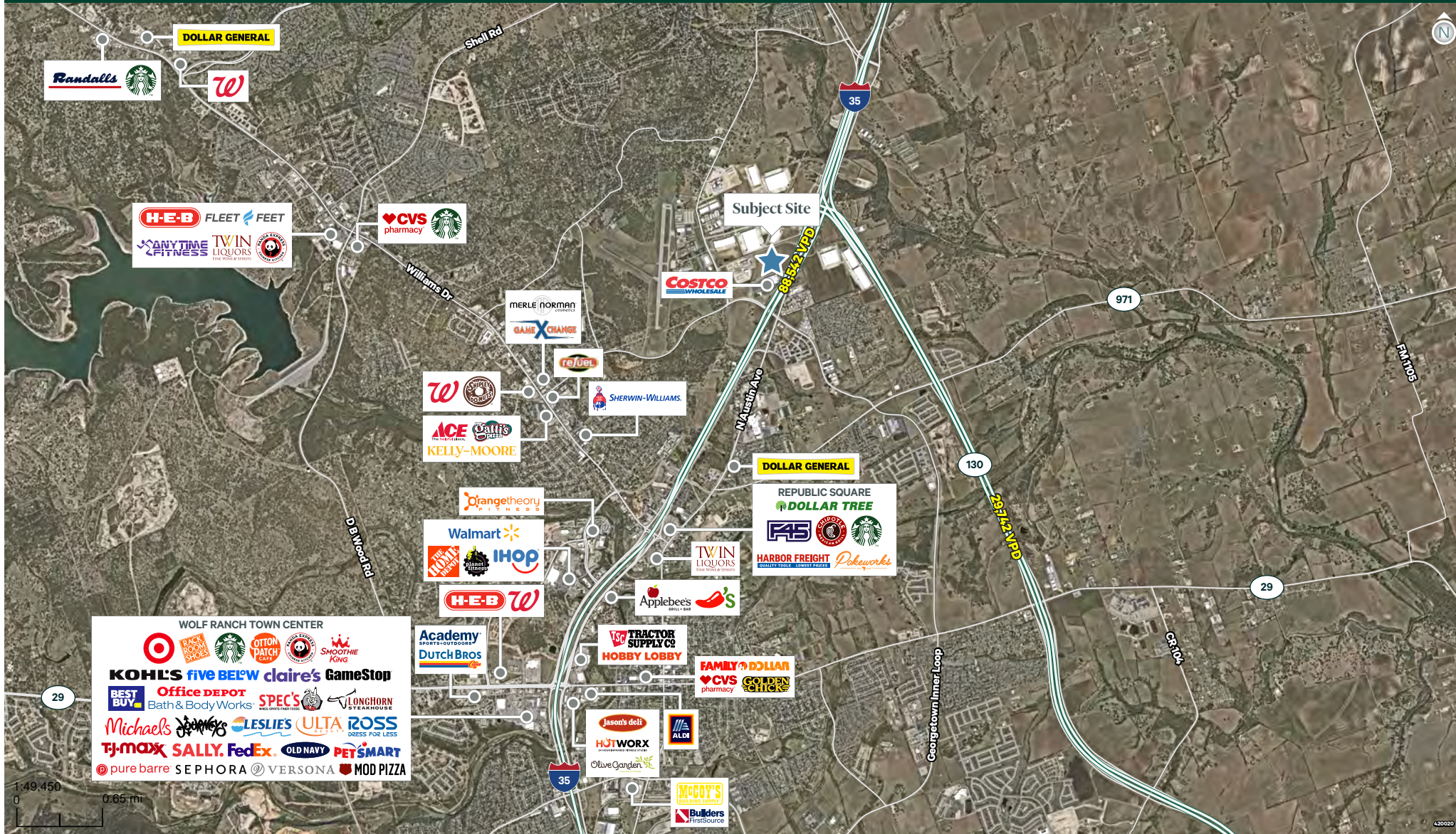

Georgetown Outparcel Building

S IH 35 Service Rd & Jesse Cocke Dr | Georgetown, TX 78628

For Lease

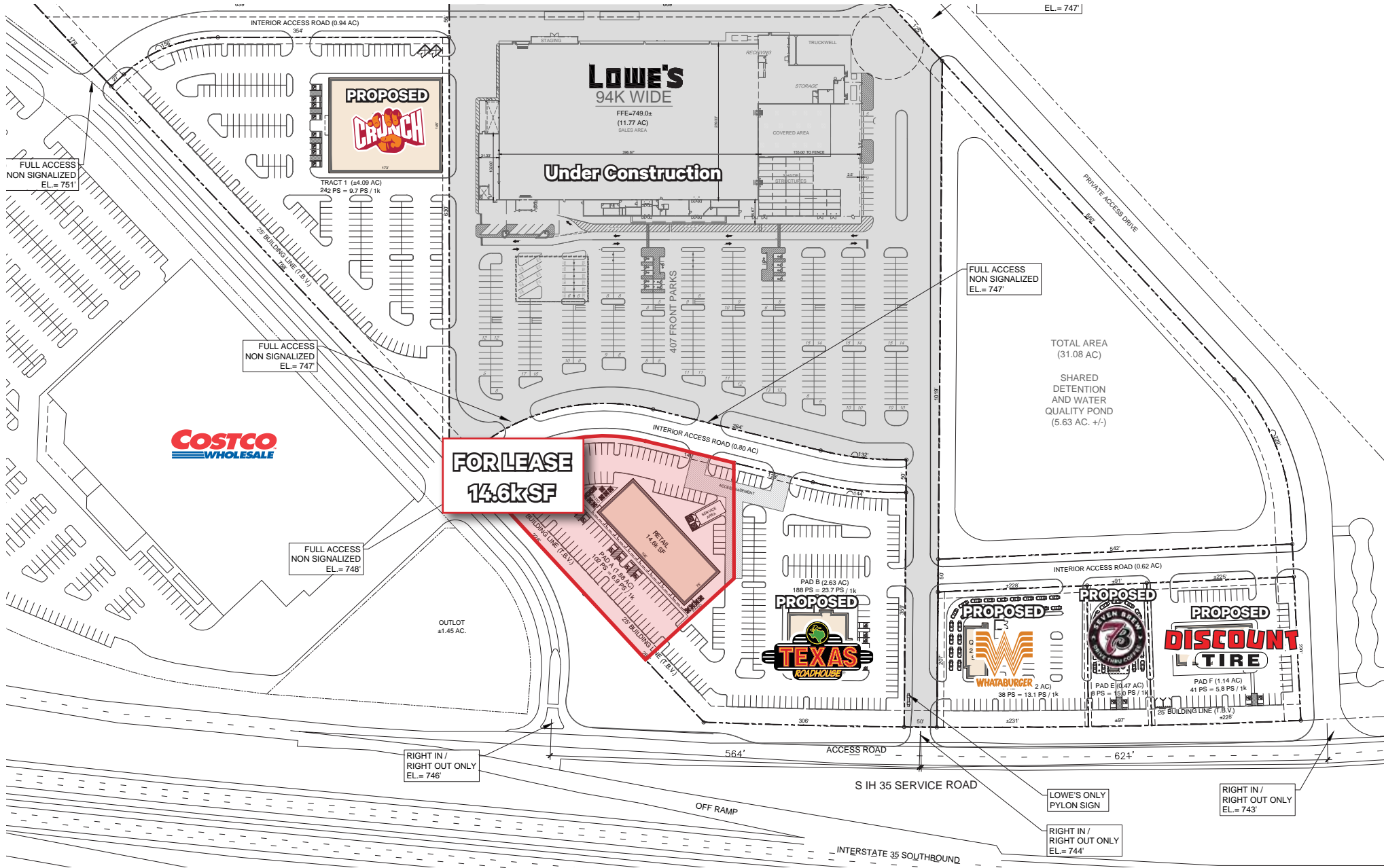

Georgetown Outparcel Building

S IH 35 Service Rd & Jesse Cocke Dr | Georgetown, TX 78628

For Lease

2024 Demographics

Miles	3	5	7
Population	31,778	76,125	114,837
Daytime Population	29,782	77,225	106,717
Median Age	41.8	45.2	44.6
Average Household Income	\$132,295	\$130,453	\$138,089
Average Household Size	2.41	2.37	2.46
Businesses	1,255	2,760	3,234
Employees	11,311	28,709	32,728

Traffic Counts

I-35	91,794 VPD
Lakeway Drive	8,840 VPD

Year: 2022

Source: Traffic Counts USA



Contact Us

Will Majors

Senior Vice President
512 482 5597
will.majors@cbre.com

Carson Hawley

Vice President
512 482 5601
carson.hawley@cbre.com

www.cbre.com

© 2024 CBRE, Inc. All rights reserved. This information has been obtained from sources believed reliable, but has not been verified for accuracy or completeness. You should conduct a careful, independent investigation of the property and verify all information. Any reliance on this information is solely at your own risk. CBRE and the CBRE logo are service marks of CBRE, Inc. All other marks displayed on this document are the property of their respective owners, and the use of such logos does not imply any affiliation with or endorsement of CBRE. Photos herein are the property of their respective owners. Use of these images without the express written consent of the owner is prohibited.