

601 E JEFFERSON STREET LOUISVILLE, KY 40202



# TURNKEY RESTAURANT



## TURNKEY RESTAURANT IN NULU FOR LEASE

### PROPERTY HIGHLIGHTS

Amazing opportunity in the heart of Louisville's vibrant NuLu neighborhood! This turnkey restaurant boasts 3,128 square feet of meticulously designed space, ready to bring your vision to life. Equipped with everything you need to hit the ground running, from state-of-the-art kitchen appliances and everything in between, this establishment is poised to become the next hotspot for food enthusiasts.

Located in the bustling NuLu district, known for its eclectic mix of dining establishments and cultural attractions, this restaurant enjoys prime visibility and foot traffic, promising a steady stream of patrons eager to explore the culinary delights it has to offer.



# AREA LOCATION



## Proximities

Strolling through Nulu, you'll encounter beautifully restored historic buildings alongside contemporary architecture, creating a unique juxtaposition of old and new. The streets are lined with colorful murals, adding to the neighborhood's artsy vibe.

Nulu is a haven for foodies, offering an array of dining options ranging from farm-to-table eateries to international cuisine. It's also a hotspot for locally-owned boutiques, art galleries, and specialty stores, making it a favorite destination for shoppers seeking one-of-a-kind finds.

Overall, Nulu's proximity to downtown Louisville, coupled with its trendy ambiance and diverse offerings, make it a must-visit destination for anyone exploring the vibrant culture of Kentucky's largest city.



## FEATURING:

- Located in the heart of Louisville's NuLu neighborhood
- 3,128 RSF
- Turnkey Restaurant
- \$30/PSF



## PROPERTY INFORMATION

**Property Type:** RETAIL/COMMERCIAL  
**Lease Type:** NNN  
**Lease Rate:** \$30 PSF

**MSA:** LOUISVILLE/JEFFERSON COUNTY  
**Total Availability:** 3,128 RSF  
**Parking:** STREET PARKING AVAILABLE

# FLOOR PLAN

601 E JEFFERSON STREET LOUISVILLE, KY 40202

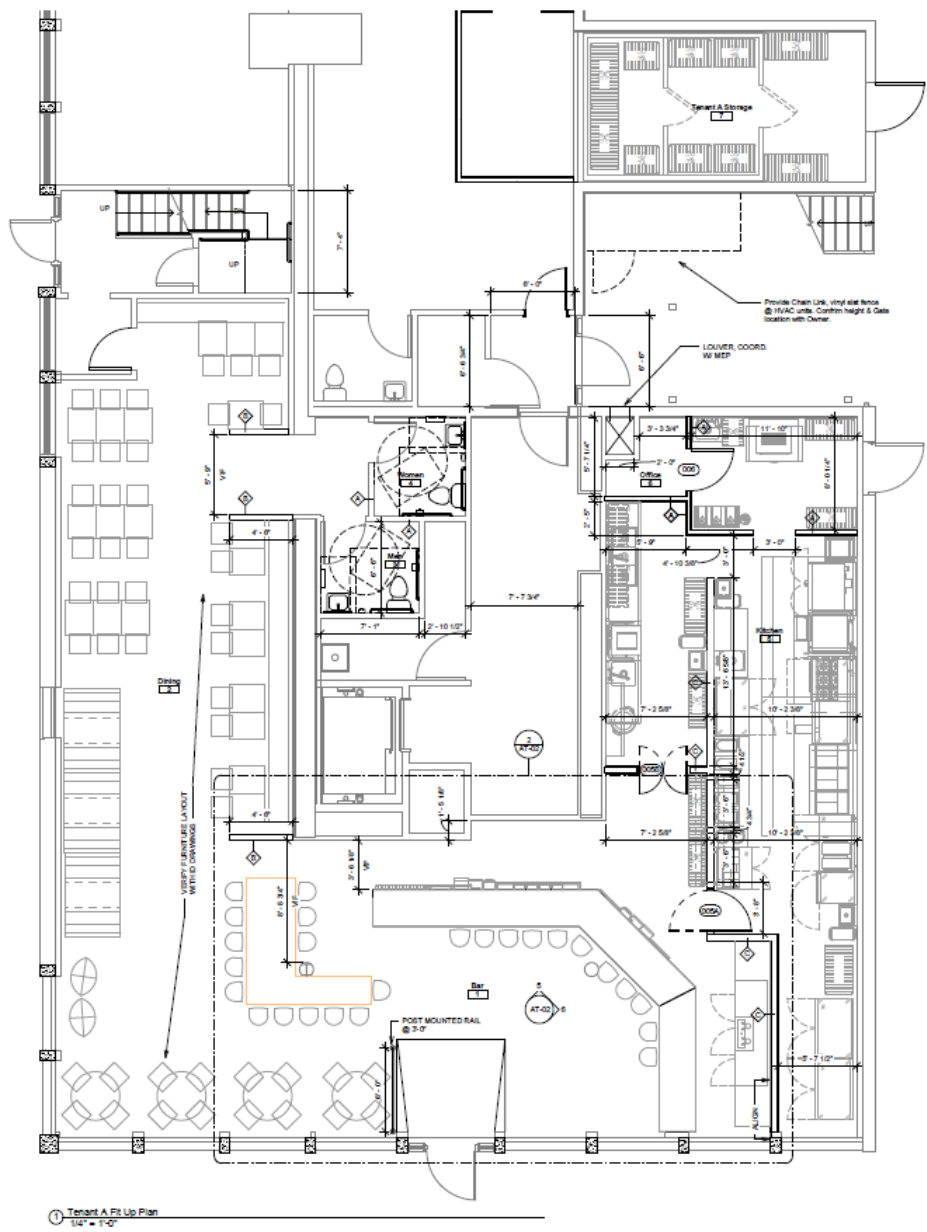

## AVAILABLE SPACE

- 3,128 RSF



# PROPERTY CONTACTS:

CORE Real Estate Partners



**ALEX ZEGA**

Leasing & Sales Associate  
alex@core502.com  
502-550-0408



**LEE WEYLAND, CCIM**

Partner  
lee@core502.com  
502-387-2476

## ABOUT US

Founded in Louisville, KY, CORE Real Estate Partners utilize a data-driven approach to provide comprehensive and unique full-service solutions for our clients' real estate needs. CORE specializes in urban, near-urban areas and town-centers, for long term commercial real estate strategies and solutions.

Our collaborative approach attracts clients who understand and appreciate the benefits of long-term real estate investment to grow income producing assets. With more than 55 years of combined real estate experience in Louisville, we incorporate technology and entrepreneurship into our strategy to enhance the real estate investment results for our partners.

Learn more about this property and CORE Real Estate Partners at: [core502.com](https://core502.com)