

FOR LEASE

OFFICE BUILDING



JOYAL CAPITAL MANAGEMENT BUILDING

50 RESNIK RD, PLYMOUTH, MA 02360-7220

For More Information

DAVE ELLIS

781.919.0800 x701
dave@ellisrealtyadvisors.com



JOYAL CAPITAL MANAGEMENT BUILDING

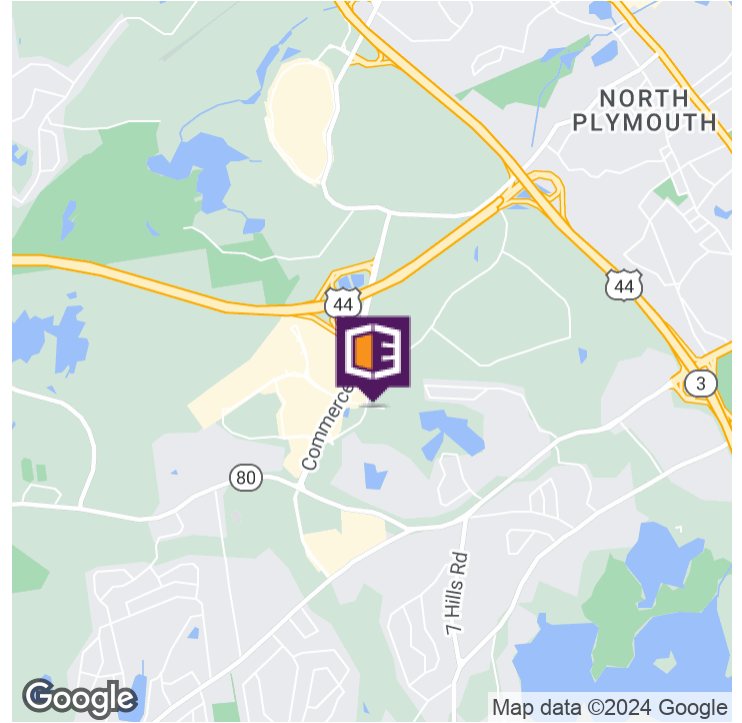

OFFERING SUMMARY

Lease Rate:	\$25.00 SF/yr (MG)
Building Size:	23,430 SF
Available SF:	3,250 SF
Lot Size:	2.58 Acres
Year Built:	1999
Zoning:	LI
Market:	Boston
Submarket:	Route 3 South

PROPERTY OVERVIEW

Updated common areas featuring a recently renovated professional conference center and a fully-equipped kitchen. The building's high-end fixtures and finishes take center stage in the impressive 3-story atrium. Enjoy 24-hour secure access to the building for added convenience and peace of mind.

Conveniently situated within walking distance to the commuter rail shuttle and in close proximity to the intersection of Route 3 and Route 44, our location ensures easy accessibility from Boston, the Cape, and points west. This Class A Building seamlessly combines functionality with a touch of luxury.

PROPERTY HIGHLIGHTS

- Walking distance to Routes 3, 44, 80 and Commuter Rail. Shuttle bus availability
- Bus Line
- Food Service
- Conferencing Facility
- Security System

JOYAL CAPITAL MANAGEMENT BUILDING

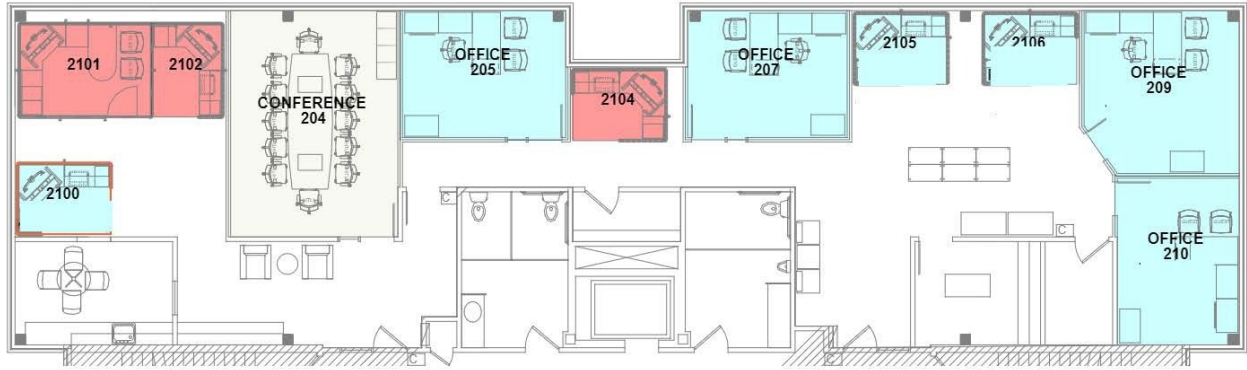

LEASE TYPE MG | TOTAL SPACE 3,250 SF | LEASE TERM NEGOTIABLE | LEASE RATE \$25.00 SF/YR

SUITE	TENANT	SIZE	TYPE	RATE	DESCRIPTION
-------	--------	------	------	------	-------------

ADDITIONAL PHOTOS

JOYAL CAPITAL MANAGEMENT BUILDING



DAVE ELLIS

781.919.0800 x701
dave@ellisrealtyadvisors.com

JOYAL CAPITAL MANAGEMENT BUILDING

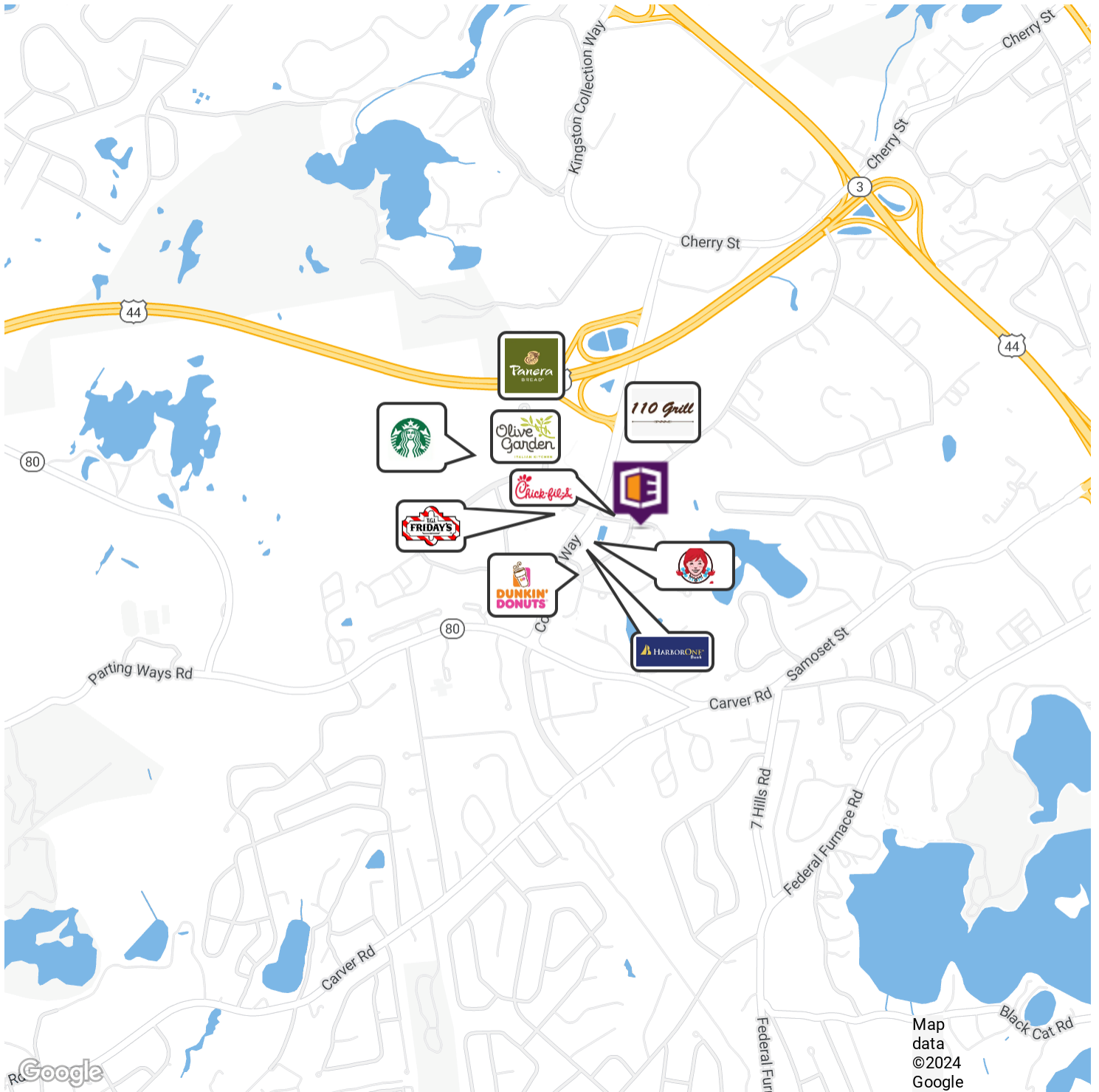

JOYAL CAPITAL MANAGEMENT BUILDING

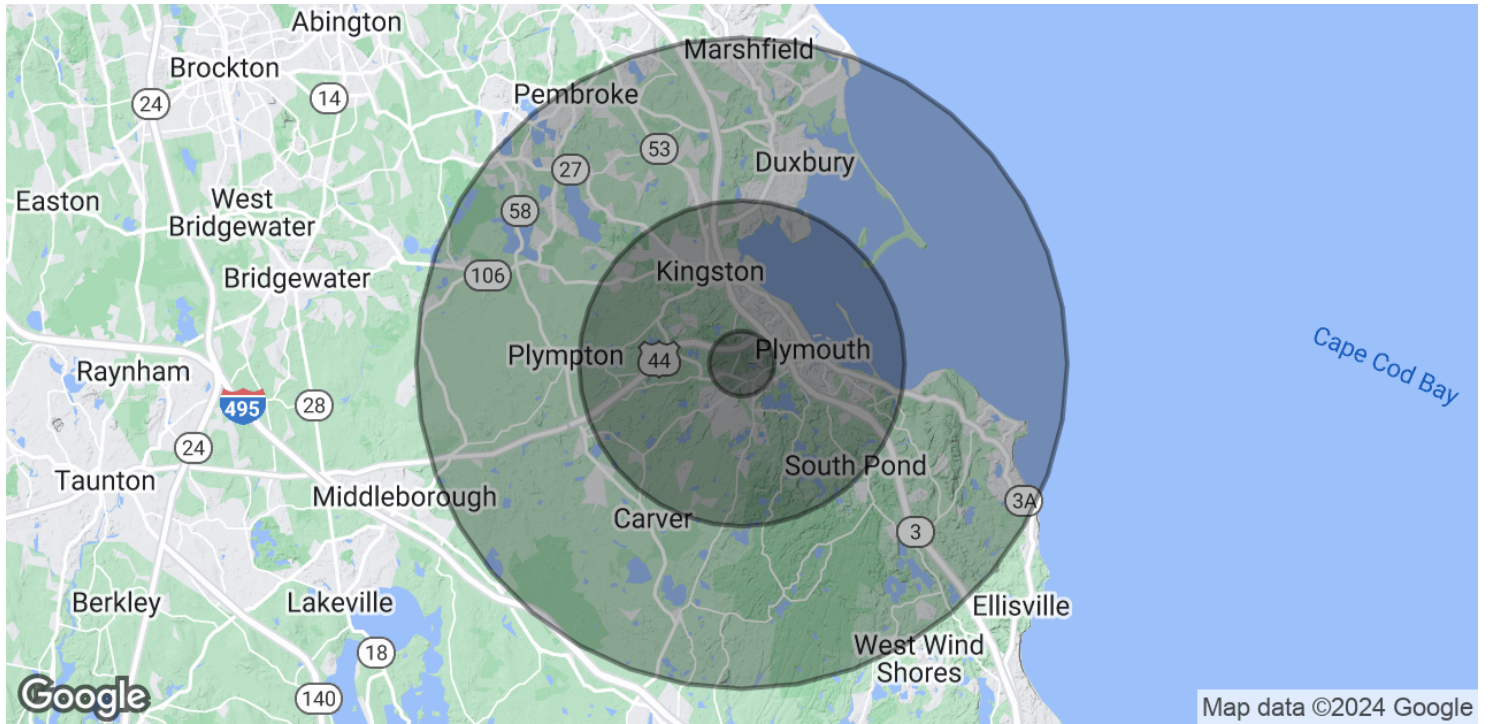

POPULATION	1 MILE	5 MILES	10 MILES
Total Population	2,684	40,915	107,383
Median age	43.0	41.9	41.9
Median age (Male)	41.3	40.8	40.8
Median age (Female)	44.0	42.9	42.7
HOUSEHOLDS & INCOME	1 MILE	5 MILES	10 MILES
Total households	1,046	15,556	39,373
# of persons per HH	2.6	2.6	2.7
Average HH income	\$88,311	\$93,066	\$98,093
Average house value	\$321,134	\$405,273	\$431,686

* Demographic data derived from 2020 ACS - US Census