



2,090± SF Medical Office

7350 Sand Lake Commons Blvd. | Orlando, FL
MedPlexB – Suite 1115

Class A Medical Office

MEDICAL/OFFICE FOR LEASE

Contact Us

Chris Alders

Vice President
+1 407 362 6142
chris.alders@colliers.com



Floor Plan

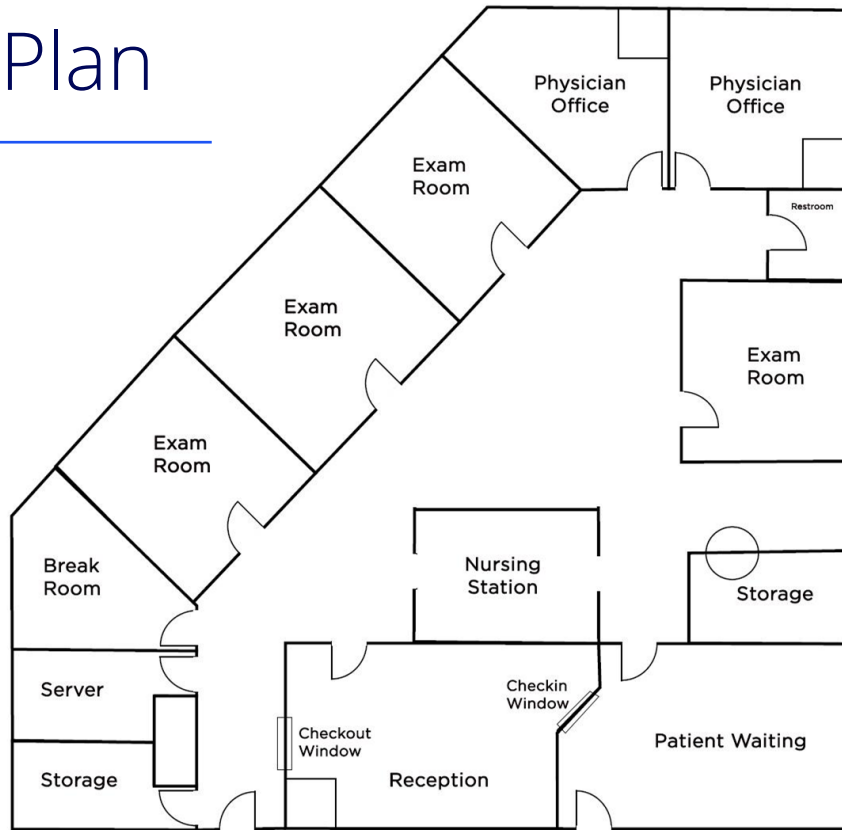

Property Highlights

- 2,090± SF medical office for lease
- Located on the campus of Orlando Health's Dr. Phillips Hospital
- Features high-end interior finishes
- Fully move-in ready
- Includes four exam rooms and two private physician offices
- Designed for efficient patient flow with dedicated check-in and check-out windows
- Building tenants include Primary Care, Pediatric Gastroenterology, Orthopedics, Rehabilitation Services, and more



Area Demographics



Population

1-Mile: 4,536
3-Mile: 54,241
5-Mile: 158,851



Daytime Population

1-Mile: 15,166
3-Mile: 103,405
5-Mile: 249,117



Average HH Income

1-Mile: \$169,955
3-Mile: \$138,158
5-Mile: \$117,021



Households

1-Mile: 1,908
3-Mile: 21,661
5-Mile: 59,953

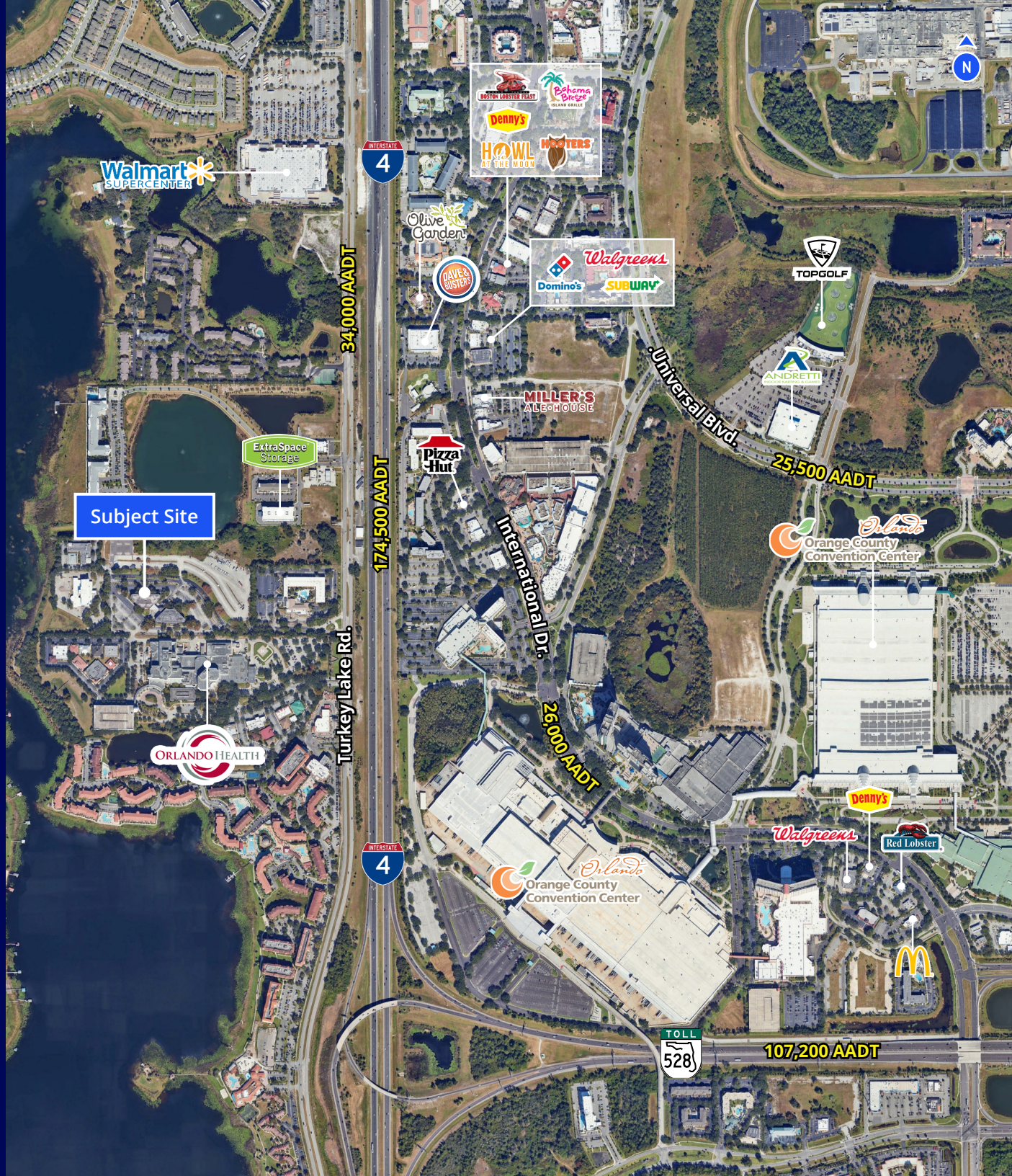



Chris Alders

Vice President
+1 407 362 6142
chris.alders@colliers.com



Colliers
255 S Orange Ave #1300
Orlando, FL 32801

This document has been prepared by Colliers International for advertising and general information only. Colliers International makes no guarantees, representations or warranties of any kind, expressed or implied, regarding the information including, but not limited to, warranties of content, accuracy and reliability. Any interested party should undertake their own inquiries as to the accuracy of the information. Colliers International excludes unequivocally all inferred or implied terms, conditions and warranties arising out of this document and excludes all liability for loss and damages arising there from. This publication is the copyrighted property of Colliers International and/or its licensor(s). ©2025. All rights reserved.