

VOLTA
ELECTRIC
BLOCKS

**Death to
soul-crushing
workspaces.**

1705 SE 3RD AVE PORTLAND, OR





VOLTA



HIGHWIRE



NOVA



GROUNDWIRE



SKYLIGHT

Volta is part of the Electric Blocks—a network of five flexible buildings in Portland’s Central Eastside where creativity and innovation flow freely.

**We can flex,
so you can pivot.**

Your business will grow. Wouldn't it be great if your workplace could grow with it? At the Electric Blocks you've got options to grow and pivot as your business does.

- 350,000+ total RSF across 5 buildings
- 50,000+ RSF of outdoor terraces with views
- 500+ parking spaces
- 350+ secured bike parking spaces

THEELECTRICBLOCKS.COM



Calling all visionaries.

Vintage buildings have real character that once destroyed can never be replaced. When we saw the soaring wooden ceilings and exposed trusses of the former warehouse that would one day become Volta, we had to restore it to its former glory and then some. Overflowing with natural light, Volta preserves the original character and accents while bringing in cutting-edge sustainable design and integrated art to create a workspace where bright ideas run wild.

**Craft your
vision here.**

This wasn't a restoration, it was a reinvention. The roof, walls, and windows were designed in harmony to make Volta a high-efficiency building for the future.

It's all in the details.

EXPANSIVE, OPERABLE WINDOWS
PRESERVED AND EXPOSED TIMBER ROOF
15 TO 20-FOOT CEILING HEIGHTS
TARGETING LEED PLATINUM
TARGETING PATH TO NET-ZERO
TOUCH-LESS BIKE GATE AND DOOR ACCESS
HVAC SYSTEM EQUIPPED WITH MERV FILTERS





Imagine
your company in
Portland's most
creative neighborhood.

Volta is alive with energy.

The Central Eastside is perfectly located, minutes from Downtown, along the edge of the Eastbank Esplanade, and at the center of Portland's burgeoning Mural District. Volta is just where you want it to be.

The Electric Blocks hosts some of the city's best outdoor markets and events and is home to an open-air, public art gallery boasting 100+ rotating murals.



Nine-to-five with soul.

It takes endless inspiration if you want to change the world - and a few like-minded people who believe they can do it. In Volta at the Electric Blocks, you will find a whole neighborhood designed to bring visionary minds together.

BUILDING HIGHLIGHTS

30,000 square feet of
Class A workspace

15 secured
parking spaces

30+ secured bike
parking spaces

Multiple outdoor
terraces

Showers & lockers
with towel service

Electric vehicle
charging stations

Gender-neutral
restrooms

Highly-visible signage
opportunities
for tenants

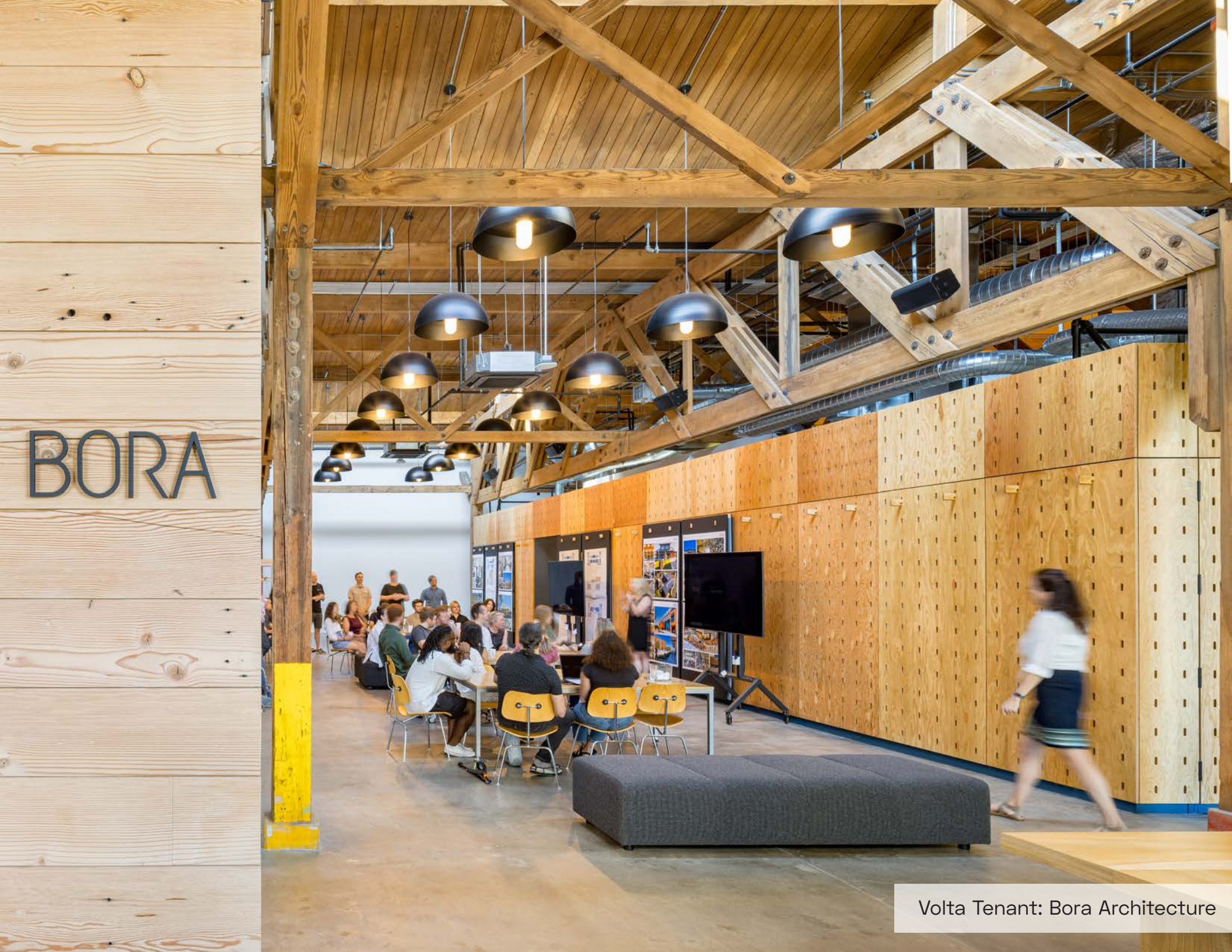

BORA

Volta Tenant: Bora Architecture

The Electric Blocks -
Our 350,000 SF Central
Eastside portfolio makes
it easy to scale with ample
expansion opportunities.

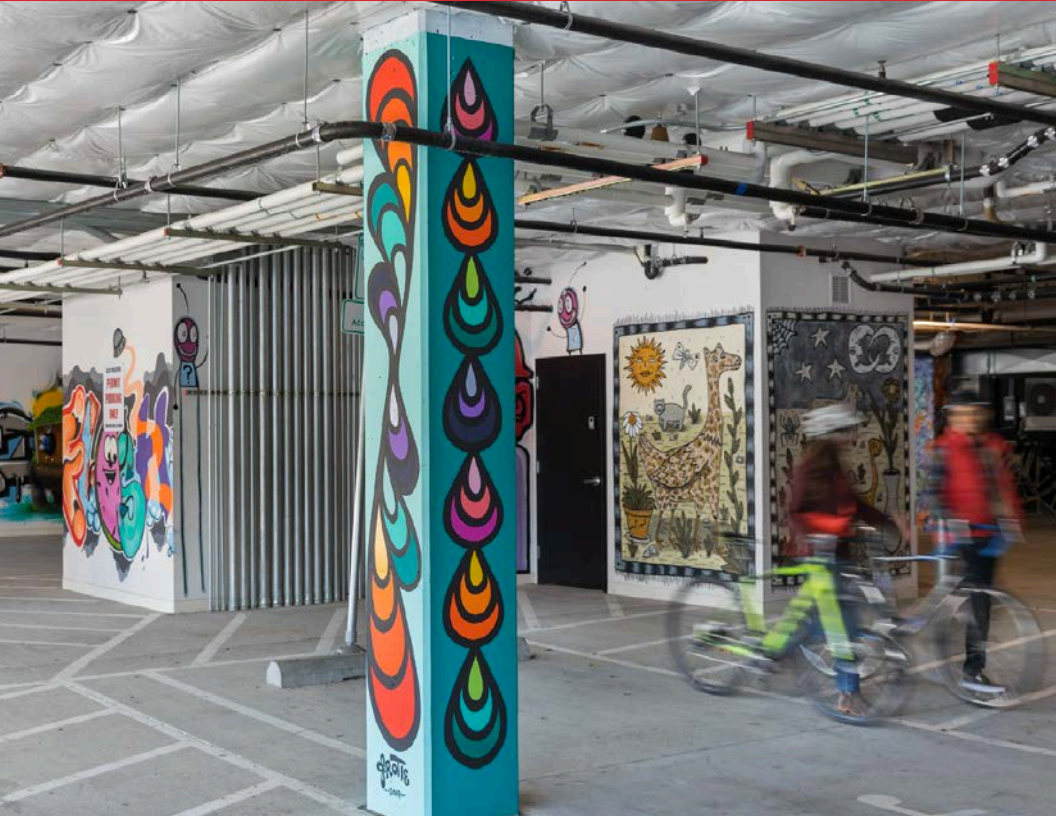

THE NEIGHBORHOOD

45+ Restaurants/bars

20+ Retail shops

10+ Coffee shops

15+ Breweries

10-min to MAX Orange Line

10-min to Downtown

5-min to Streetcar on Grand Ave.

5-min to Eastbank Esplanade

5-min to Hawthorne Bridge



VOLTA

Level One

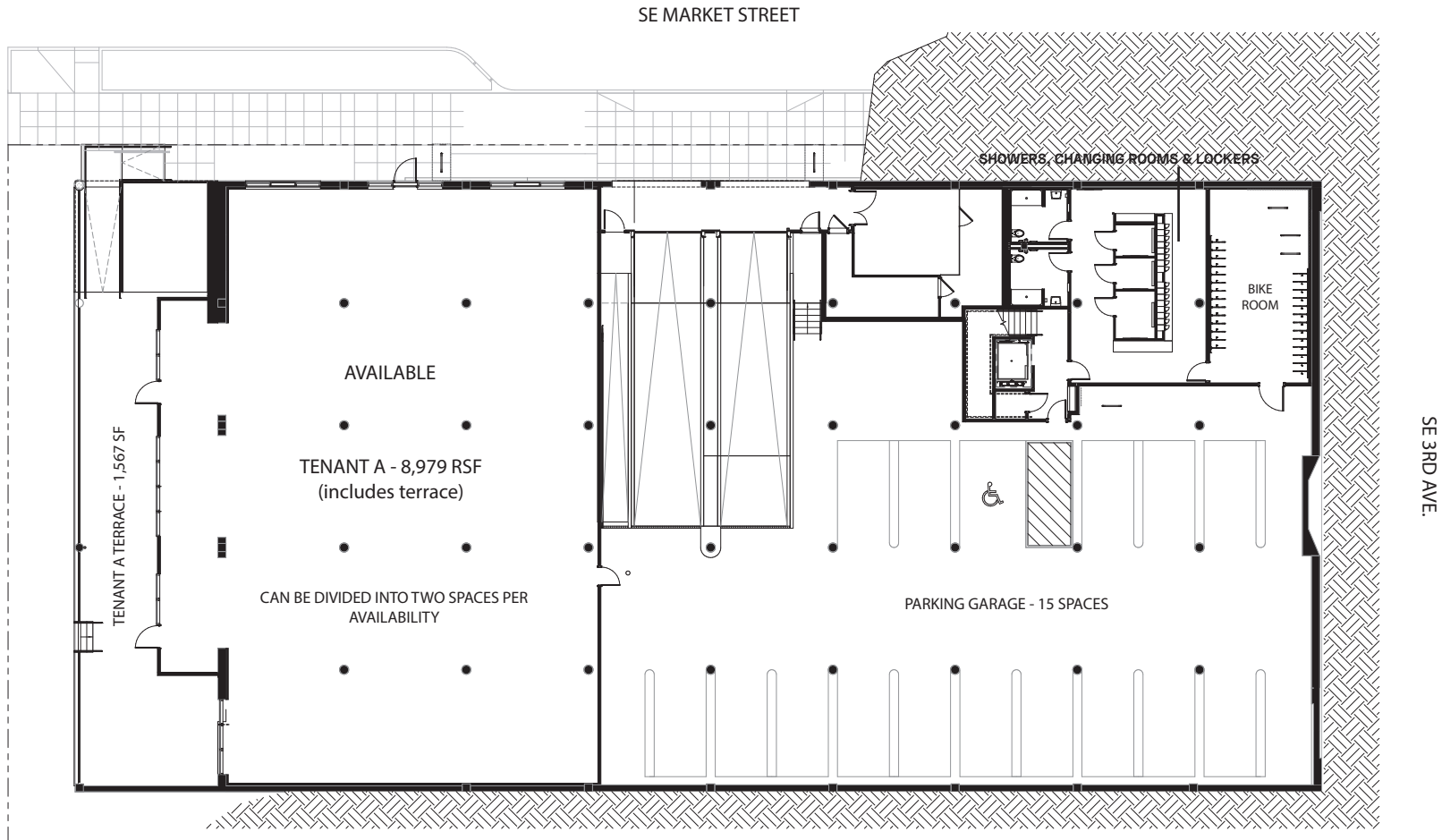

Level Two

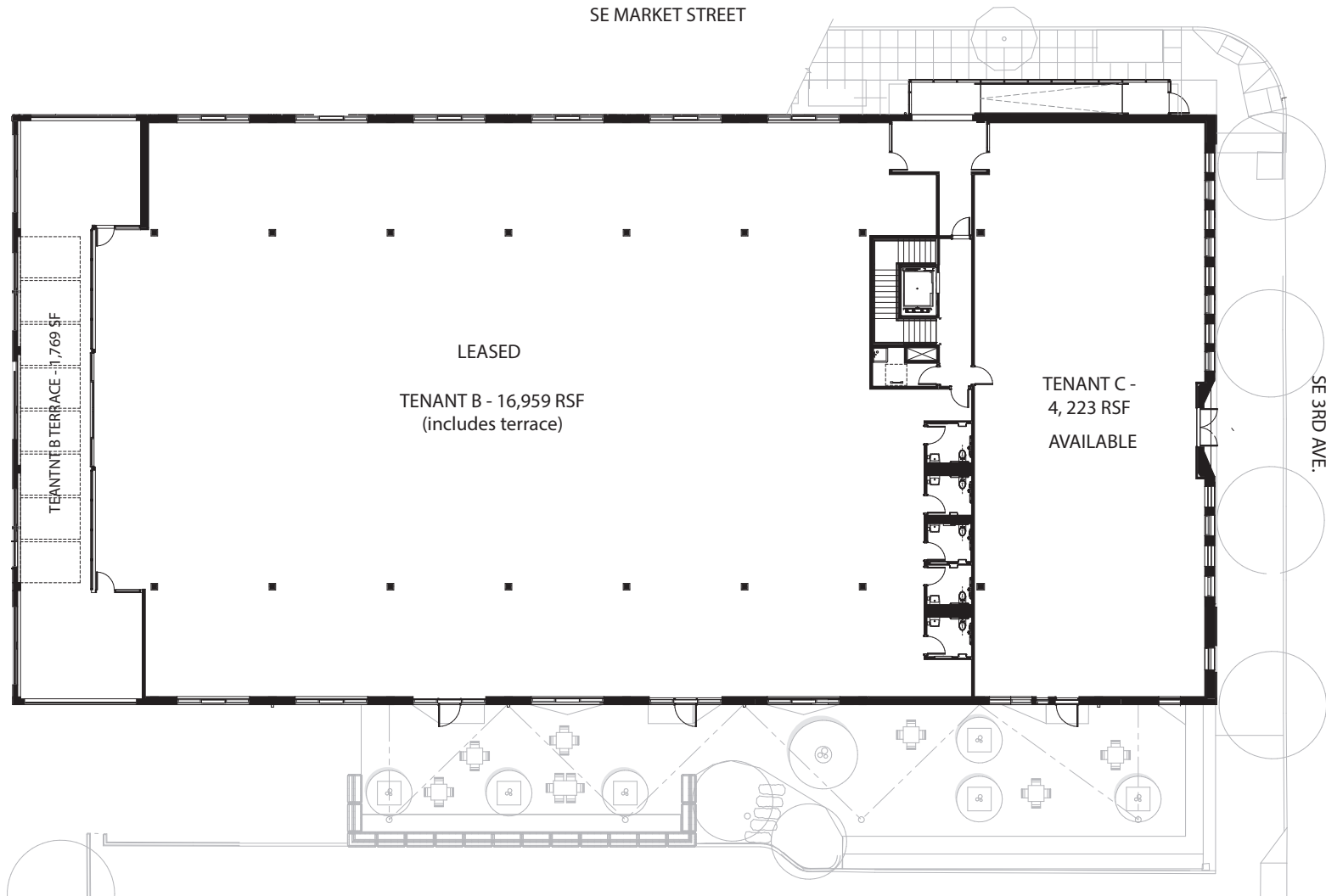



Start your future in Volta at the Electric Blocks today.

THEELECTRICBLOCKS.COM/VOLTA

PAUL ANDREWS

Broker

503.546.4542

pmandrews@melvinmark.com

BRYN HOKKANEN

Broker

503.546.4534

bhokkanen@melvinmark.com

NICOLE ONDER

Broker/Property Manager

503.546.4540

nonder@melvinmark.com

Volta

Once an electrical warehouse,
Volta has been reimagined as a
light-filled haven of inspiration
and possibility.

AVAILABILITY

Now Leasing

VOLTA
ELECTRIC
BLOCKS

**Death to
soul-crushing
workspaces.**

1705 SE 3RD AVE PORTLAND, OR

KILLIAN PACIFIC



MELVIN MARK
EST. 1945