

AVAILABLE FOR LEASE

3550 179TH STREET, HAMMOND, IN 46323



∞
1788 HOLDINGS



PROPERTY DESCRIPTION

One of the most sought-after locations in Northwest Indiana, this 77,450 square foot Industrial building sits on 7.81 Acres of land.

LOCATION DESCRIPTION

- Prime N/W Indiana Location
- I-80/94 Exposure
- ± 200,000 vehicles per day
- 5 miles to Illinois Border

PROPERTY HIGHLIGHTS

- Ample parking with dedicated outside storage/trailer parking
- Professionally owned and managed
- Zoned Industrial
- Multi-Tenant building

| SPACES | LEASE RATE | SPACE SIZE |
|--------|------------|---------------------------|
| Unit A | STO | 10,315 SF |
| Unit B | STO | 10,750 SF |
| Unit G | STO | 10,275 SF - LEASED |

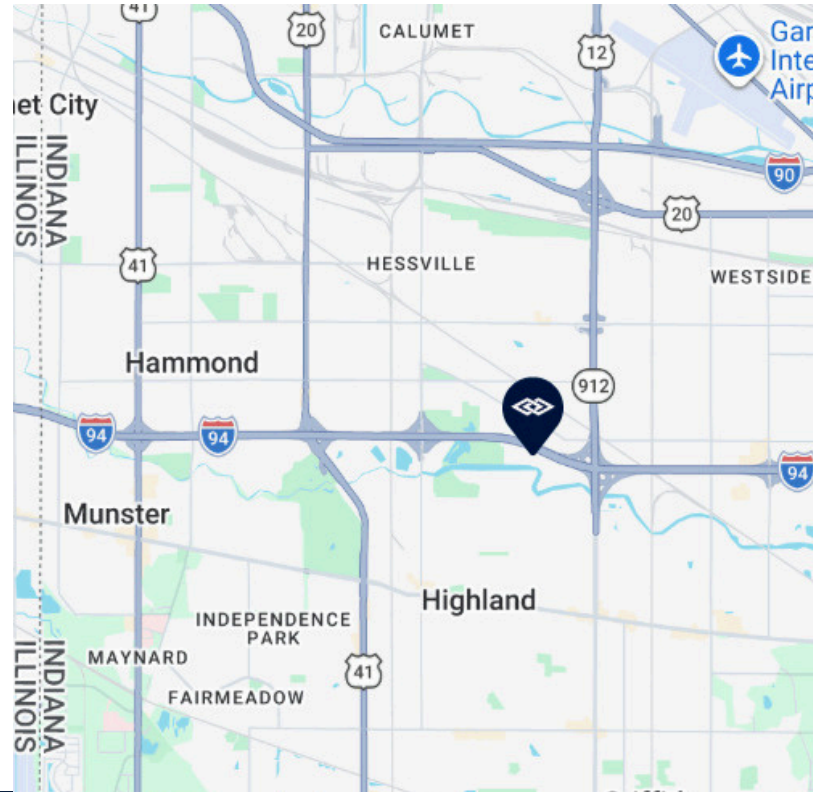

TERRY LYNCH, SIOR | Vice President | 773.714.2142 | tlynch@darwinpw.com
EDWARD WABICK, SIOR | Principal | 708.220.5539 | ewabick@darwinpw.com



AVAILABLE FOR LEASE

3550 179TH STREET, HAMMOND, IN 46323



DARWINPW

R E A L T Y



1788 HOLDINGS

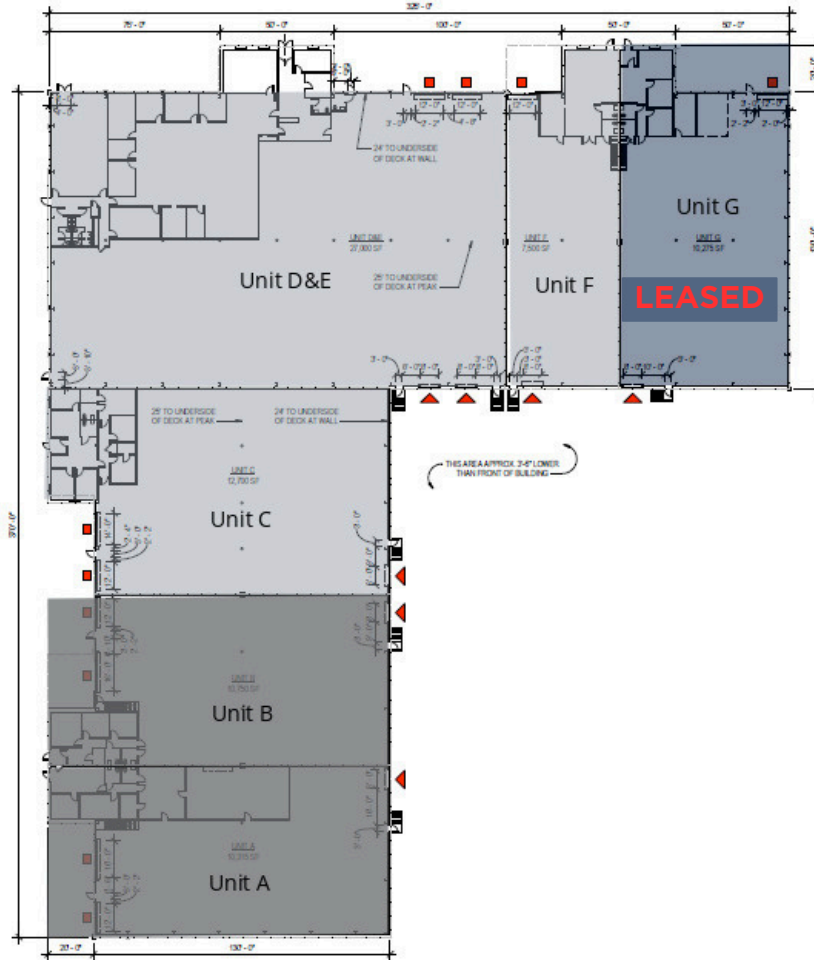

LEGEND

- Available
- Available Soon
- Unavailable

AVAILABLE SPACES

| SUITE | SIZE | RATE | DESCRIPTION |
|----------|-----------|------|---------------------------------------------------------------------------------|
| ■ Unit A | 10,315 SF | STO | 2 DIDs (14'h), 1 Exterior Dock, 18' clear, ± 2625 SF office, 200 Amps, 120/208V |
| ■ Unit B | 10,750 SF | STO | 2 DIDs (14'h), 1 Exterior Dock, 18' clear, ± 1000 SF office, 200 Amps, 120/208V |
| ■ Unit G | 10,275 SF | STO | 1 DID (14'h), 1 Exterior Dock, 22' clear, ± 1050 SF office - LEASED |

TERRY LYNCH, SIOR | Vice President | 773.714.2142 | tlynch@darwinpw.com
EDWARD WABICK, SIOR | Principal | 708.220.5539 | ewabick@darwinpw.com



AVAILABLE FOR LEASE

3550 179TH STREET, HAMMOND, IN 46323



DARWINPW
REALTY



1788 HOLDINGS



Map data ©2026 Imagery ©2026 Airbus, Maxar Technologies,

TERRY LYNCH, SIOR | Vice President | 773.714.2142 | tlynch@darwinpw.com
EDWARD WABICK, SIOR | Principal | 708.220.5539 | ewabick@darwinpw.com



AVAILABLE FOR LEASE

3550 179TH STREET, HAMMOND, IN 46323

 **DARWINPW**
R E A L T Y

1788 HOLDINGS

UNIT B



UNIT A



UNIT A



UNIT B

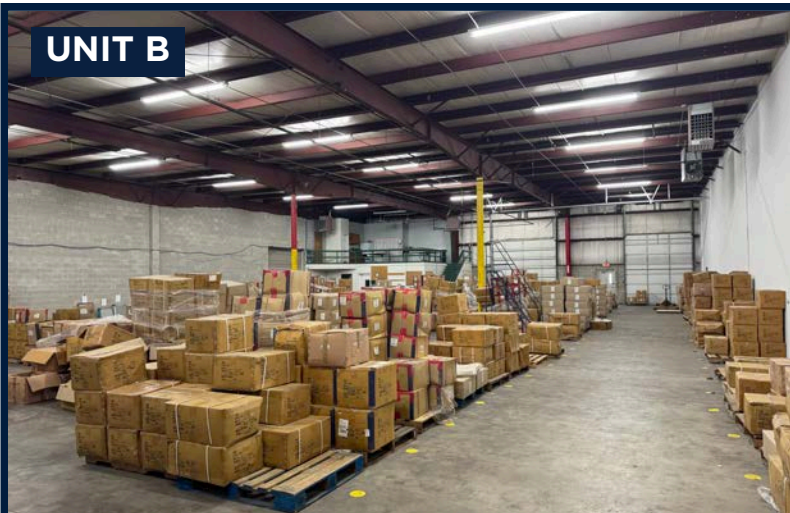

UNIT A

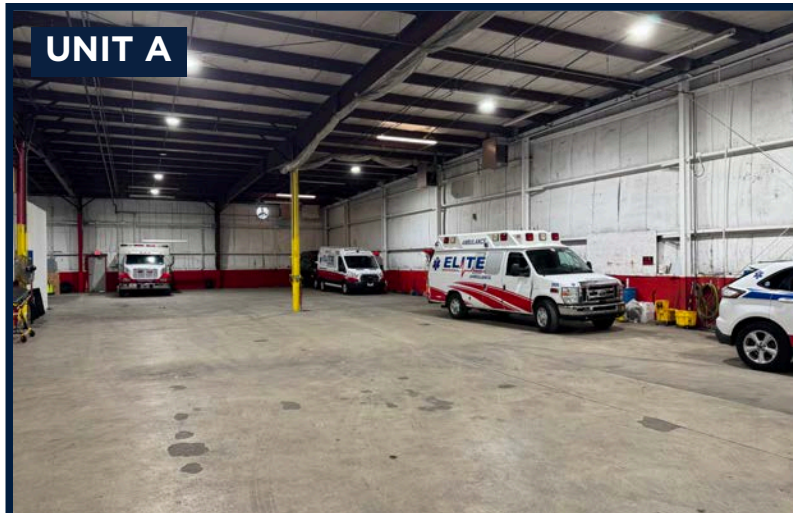

TERRY LYNCH, SIOR | Vice President | 773.714.2142 | tlynch@darwinpw.com
EDWARD WABICK, SIOR | Principal | 708.220.5539 | ewabick@darwinpw.com

