

A large, modern aircraft hangar with a light grey metal exterior and four large blue roll-up doors. The hangar is situated on a paved airfield under a blue sky with scattered clouds. The image features decorative blue and green wavy lines in the background.

KENOSHA REGIONAL
AIRPORT HANGAR

4123 91ST AVENUE, KENOSHA, WISCONSIN

KENOSHA REGIONAL AIRPORT

±14,464 SF AIRCRAFT HANGAR FACILITY FOR SALE

CBRE



KENOSHA REGIONAL
AIRPORT HANGAR

CBRE is pleased to offer an approximately 14,464 SF aircraft hangar and office facility for sale at the Kenosha Regional Airport. Completed in 2023, this facility features an approximately 12,000 SF hangar bay, as well as office space, ramp/apron area, and garage parking.

The owner has secured approval for a fuel farm on the property, making this an excellent opportunity for a private flight department or aviation-related businesses.

PRICE

\$4,200,000.00

HIGHLIGHTS

- ↗ ±12,000 SF hangar bay
- ↗ Hangar Bay Dimensions: 120' x 100'
- ↗ Hangar Door Dimensions: 28'11" tall x 110' wide
- ↗ ±2,464 SF office space
- ↗ Completed in 2023
- ↗ Ground lease term through October 21, 2046 with extension term available
- ↗ Pre-approved for a fuel farm
- ↗ Garage parking





FLOOR PLANS

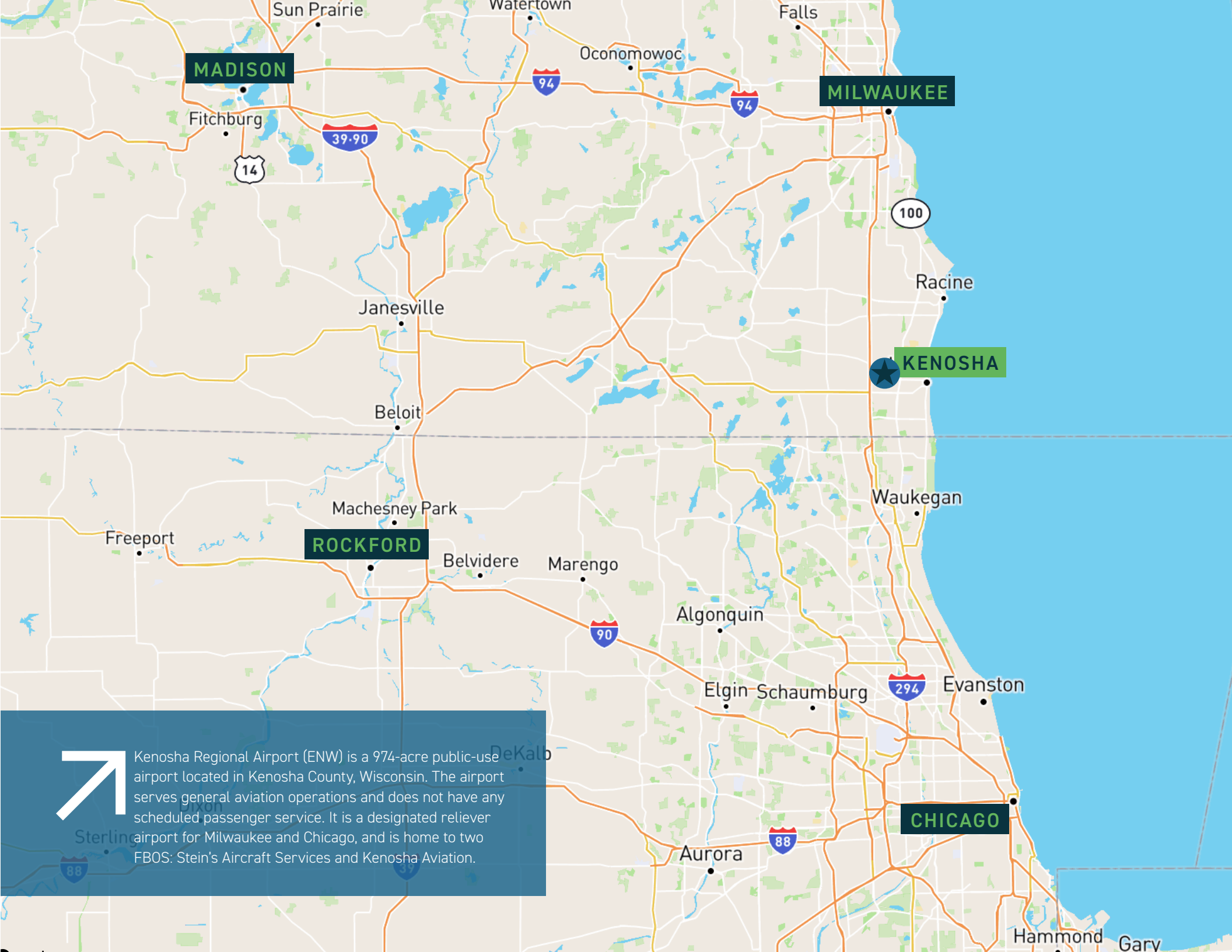
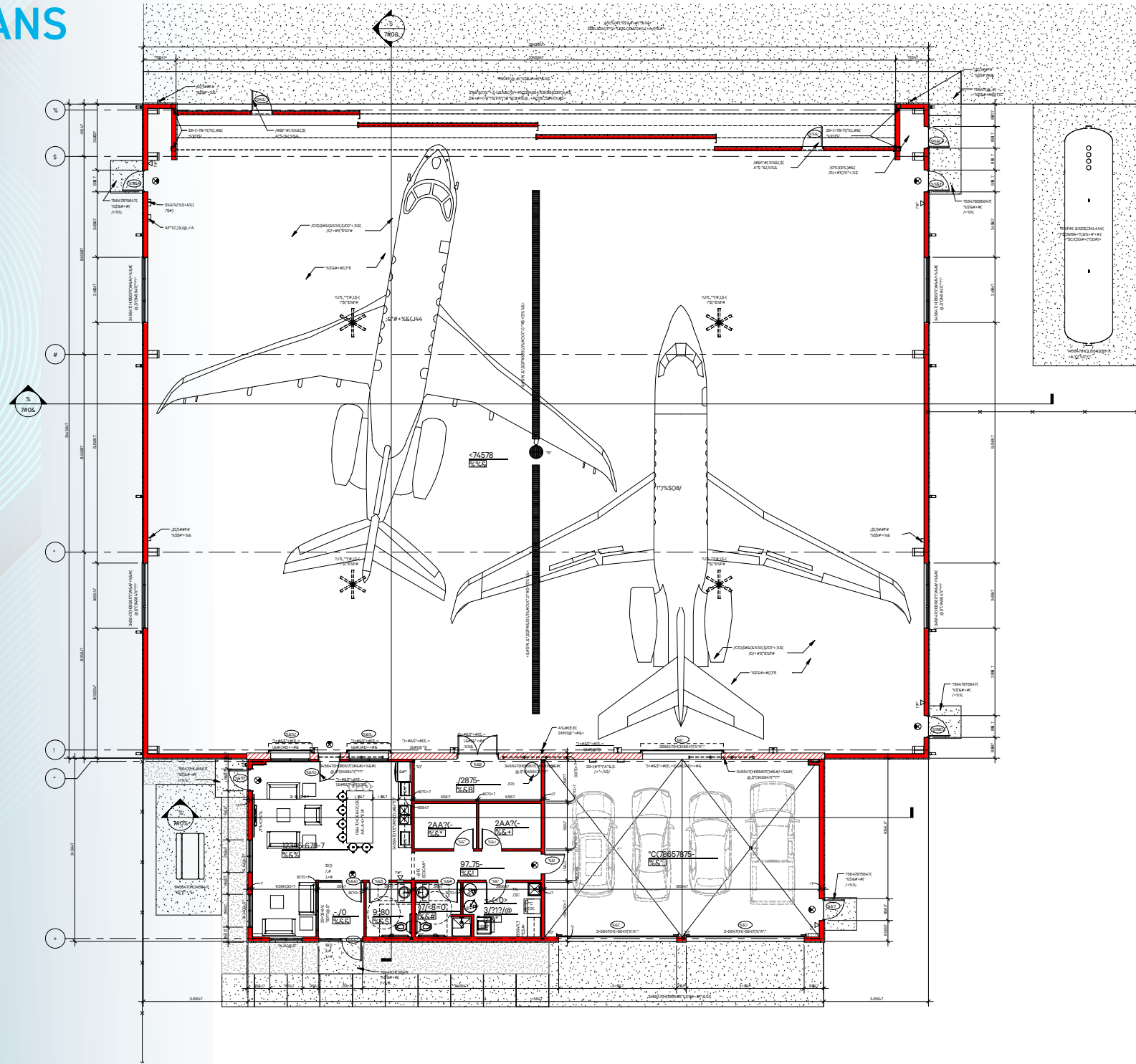

 Kenosha Regional Airport (ENW) is a 974-acre public-use airport located in Kenosha County, Wisconsin. The airport serves general aviation operations and does not have any scheduled passenger service. It is a designated reliever airport for Milwaukee and Chicago, and is home to two FBOs: Stein's Aircraft Services and Kenosha Aviation.



KENOSHA REGIONAL
AIRPORT HANGAR

4123 91ST AVENUE, KENOSHA, WISCONSIN



CONTACTS

KATRIN M. GIST

Senior Vice President
National Lead, CBRE Airport Properties
+1 206 947 1399
katrin.gist@cbre.com

JONATHAN S. SPRINGER

Vice Chairman
+1 312 935 1410
jon.springer@cbre.com

WHIT R. HEITMAN

Senior Vice President
+1 630 368 8631
whit.heitman@cbre.com

© 2024 CBRE, Inc. All rights reserved. This information has been obtained from sources believed reliable but has not been verified for accuracy or completeness. You should conduct a careful, independent investigation of the property and verify all information. Any reliance on this information is solely at your own risk. CBRE and the CBRE logo are service marks of CBRE, Inc. All other marks displayed on this document are the property of their respective owners, and the use of such logos does not imply any affiliation with or endorsement of CBRE. Photos herein are the property of their respective owners. Use of these images without the express written consent of the owner is prohibited. CPMK Kenosha Regional Airport_BRO_Gist_v02_EP 07/10/24

CBRE