

**PRICE REDUCTION**

**FOR SALE - ~~\$4,750,000~~ \$4,200,000**  
**CREATIVE ARTIST INDUSTRIAL COMPOUND**



**3401**  
**E 26TH ST**

VERNON CA 90058

**JOHN HILLMAN**

First Vice President

+1 213 435 5455

Lic. #01223571

[john.hillman@cbre.com](mailto:john.hillman@cbre.com)

**JASON MARTINEZ**

Associate

+1 323 804 5668

Lic. #02199658

[jason.martinez@cbre.com](mailto:jason.martinez@cbre.com)

**CBRE**

# THE OFFERING

CBRE, Inc., as exclusive advisor, is pleased to present the exceptional opportunity to acquire 3461 E 26th St in Vernon, CA—a highly improved 3-building compound totaling 16,642 SF, situated on a spacious 38,184 SF lot. Strategically located in the heart of Vernon, this property benefits from its proximity to major freeways (I-10, I-5, I-110, I-710), the Ports of Los Angeles and Long Beach, and its accessibility to Los Angeles International Airport.

The compound is currently configured as a versatile artistic and manufacturing facility, showcasing its adaptability to various industrial uses. It features a dedicated metal fabrication area, a fully-equipped woodworking shop with airlines, and a permitted spray booth for professional finishing applications. This unique setup offers potential owners remarkable flexibility, allowing the property to be occupied entirely by a single user or partially leased to generate additional income.

The property's versatile configuration, blending craftsmanship areas with industrial-grade facilities, positions it perfectly for businesses seeking to establish or expand their operations in one of Southern California's prominent industrial markets.



## PROPERTY HIGHLIGHTS

 **16,642 SF**  
Across Three Structures

 **10**  
Drive-In Doors

 Permitted AQMD  
Spray Booth

 **38,184 SF**  
of Land

 **HVAC**  
In Place for Multiple Units

 Close Proximity to Major  
Freeways at East LA  
Interchange

 **12'-14'**  
Clear Height

 Existing Metal Fabrication  
and Wood Working Shops  
with Active Air Lines

 Fully Fenced and Secured  
Yard Area

# PROPERTY PHOTOS - EXTERIOR



# PROPERTY PHOTOS - INTERIOR



# AERIAL



# SITE PLAN

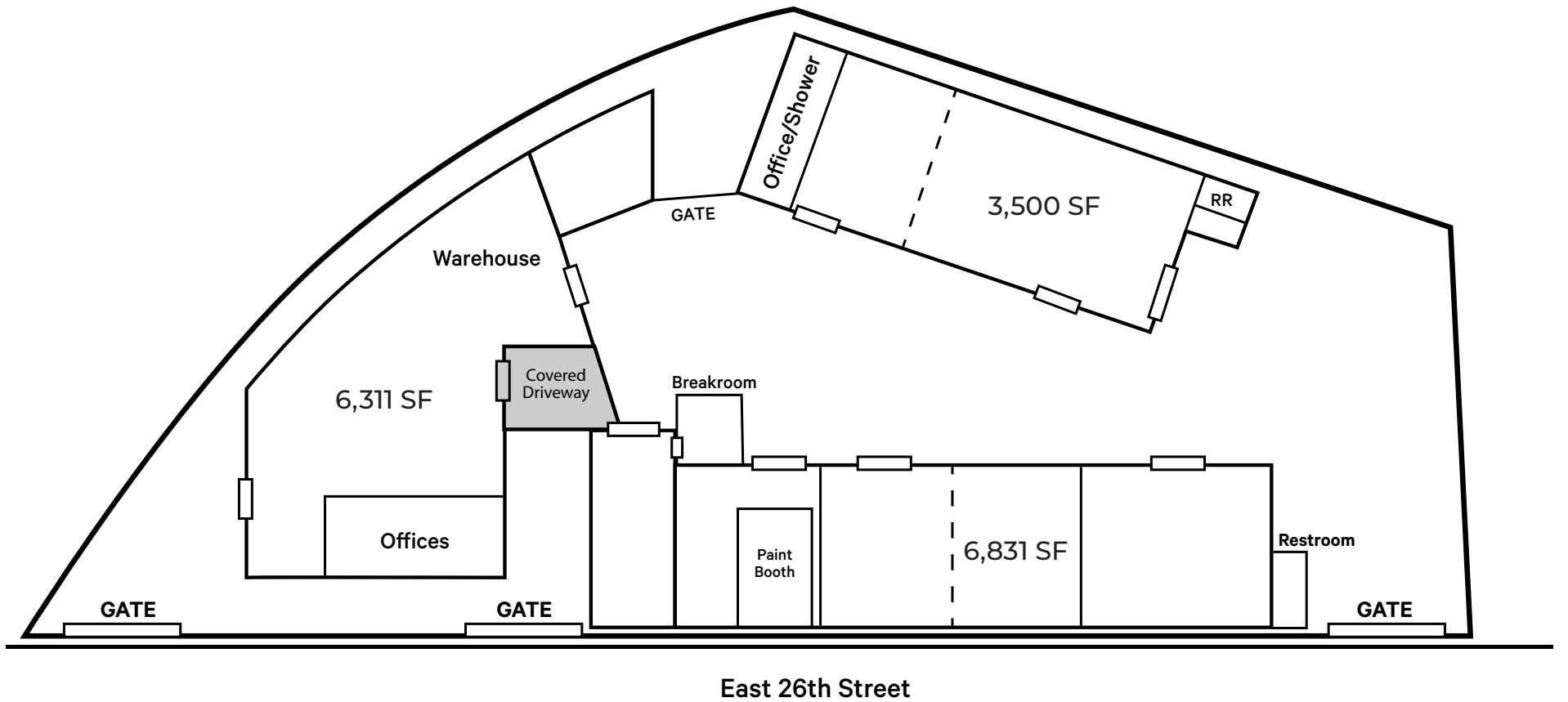

# CENTRAL LOCATION AERIAL

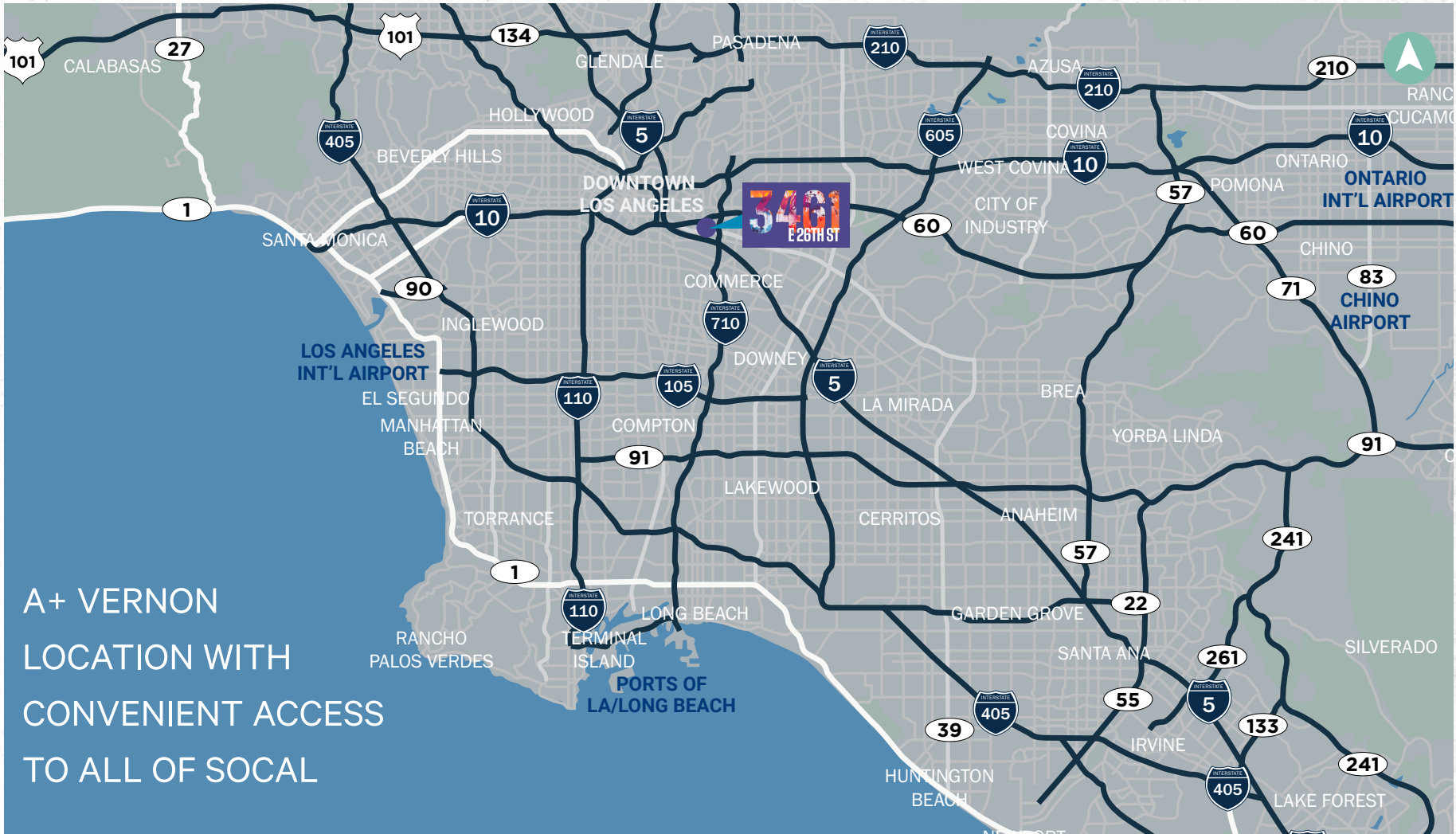

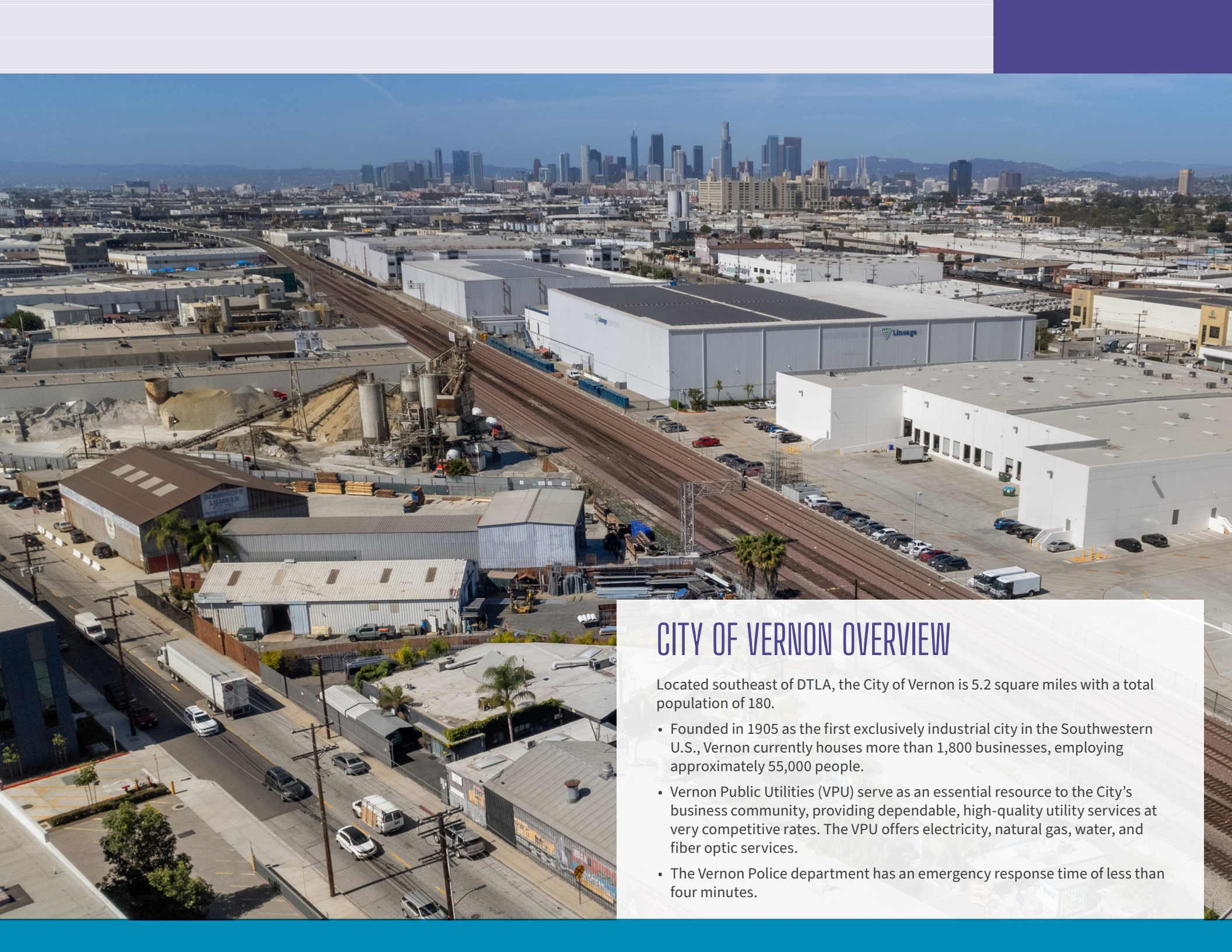

## CITY OF VERNON OVERVIEW

Located southeast of DTLA, the City of Vernon is 5.2 square miles with a total population of 180.

- Founded in 1905 as the first exclusively industrial city in the Southwestern U.S., Vernon currently houses more than 1,800 businesses, employing approximately 55,000 people.
- Vernon Public Utilities (VPU) serve as an essential resource to the City's business community, providing dependable, high-quality utility services at very competitive rates. The VPU offers electricity, natural gas, water, and fiber optic services.
- The Vernon Police department has an emergency response time of less than four minutes.



3401  
E 26TH ST  
VERNON CA 90058

### JOHN HILLMAN

First Vice President  
+1 213 435 5455  
Lic. #01223571  
john.hillman@cbre.com

### JASON MARTINEZ

Associate  
+1 323 804 5668  
Lic. #02199658  
jason.martinez@cbre.com

© 2026 CBRE, Inc. All rights reserved. This information has been obtained from sources believed reliable but has not been verified for accuracy or completeness. You should conduct a careful, independent investigation of the property and verify all information. Any reliance on this information is solely at your own risk. CBRE and the CBRE logo are service marks of CBRE, Inc. All other marks displayed on this document are the property of their respective owners, and the use of such logos does not imply any affiliation with or endorsement of CBRE. Photos herein are the property of their respective owners. Use of these images without the express written consent of the owner is prohibited. CPM 3461 E 26th St\_BRO\_v03 01/28/26

CBRE